

PROFILE
Scale H=1:250 V=1:10

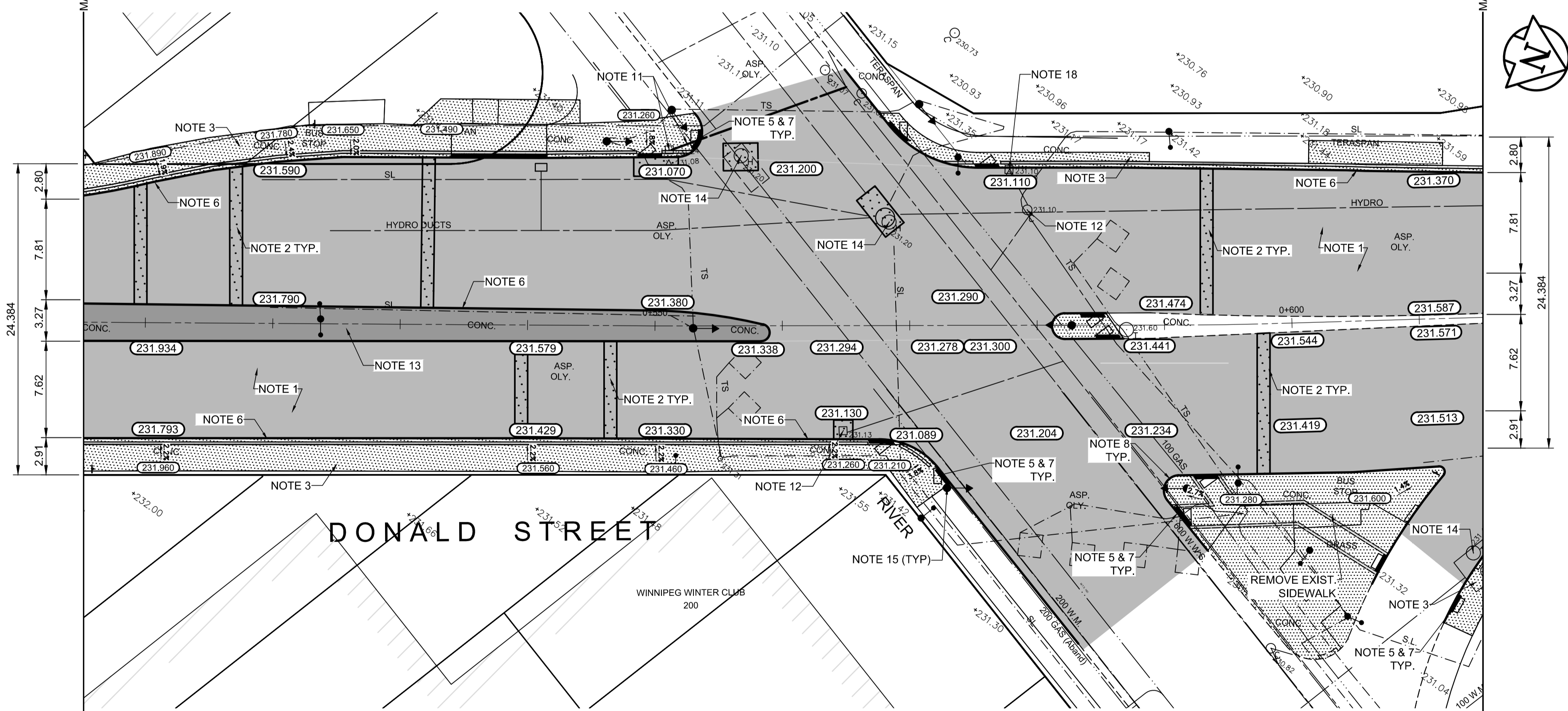

PLAN
Scale 1:250

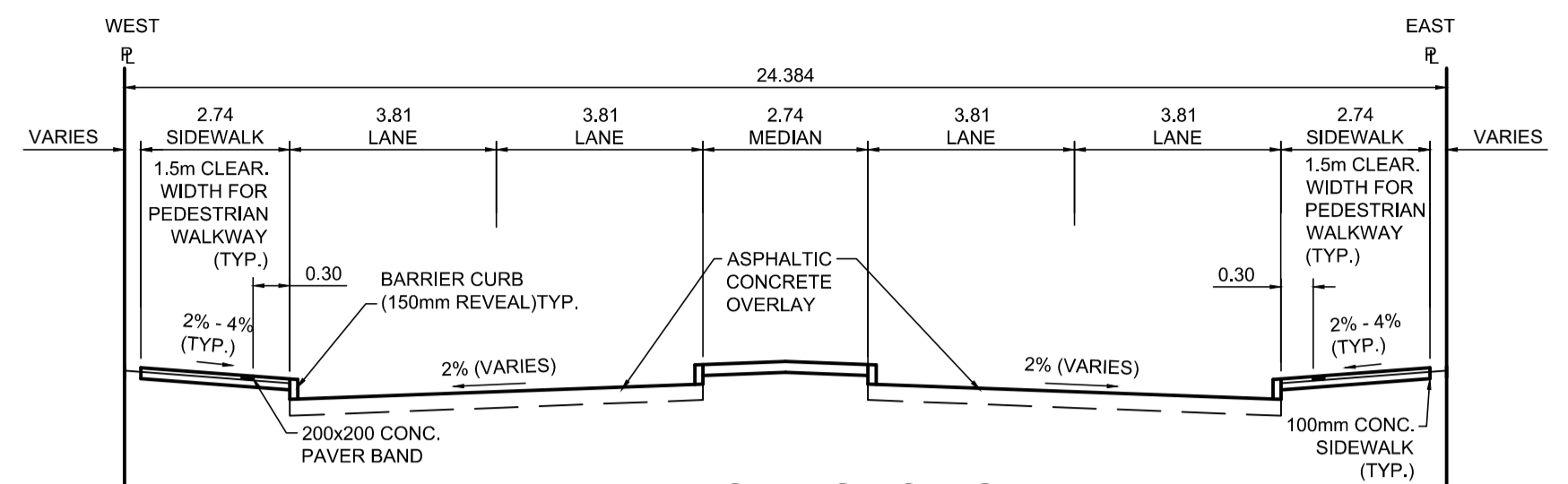

TYPICAL SECTION
Scale NTS

ITEM	RIM ELEV.	Sta	INVERT					CONNECTION	LEAD	FLOW RESTRICTOR
			EAST	WEST	NORTH	SOUTH	V. RISER			
CB07	231.070W	0+551	230.070				229.780	223.61±	1800 SRS	14.0 m-2500 @ 2% Min
CB08	231.130E	0+565		230.070			230.050	223.61±	1800 SRS	1.0 m-2500 @ 2% Min
CB09	231.110W	0+578								

REFERENCE NOTES

- A. PAVEMENT DIMENSIONS ARE TO BACK OF CURB
- B. BASELINE IS CENTRELINE OF RIGHT-OF-WAY
- C. PROPERTY LINES OBTAINED FROM THE CITY OF WINNIPEG L.B.I.S., AND SCALE FACTOR WAS NOT APPLIED
- D. REFER TO AECOM FIELD BOOK NO. 5062 - 5069, 5072
- E. CATCH BASIN CONNECTIONS TO SEWER DESIGNED TO MAINTAIN PRE-CONSTRUCTION CAPACITY BY CATCH BASIN LEAD RESTRICTION AS INDICATED ON THE DRAWINGS. ADDITIONAL OR MODIFIED CONNECTIONS TO THE SEWER SYSTEM BEYOND THOSE INDICATED ON THE DRAWINGS REQUIRE REVIEW AND WRITTEN APPROVAL BY THE CONTRACT ADMINISTRATOR.

CONSTRUCTION NOTES

1. PLANE EXISTING ASPHALT AND CONSTRUCT NEW ASPHALTIC PAVEMENT OVERLAY TYPE 1A (AVERAGE THICKNESS 85mm)
2. REMOVE EXISTING PAVEMENT AND CONSTRUCT NEW 230mm PLAIN DOWELLED CONCRETE PAVEMENT
3. REMOVE EXISTING CONCRETE SIDEWALK AND CONSTRUCT NEW 100mm SIDEWALK WITH BLOCKOUTS OF PAVING STONES FOR INDICATOR SURFACE (SEE CT-30)
4. PLACE ASPHALT PAVEMENT (TYPE 1A)
5. INSTALL NEW DETECTABLE SURFACE WARNING TILES
6. CONSTRUCT NEW BARRIER CURB (150mm REVEAL HT. SEPARATE)
7. CONSTRUCT NEW MONOLITHIC CURB RAMP (10mm HT. INTEGRAL)
8. CONSTRUCT NEW MODIFIED BARRIER CURB (180mm HT. INTEGRAL) AS PER SD-203B AT ALL STREET/LANE INTERSECTION RADII
9. ADJUST EXISTING CATCHBASIN / MANHOLE FRAME AND COVER
10. ADJUST EXISTING WATERMAIN VALVE BOX TO GRADE
11. REMOVE AND REPLACE EXISTING CATCHBASIN (SD-024) AND REPLACE EXISTING LEAD 15m OF 250mm SEWER SERVICE AND CONNECT TO EXISTING SEWER
12. REMOVE AND REPLACE EXISTING CATCH BASIN/MANHOLE FRAME AND COVER
13. REMOVE AND REPLACE EXISTING CATCHPIT OF CURB AND GUTTER INLET (SD-025) AND CONNECT TO EXISTING LEAD
14. ADJUST UTILITY MANHOLE FRAME REINFORCE ISOLATION WITH 15M BARS FOR ISOLATIONS IN ROADWAY AND 10M BARS FOR ISOLATIONS IN SIDEWALK
15. EXISTING TRAFFIC SIGNALS POLES TO BE RELOCATED (REFER TO SIGNALS DRAWINGS FOR ADDITIONAL DETAILS)
16. PLACE RAKED ASPHALT IN CENTER MEDIAN
17. CONTRACT ADMINISTRATOR TO DETERMINE LOCATIONS FOR INSTALLATION OF PAVEMENT REPAIR FABRIC PRIOR TO ASPHALT PAVING
18. REMOVE AND REPLACE EXISTING CATCHPIT AND DRAINAGE CONNECTION PIPE, CONNECT TO EXISTING CATCHBASIN

**ENGINEERS
GEOSCIENTISTS
MANITOBA**
Certificate of Authorization
AECOM Canada Ltd.
No. 4671 Date: _____

METRIC
WHOLE NUMBERS INDICATE MILLIMETRES
DECIMALIZED NUMBERS INDICATE METRES

EXISTING	LEGEND - PLAN	PROPOSED	EXISTING	LEGEND - PLAN	PROPOSED	EXISTING	LEGEND - PROFILE	PROPOSED
150 mm W.M.	WATERMAIN	150 mm W.M.	HYDRO	M.T.S.	— x —	—	PROFILE	—
300mm L.D.S.	HYDRANT	300mm L.D.S.	CONCRETE	CONCRETE	—	—	WEST GUTTER	—
250mm W.W.S.	VALVE	250mm W.W.S.	ASPHALT	ASPHALT	—	—	EAST GUTTER	—
	LAND DRAINAGE SEWER		PROPERTY LINE	PROPERTY LINE	—	—	N/W PROPERTY LINE	—
	WASTEWATER SEWER		SURVEY BAR	SURVEY BAR	—	—	S/E PROPERTY LINE	—
	MANHOLE		ELEVATION	ELEVATION	35.750			
	CATCH BASIN		TREE	TREE				
	CATCH PIT		SIDEWALK RAMP	SIDEWALK RAMP				
	TRAFFIC SIGNAL POLE		CONCRETE SIDEWALK	CONCRETE SIDEWALK				
	STREET LIGHT		FENCE	FENCE				
	GAS							

LOCATION APPROVED UNDERGROUND STRUCTURES
SUPV. U/G STRUCTURES DATE
NOTE: LOCATION OF UNDERGROUND STRUCTURES AS SHOWN ARE BASED ON THE BEST INFORMATION AVAILABLE, BUT NO GUARANTEE IS GIVEN THAT ALL EXISTING UTILITIES ARE SHOWN OR THAT THE GIVEN LOCATIONS ARE EXACT. CONFIRMATION OF EXISTENCE AND EXACT LOCATION OF ALL SERVICES MUST BE OBTAINED FROM THE INDIVIDUAL UTILITIES BEFORE PROCEEDING WITH CONSTRUCTION.

NO.	REVISIONS	DATE	BY
0	ISSUED FOR TENDER	2020/10/30	TLF
A	ISSUED FOR REVIEW	2020/10/23	TLF

DESIGNED BY	BC	CHECKED BY	TLF
DRAWN BY	JT	APPROVED BY	TLF
HOR. SCALE:	AS SHOWN	RELEASED FOR CONSTRUCTION BY:	
VERTICAL:			
DATE	2020/05/06	DATE	

ENGINEER'S SEAL
PROVINCE OF MANITOBA
T.L. FINDLAY
Member 23820
REGISTERED PROFESSIONAL ENGINEER

THE CITY OF WINNIPEG
PUBLIC WORKS DEPARTMENT
ENGINEERING DIVISION
DOWNTOWN PAVEMENT RENEWAL PROJECT
2021 CONSTRUCTION
PLAN/PROFILE GRADING PLAN
DONALD STREET
STATION 0+505 TO STATION 0+615
CITY DRAWING NUMBER P-3535-19
SHEET 19 OF 30