

ITEM	RIM ELEV.	Sta	INVERT				CONNECTION	LEAD	FLOW RESTRICTOR	
			EAST	WEST	NORTH	SOUTH				
CB01	231.710E	0+425	230.110			229.780	223.61±	1800 CS	14.0 m-2500 @ 2% Min	n/a
CB02	231.710W	0+425		230.110		230.050	223.61±	1800 CS	1.0 m-2500 @ 2% Min	n/a

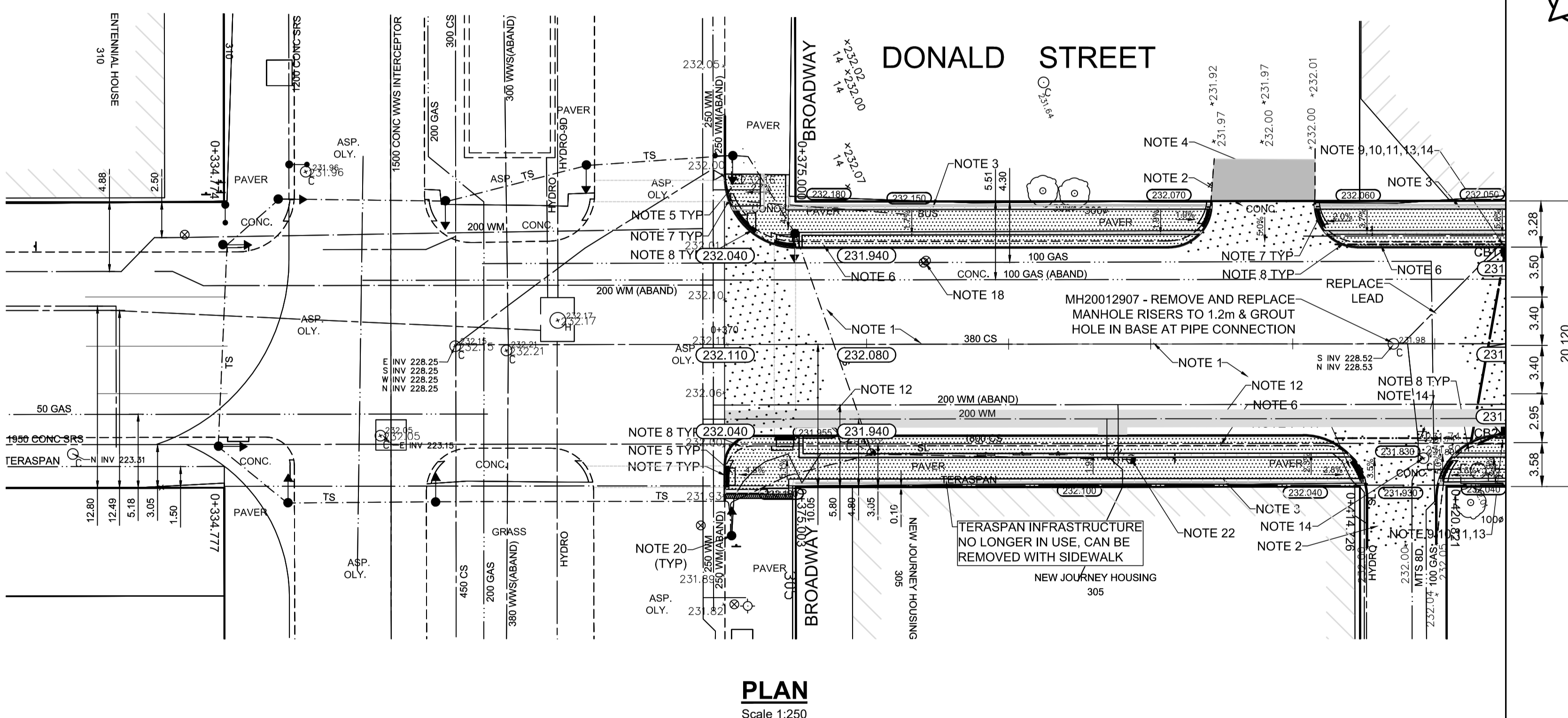

REFERENCE NOTES

- A. PAVEMENT DIMENSIONS ARE TO BACK OF CURB
- B. BASELINE IS CENTRELINE OF RIGHT-OF-WAY
- C. PROPERTY LINES OBTAINED FROM THE CITY OF WINNIPEG L.B.I.S., AND SCALE FACTOR WAS NOT APPLIED
- D. REFER TO AECOM FIELD BOOK NO. 5062-5069, 5072
- E. CATCH BASIN CONNECTIONS TO SEWER DESIGNED TO MAINTAIN PRE-CONSTRUCTION CAPACITY BY CATCH BASIN LEAD RESTRICTION AS INDICATED ON THE DRAWINGS. ADDITIONAL OR MODIFIED CONNECTIONS TO THE SEWER SYSTEM BEYOND THOSE INDICATED ON THE DRAWINGS REQUIRE REVIEW AND WRITTEN APPROVAL BY THE CONTRACT ADMINISTRATOR.

CONSTRUCTION NOTES

1. REMOVE EXISTING PAVEMENT AND CONSTRUCT NEW 230mm PLAIN DOWELLED CONCRETE PAVEMENT
2. CONSTRUCT NEW 200mm REINFORCED CONCRETE PAVEMENT
3. REMOVE EXISTING CONCRETE SIDEWALK AND CONSTRUCT NEW 100mm SIDEWALK WITH BLOCKOUTS c/w PAVING STONES FOR INDICATOR SURFACE (REFER TO TYPICAL SECTION ON THIS SHEET AND CT-30 DETAILS FOR ADDITIONAL INFORMATION). CONTRACTOR TO SAW CUT AT PROPERTY LINE FULL LENGTH OF PROJECT
4. PLACE ASPHALT PAVEMENT (TYPE 1A)
5. INSTALL NEW DETECTABLE SURFACE WARNING TILES
6. CONSTRUCT NEW BARRIER CURB (180mm HT. SEPARATE)
7. CONSTRUCT NEW MONOLITHIC CURB RAMP (10mm HT. INTEGRAL)
8. CONSTRUCT NEW MODIFIED BARRIER CURB (180mm HT. INTEGRAL) AS PER SD-203B AT ALL STREET/LANE INTERSECTION RADII
9. INSTALL NEW CURB AND GUTTER INLET c/w CATCHBASIN (SD024) CONNECT NEW 250mm LEAD TO EXISTING 1800 STORM RELIEF SEWER
10. INSTALL FLOW RESTRICTOR PIPE AS INDICATED IN CB & CP TABLE (SD-122)
11. INSULATE WATERMAIN AND/OR WATER SERVICE UNDER CATCHPIT OR CATCHBASIN
12. INSULATE WATER MAIN AND WATER SERVICES UNDER ROADWAY EXCAVATION AS PER (SD-18)
13. INSTALL 150mm SUBDRAIN 12m ON EACH SIDE OF CATCHBASIN UNLESS OTHERWISE NOTED
14. REMOVE EXISTING CURB INLET / CATCH PIT / CATCHBASIN AND ABANDON EXISTING LEAD
15. REMOVE EXISTING FRAME AND COVER AND INSTALL NEW FRAME AND SOLID COVER (AP-006 & AP-007)
16. INSTALL NEW 50mm CAST IRON RISER RING
17. ADJUST EXISTING CATCHBASIN / MANHOLE FRAME AND COVER
18. ADJUST EXISTING WATERMAIN VALVE BOX TO GRADE
19. NEW STREET LIGHTING TO BE INSTALLED, EXISTING STREET LIGHTING TO BE REMOVED
20. EXISTING TRAFFIC SIGNALS POLE TO BE RELOCATED (REFER TO SIGNALS DRAWINGS FOR ADDITIONAL DETAILS)
21. TERASPAN INFRASTRUCTURE NO LONGER IN USE, REMOVE DURING PAVEMENT OR SIDEWALK REMOVAL
22. RED LIGHT CAMERA TO BE REMOVED AND REINSTALLED BY OTHERS

**ENGINEERS
GEOSCIENTISTS
MANITOBA**
Certificate of Authorization
AECOM Canada Ltd.
No. 4671 Date: _____

METRIC
WHOLE NUMBERS INDICATE MILLIMETRES
DECIMALIZED NUMBERS INDICATE METRES

EXISTING	LEGEND - PLAN	PROPOSED	EXISTING	LEGEND - PLAN	PROPOSED	EXISTING	LEGEND - PROFILE	PROPOSED
150 mm W.M.	WATERMAIN	150 mm W.M.	HYDRO	M.T.S.	— x —	— x —	PROFILE	— x —
300mm L.D.S.	HYDRANT	300mm L.D.S.	CONCRETE	CONCRETE	—	—	WEST GUTTER	—
250mm W.W.S.	VALVE	250mm W.W.S.	ASPHALT	ASPHALT	—	—	EAST GUTTER	—
	LAND DRAINAGE SEWER		PROPERTY LINE	PROPERTY LINE	—	—	N/W PROPERTY LINE	—
	WASTEWATER SEWER		SURVEY BAR	SURVEY BAR	—	—	S/E PROPERTY LINE	—
	MANHOLE		ELEVATION	ELEVATION	(35.750)			
	CATCH BASIN		TREE	TREE				
	CATCH PIT		SIDEWALK RAMP	SIDEWALK RAMP				
	TRAFFIC SIGNAL POLE		CONCRETE SIDEWALK	CONCRETE SIDEWALK				
	STREET LIGHT		FENCE	FENCE				
	GAS							

LOCATION APPROVED UNDERGROUND STRUCTURES
SUPV. U/G STRUCTURES COMMITTEE DATE _____
NOTE:
LOCATION OF UNDERGROUND STRUCTURES AS SHOWN ARE BASED ON THE BEST INFORMATION AVAILABLE, BUT NO GUARANTEE IS GIVEN THAT ALL EXISTING UTILITIES ARE SHOWN OR THAT THE GIVEN LOCATIONS ARE EXACT. CONFIRMATION OF EXISTENCE AND EXACT LOCATION OF ALL SERVICES MUST BE OBTAINED FROM THE INDIVIDUAL UTILITIES BEFORE PROCEEDING WITH CONSTRUCTION.

NO.	REVISIONS	DATE	BY
0	ISSUED FOR TENDER	2020/10/30	TLF
A	ISSUED FOR REVIEW	2020/10/23	TLF

B.M. tbn	South East Corner of Smith Avenue & Broadway, property line, top of 1" x 1" iron bar	ELEV. 231.968	
DESIGNED BY	BC	CHECKED BY	TLF
DRAWN BY	JT	APPROVED BY	TLF
HOR. SCALE:	AS SHOWN	RELEASED FOR CONSTRUCTION BY:	
VERTICAL:		DATE	2020/06/15

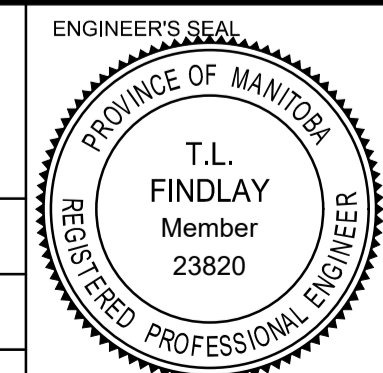

THE CITY OF WINNIPEG
PUBLIC WORKS DEPARTMENT
ENGINEERING DIVISION

DOWNTOWN PAVEMENT RENEWAL PROJECT
2021 CONSTRUCTION

PLAN/PROFILE GRADING PLAN
DONALD STREET
BROADWAY TO STA. 0+425

CITY DRAWING NUMBER P-3535-24
SHEET 24 OF 30

CONSULTANT DRAWING NO. CT-24