

SEWER SERVICE INFORMATION (ID #9345) *

DISTANCE FROM 3RD MH S. OF NOTRE DAME AV. (MH ID #9346)	
6.2 N	SERVICE CONNECTION W
6.8 N	SERVICE CONNECTION E
48.0 N	SERVICE CONNECTION W
54.3 N	SERVICE CONNECTION E
64.3 N	SERVICE CONNECTION E
89.0 N	SERVICE CONNECTION E
92.3 N	SERVICE CONNECTION E
92.3 N	SERVICE CONNECTION W

* - INFORMATION FROM SEWER VIDEO INSPECTION

NOTE: CHAINAGE ALONG WEST PROPERTY LINE WALL STREET, RICHARD AV.

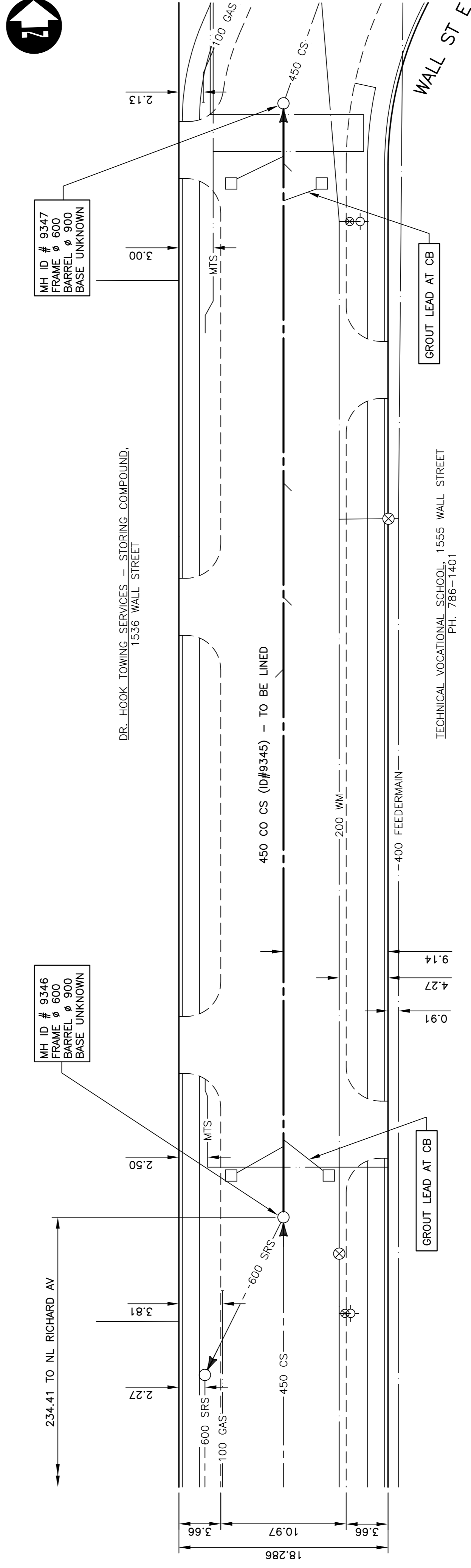

WARNING

IF POWER EQUIPMENT OR EXPLOSIVES ARE TO BE USED FOR EXCAVATION ON THIS PROJECT THE CONTRACTOR MUST:

1. NOTIFY THE GAS COMPANY OF THE PROPOSED LOCATION OF EXCAVATION.
2. TAKE PRECAUTION TO AVOID DAMAGE TO GAS COMPANY INSTALLATIONS SEE PROVINCIAL REGULATION 210/72 FOR DETAILS

METRIC

WHOLE NUMBERS INDICATE MILLIMETRES
DECIMALIZED NUMBERS INDICATE METRES

<p>THE CITY OF WINNIPEG WATER AND WASTE DEPARTMENT</p>		<p>2004 COMBINED SEWER RENEWALS BY CIPP LINING, CONTRACT 9 WALL STREET 3RD MH SOUTH OF NOTRE DAME AV TO 2ND MH SOUTH OF NOTRE DAME AV</p>		<p>CITY DRAWING NUMBER 05401 SHEET 3 OF 15</p>		<p>BID OPPORTUNITY No. 238-2004</p>	
				<p>CONSULTANT DRAWING NO. 043031-03</p>			
				<p>RELEASED FOR CONSTRUCTION (SIGNED BY) KAS ZUREK DATE: MAY 26, 2004</p>			
DESIGNED BY		J.K.M.		B.M. ELEV.			
DRAWN BY		S.C.C.		UNDERGROUND STRUCTURES			
CHECKED BY		P.M.K.		SUPPLY U/G STRUCTURES		DATE	
APPROVED BY				COMMITTEE			
				NOTE: UNLESS OTHERWISE SPECIFIED, ALL DIMENSIONS ARE TO FACE UNLESS NOTED OTHERWISE. NO DIMENSIONS SHALL BE SHOWN FOR EXISTING UTILITIES AND EXACT LOCATION OF EXISTENCE AND EXACT DEPTH OF EXISTENCE SHALL BE OBTAINED FROM THE INDIVIDUAL UTILITIES BEFORE PROCEEDING WITH CONSTRUCTION.			
				2 ISSUED FOR TENDER		09/28/04 P.M.K.	
				1 SUBMITTED TO WAW FOR REVIEW		05/10/04 P.M.K.	
				NO. REVISIONS			
				DATE		APRIL 2004	
				HOR. SCALE		1:250	
				VERTICAL		1:50	
				DATE		APRIL 2004	
				LEGEND-PROFILE		PROPOSED	
				LEGEND-PLAN		EXISTING	
				LEGEND-PLAN		EXISTING	
				LEGEND-PLAN		PROPOSED	