

EXISTING	LEGEND-PLAN	PROPOSED	LEGEND-PLAN	PROPOSED	EXISTING	LEGEND-PLAN	PROPOSED	LEGEND-PLAN	PROPOSED	EXISTING	LEGEND-PROFILE	PROPOSED	LEGEND-PROFILE
	WATERMAIN		HYDRO WATERMAIN			HYDRO WATERMAIN		HYDRO WATERMAIN			HYDRO WATERMAIN		HYDRO WATERMAIN
	LAND DRAINAGE SEWER		CONCRETE			ASPHALT		PROPERTY LINE			SURVEY BAR		DITCH
	WASTE WATER SEWER		SIDEWALK			NORTH OR WEST GUTTER		NORTH OR EAST GUTTER			NORTH OR WEST RISER		NORTH OR EAST DITCH
	MANHOLE		MANHOLE			MANHOLE		MANHOLE			MANHOLE		MANHOLE
	CATCH BASIN		CATCH BASIN			CATCH BASIN		CATCH BASIN			CATCH BASIN		CATCH BASIN
	CURB INLET		CURB INLET			CURB INLET		CURB INLET			CURB INLET		CURB INLET
	JUNCTIONS		JUNCTIONS			JUNCTIONS		JUNCTIONS			JUNCTIONS		JUNCTIONS
	CULVERT		CULVERT			CULVERT		CULVERT			CULVERT		CULVERT
	GAS		GAS			GAS		GAS			GAS		GAS

WARNING

IF POWER EQUIPMENT OR EXPLOSIVES ARE TO BE USED FOR EXCAVATION ON THIS PROJECT THE CONTRACTOR MUST NOTIFY THE GAS COMPANY OR THE PROPOSED LOCATION OF EXCAVATION.

2) TIME PRECAUTION TO AVOID DAMAGE TO GAS COMPANY INSTALLATIONS. REGULATION 140/92 FOR DETAILS SEE PROPOSAL.

METRIC

WHOLE NUMBERS INDICATE MILLIMETRES
DECIMALIZED NUMBERS INDICATE METRES

LOCATION APPROVED UNDERGROUND STRUCTURES

SUPV. U/G STRUCTURES DATE

B.M.	ELEV.
1	ADRIENNEUM #1

NOTE: LOCATION OF UNDERGROUND STRUCTURES AS SHOWN ON THIS DRAWING IS THE BEST AVAILABLE INFORMATION THAT ALL EXISTING UTILITIES ARE SHOWN OR OPERATING. THE LOCATION OF ALL SERVICES MUST BE VERIFIED BY THE CONTRACTOR PRIOR TO CONSTRUCTION.

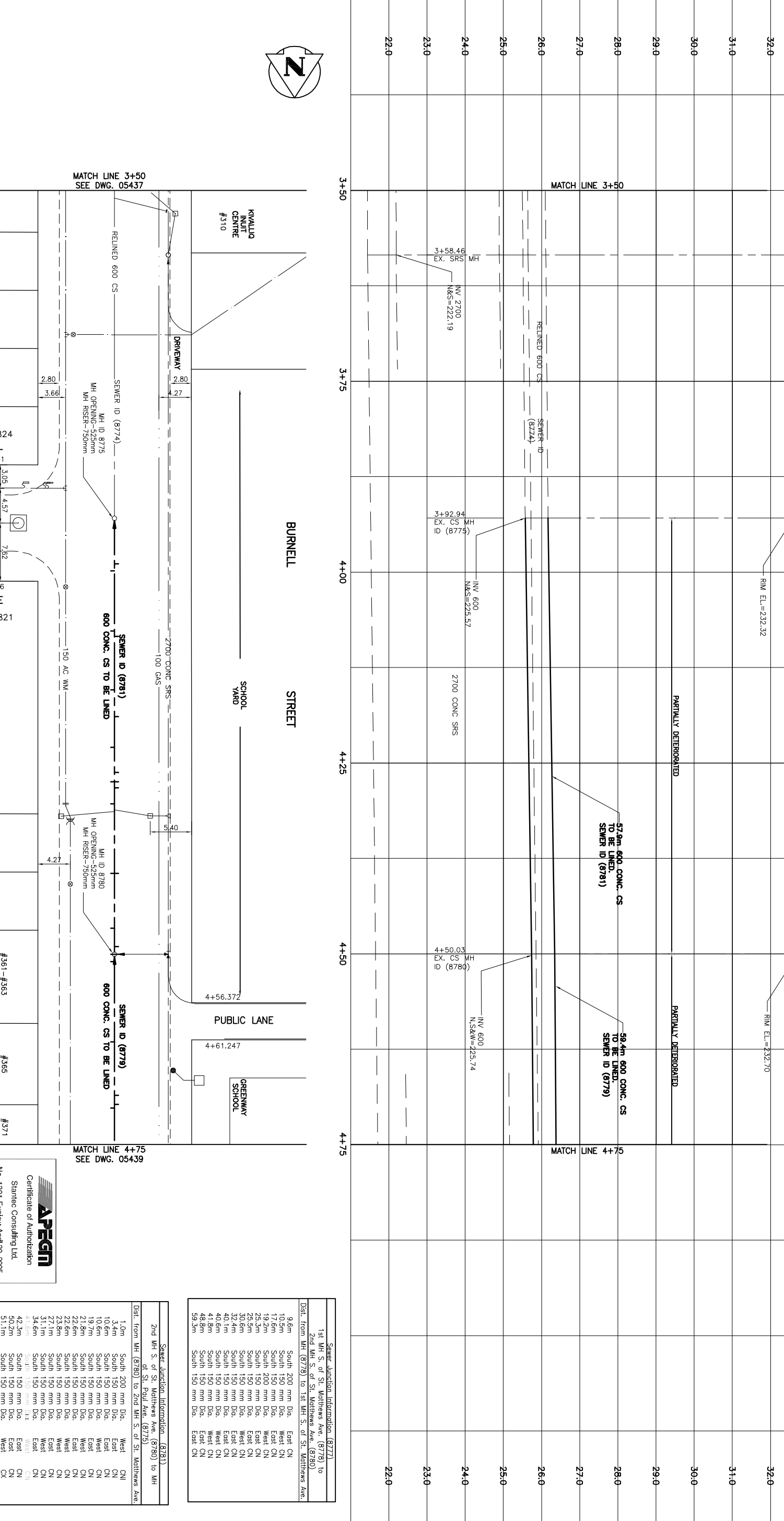

STATION	DESCRIPTION	ELEVATION
22+0	600 CONC. CS TO BE LINED	232.0
23+0	600 CONC. CS TO BE LINED	232.0
24+0	600 CONC. CS TO BE LINED	232.0
25+0	600 CONC. CS TO BE LINED	232.0
26+0	600 CONC. CS TO BE LINED	232.0
27+0	600 CONC. CS TO BE LINED	232.0
28+0	600 CONC. CS TO BE LINED	232.0
29+0	600 CONC. CS TO BE LINED	232.0
30+0	600 CONC. CS TO BE LINED	232.0
31+0	600 CONC. CS TO BE LINED	232.0
32+0	600 CONC. CS TO BE LINED	232.0



BURNELL STREET

AVENUE #821

AVENUE #822

AVENUE #824

GREENWAY SCHOOL

SCHOOL YARD

TOWNHOUSES #822

APARTMENT BLDG.

DUPLICATE #363

HOUSE #365

#371

KINALLA KINARE CENTRE #310

MATCH LINE 3+50
SEE DWG. 05437

MATCH LINE 4+75
SEE DWG. 05439

SEWER SERVICE INFORMATION

ADDRESS	SIZE	PROPERTY LINE LOCATION
#361/#363 DUPLEX	NO INFO AVAILABLE	4.0m N of S lot line
#365 HOUSE	NO INFO AVAILABLE	NO INFO AVAILABLE
#371 BURNELL STREET	NO INFO AVAILABLE	NO INFO AVAILABLE

Sewer Junction Information (8778)		
1st MH S. of St. Matthews Ave. (8778) to 2nd MH S. of St. Matthews Ave. (8780)	2nd MH S. of St. Matthews Ave. (8780) to 1st MH S. of St. Matthews Ave. (8778)	1st MH S. of St. Matthews Ave. (8778) to 2nd MH S. of St. Matthews Ave. (8780)
9.6m South 200 mm Dia. East CN	10.5m South 150 mm Dia. West CN	17.6m South 150 mm Dia. East CN
17.6m South 150 mm Dia. West CN	19.2m South 200 mm Dia. West CN	25.3m South 150 mm Dia. East CN
25.3m South 150 mm Dia. East CN	30.6m South 150 mm Dia. West CN	32.4m South 150 mm Dia. East CN
32.4m South 150 mm Dia. East CN	40.8m South 150 mm Dia. West CN	41.8m South 150 mm Dia. West CN
40.8m South 150 mm Dia. West CN	48.8m South 150 mm Dia. East CN	59.3m South 150 mm Dia. East CN

Stantec Consulting Ltd.
905 Waverley Street, Winnipeg, Manitoba
Tel: 204-489-5800 Fax: 204-453-9012

APEN
Certificate of Authorization
No. 1301 Expiry: April 30, 2005

THE CITY OF WINNIPEG
WATER AND WASTE DEPARTMENT
ENGINEERING DIVISION

BURNELL STREET
2ND MH S ST MATTHEWS AV TO MH AT ST PAUL AV
STA. 3+92.94 TO STA. 4+50.03
2004 SEWER RENEWAL BY CIPP LINING

SHEET 5 OF 7
CAD FILE DRAWING NUMBER 2004 Burnell.dwg
CITY DRAWING NUMBER 05438