

CONSTRUCTION NOTES:

- SEWER TO BE RENEWED OFF-LINE BY TRENCHLESS METHODS.
- CONFIRM THE LOCATION OF ALL SEWER SERVICES.
- RENEW SEWER SERVICES TO R.
- BACKFILL UNDER PAVEMENT, IN SIDEWALKS, & WITHIN 1.0 m OF PAVEMENT TO BE CLASS 3.
- BACKFILL IN BOULEVARD TO BE CLASS 5.
- SEWER SERVICE RISERS TO BE INSTALLED WHEN COMBINED SEWER EXCEEDS 4.25 m IN DEPTH.
- INSTALL TEE INCLUDING RISERS & PLUG FOR FUTURE SERVICE CONNECTION OF EXISTING WYED SEWER SERVICES AS SHOWN ON DRAWINGS OR AS DIRECTED BY THE CONTRACT ADMINISTRATOR.
- CATCHBASIN LEADS TO BE INSTALLED AT MINIMUM 1.0% SLOPE OR AS DIRECTED BY THE CONTRACT ADMINISTRATOR

NOTE: CHAINAGES SHOWN ARE ALONG N. R. OF WOODROW PL.

WOODROW PLACE

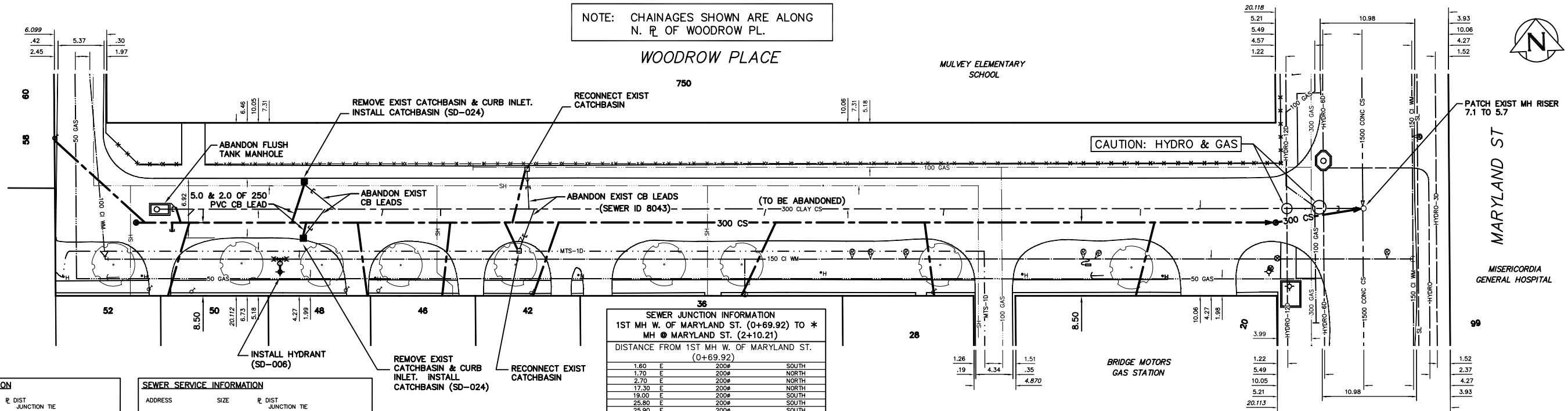

SEWER JUNCTION INFORMATION
1ST MH W. OF MARYLAND ST. (0+69.92) TO * MH @ MARYLAND ST. (2+10.21)
DISTANCE FROM 1ST MH W. OF MARYLAND ST. (0+69.92)

ELEVATION	DATE	DIRECTION
1.60	2004	SOUTH
1.70	2004	NORTH
2.70	2004	NORTH
17.30	2004	NORTH
19.00	2004	SOUTH
25.80	2004	SOUTH
25.90	2004	SOUTH
42.90	2004	NORTH
43.50	2004	SOUTH
44.10	2004	SOUTH
46.10	2004	NORTH
62.60	2004	SOUTH
69.70	2004	SOUTH
78.60	2004	SOUTH
91.00	2004	SOUTH
93.80	2004	NORTH
95.30	2004	NORTH
114.40	2004	SOUTH
130.10	2004	SOUTH
133.40	2004	SOUTH

SEWER SERVICE INFORMATION

ADDRESS	SIZE	R DIST	JUNCTION TIE
20 MARYLAND ST		16.15 W OF EL	
RESIDENTIAL		25.91 W MH @ MARYLAND	
750 WOLSELEY AVE		96.60 W OF EL	
RESIDENTIAL		6.10 E 1ST MH E WOLSELEY	
99 CORNISH AVE		16.15 S OF NL	
RESIDENTIAL		54.86 N MH @ WOODROW	
28 WOODROW PL		1.22 W OF JCT	
RESIDENTIAL		43.77 W MH @ MARYLAND	
36 WOODROW PL		18.0 E OF WL	
RESIDENTIAL		69.49 W MH @ MARYLAND	
42 WOODROW PL		77.11 W MH @ MARYLAND	
RESIDENTIAL			

SEWER SERVICE INFORMATION

ADDRESS	SIZE	R DIST	JUNCTION TIE
46 WOODROW PL		107.29 W MH @ MARYLAND	
RESIDENTIAL		48 WOODROW PL	2.13 W OF JCT (WYE)
RESIDENTIAL		114.0 W MH @ MARYLAND	
50 WOODROW PL			
RESIDENTIAL		NO INFORMATION AVAILABLE	
52 WOODROW PL			
RESIDENTIAL		135.94 W MH @ MARYLAND	
58 WOODROW PL			
RESIDENTIAL		137.92 W MH @ MARYLAND	
60 WOODROW PL			
RESIDENTIAL		NO INFORMATION AVAILABLE	

200 WM	WATERMAIN	200 WM	SL, HYDRO	150 WM	WATERMAIN	150 WM
+	HYDRANT	+	MTS	+	HYDRANT	+
o	VALVE	o	TRAFFIC SIGNALS	o	VALVE	o
525 LDS	LAND DRAINAGE SEWER	525 LDS	GAS	50 GAS	300 LDS	LAND DRAINAGE SEWER
375 WWS	WASTEWATER SEWER	375 WWS	SURVEY BAR	250 WWS	WASTEWATER SEWER	250 WWS
o	MANHOLE	o	FENCE	x	o	PROFILE
o	CATCH BASIN	o	POLE - HYDRO, MTS	o	o	GROUND ABOVE PIPE
v	CURB INLET	v	CURB STOP	o	o	DITCH (SOUTH & EAST)
o	JUNCTIONS	o	GUY ANCHOR	o	o	GUTTER (NORTH & WEST)
o	CULVERT	o	LIGHT STANDARD	o	o	
o	ANODE	o	TREE	o	o	
o	EXISTING	o	LEGEND-PLAN	o	o	LEGEND-PROFILE
o	PROPOSED	o	PROPOSED	o	o	PROPOSED

LOCATION APPROVED UNDERGROUND STRUCTURES

SUPV. U/G STRUCTURES COMMITTEE	DATE

NOTE: LOCATION OF UNDERGROUND STRUCTURES AS SHOWN ARE BASED ON THE BEST INFORMATION AVAILABLE BUT NO GUARANTEE IS GIVEN THAT ALL EXISTING UTILITIES ARE SHOWN OR THAT THE GIVEN LOCATIONS ARE EXACT. CONFIRMATION OF EXISTENCE AND EXACT LOCATION OF ALL SERVICES MUST BE OBTAINED FROM THE INDIVIDUAL UTILITIES BEFORE PROCEEDING WITH CONSTRUCTION.

CITY OF WINNIPEG WATER AND WASTE ENGINEERING DIVISION

DESIGNED BY: SC
CHECKED BY: TW

DRAWN BY: CJH
APPROVED BY: KZ

HOR. SCALE: 1:250
VERTICAL: 1:50

RELEASED FOR CONSTRUCTION: 2004.08.11

ENGINEER'S SEAL

ORIGINAL SIGNED BY K.R. ZUREK 04/08/11

BID OPPORTUNITY: 405-2004
FILENAME: full_woodrow.dwg
PLOT DATE: 2004 08 13

THE CITY OF WINNIPEG WATER AND WASTE DEPARTMENT

2004 COMBINED SEWER RENEWALS AND ASSOCIATED WORKS

WOODROW PLACE

MH AT MARYLAND STREET TO 1ST MH W OF MARYLAND STREET

SHEET 8 OF 9
CITY DRAWING NUMBER 05519

WARNING

IF POWER EQUIPMENT OR EXPLOSIVES ARE TO BE USED FOR EXCAVATION ON THIS PROJECT THE CONTRACTOR MUST:

- NOTIFY THE GAS COMPANY OF THE PROPOSED LOCATION OF EXCAVATION.
- TAKE PRECAUTION TO AVOID DAMAGE TO GAS COMPANY INSTALLATIONS.

SEE PROVINCIAL REGULATION 210/72 FOR DETAILS

