

- NOTES:**
- OZONE DIFFUSERS AND OZONE GAS PIPING UP TO 0.5m FROM THE CONTACTOR WALL AND 0.5m ABOVE THE TOP OF THE DIFFUSER GRID IN CELL #1 OF BOTH CONTACTORS SHALL BE SUPPLIED BY THE SUPPLY CONTRACTOR AND INSTALLED BY THE CONTRACTOR.
 - VALVES HV-0210A TO HV-0210H AND HV-0230A TO HV-0230H ARE ON VERTICAL OF SAMPLE LINES FROM CONTACTOR CELLS.
 - ALL GATES ARE SUPPLIED BY OTHERS. INSTALLATION BY THE CONTRACTOR.

COTACTORS
1:100

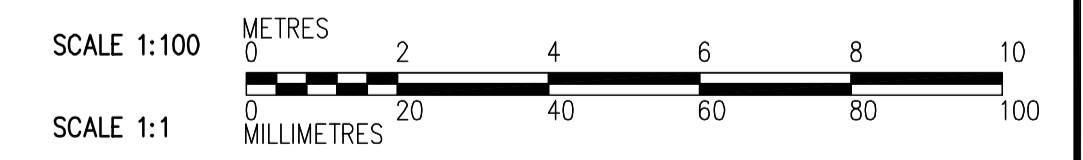
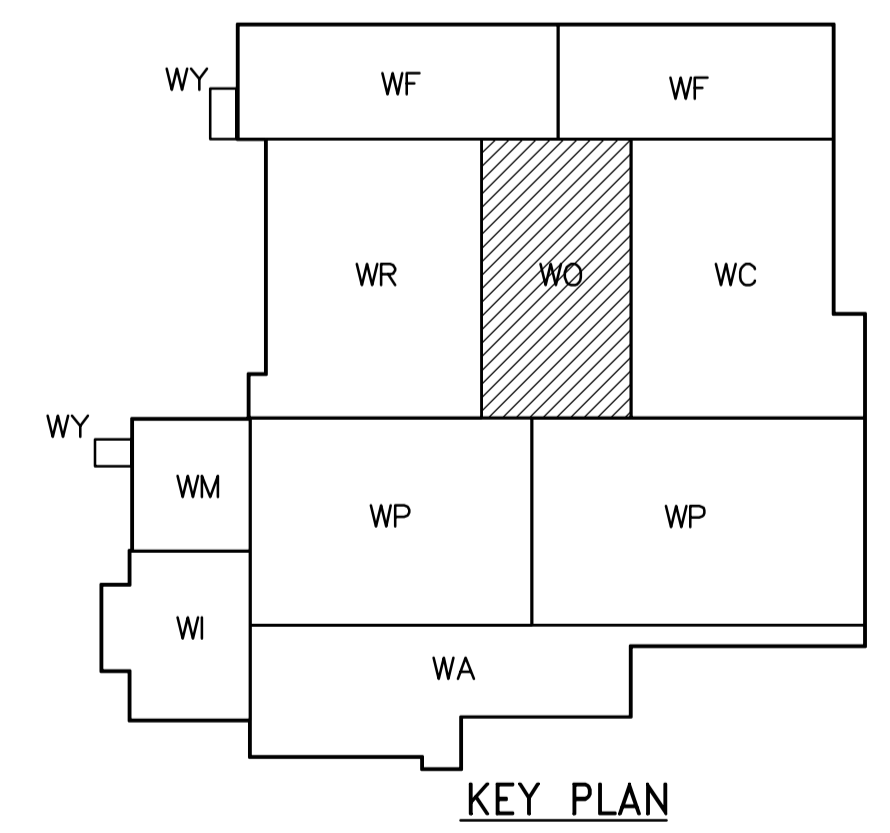

APECA
Certificate of Authorization
CH2M HILL Canada Ltd.
No. 1441 Expiry: April 30, 2007

NO.	REVISIONS	DATE	BY
01	742-2005 ADDENDUM 2	06/04/28	CBE
00	ISSUED FOR TENDER	06/03/29	CBE

CH2MHILL Frederickson Cooper ARCHITECTS		EarthTech A Tyco International Ltd. Company	
DESIGNED BY	CBE/DP	CHECKED BY	EPM
DRAWN BY	RWA/KM	APPROVED BY	AHL
SCALE:	1:100	RELEASED FOR CONSTRUCTION BY:	R. SOROKOWSKI
DATE	2006/02/14	DATE	2006/03/29

ENGINEER'S SEAL
ORIGINAL
SIGNED BY
D.J. PERNITSKY
2006/03/29
CONSULTANT DRAWING NO.
WO-M0121

THE CITY OF WINNIPEG
WATER AND WASTE DEPARTMENT
ENGINEERING DIVISION

WATER TREATMENT PLANT
OZONE
MECHANICAL AND ELECTRICAL

PROCESS MECHANICAL
OZONATION AREA
CONTACTORS

CITY FILE NUMBER
SHEET OF
CITY DRAWING NUMBER
1-06010-A-M0121-001-01D