

- NOTES:**
1. ALL 120V AND 208V LOADS ARE FED FROM LP-A11.
  2. EMERGENCY LIGHTING EM-X-1, -2 ETC ARE FED FROM BATTERY PACK EM-X.
  3. MOUNT TYPE A AND U LUMINAIRES AT 3m ABOVE FINISHED FLOOR.

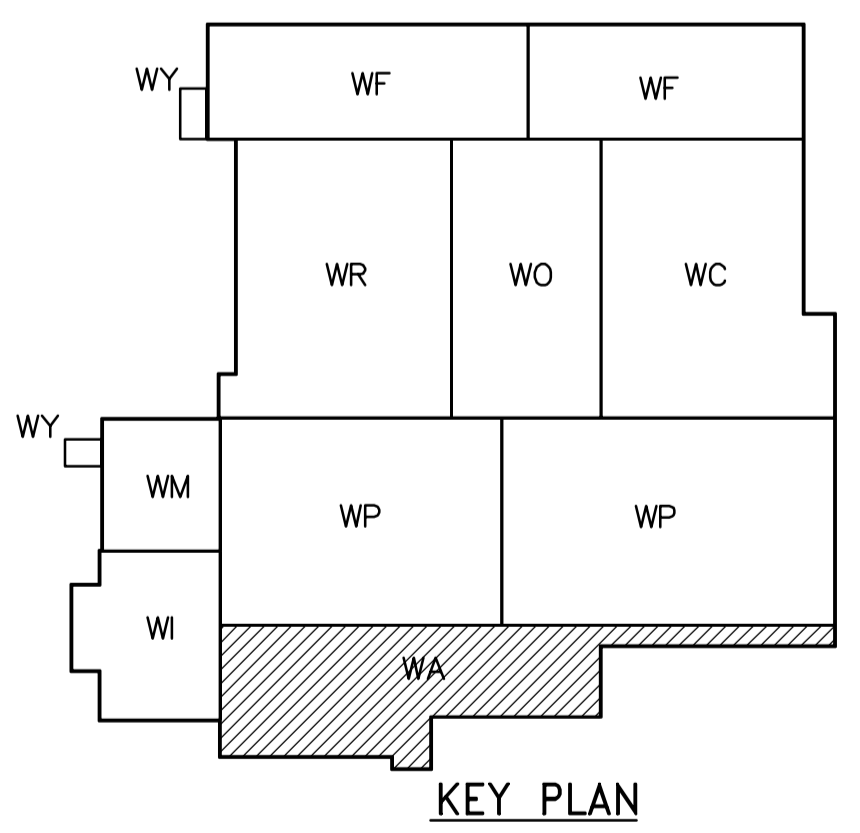

**FIRST FLOOR POWER AND LIGHTING PLAN**  
1:100

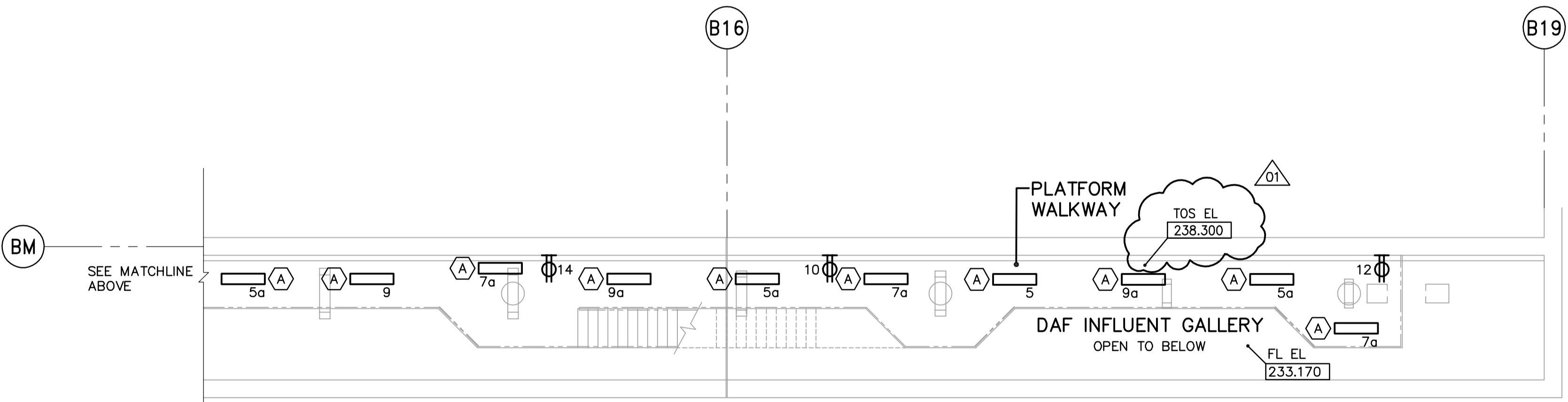

<p><b>APEGN</b> Certificate of Authorization CH2M HILL Canada Ltd. No. 1441 Expiry: April 30, 2007</p>	<p>Frederickson Cooper ARCHITECTS</p>		<p>EarthTech A Tyco International Ltd. Company</p>		ENGINEER'S SEAL  ORIGINAL SIGNED BY L.D. LLEWELLYN 2006/03/29	<p><b>THE CITY OF WINNIPEG</b> WATER AND WASTE DEPARTMENT ENGINEERING DIVISION</p>	
	DESIGNED BY JT CHECKED BY ND		APPROVED BY AHL		CONSULTANT DRAWING NO. WA-E0113		
	DRAWN BY KJ		RELEASED FOR CONSTRUCTION BY: R. SOROKOWSKI				
	SCALE: 1:100		DATE 2005/08/18		CITY FILE NUMBER SHEET OF CITY DRAWING NUMBER 1-0601A-A-E0113-001-01D		
B.M. ELEV.		NO. REVISIONS		DATE BY		ELECTRICAL ADMINISTRATION AREA FIRST FLOOR POWER AND LIGHTING PLAN	