

- NOTES:**
1. ALL 120V AND 208V LOADS ARE FED FROM LP-C11.
  2. EMERGENCY LIGHTING EM-X-1, -2 ETC ARE FED FROM BATTERY PACK EM-X.

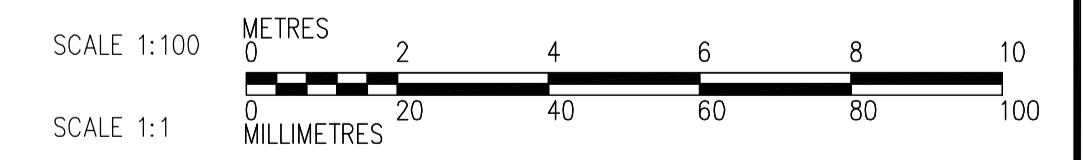
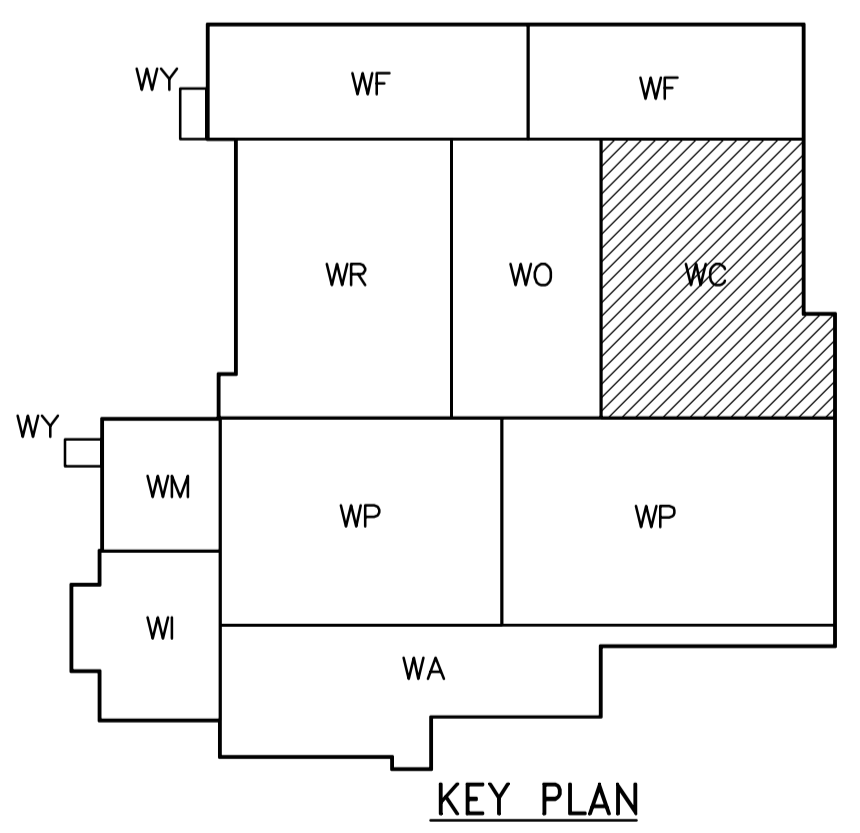

**FIRST FLOOR POWER AND LIGHTING PLAN**  
1:100

**APECA**  
Certificate of Authorization  
CH2M HILL Canada Ltd.  
No. 1441 Expiry: April 30, 2007

NO.	REVISIONS	DATE	BY
01	742-2005 ADDENDUM 3	06/05/05	LL
00	ISSUED FOR TENDER	06/03/29	LL

<b>CH2MHILL</b> Frederickson Cooper ARCHITECTS		<b>EarthTech</b> A Tyco International Ltd. Company	
DESIGNED BY	KJ	CHECKED BY	ND
DRAWN BY	JT	APPROVED BY	AHL
SCALE:	1:100	RELEASED FOR CONSTRUCTION BY:	R. SOROKOWSKI
DATE	2005/07/08	DATE	2006/03/29

ENGINEER'S SEAL  
ORIGINAL SIGNED BY  
L.D. LLEWELLYN  
2006/03/29  
CONSULTANT DRAWING NO.  
WC-E0113

**THE CITY OF WINNIPEG**  
WATER AND WASTE DEPARTMENT  
ENGINEERING DIVISION

WATER TREATMENT PLANT  
CHEMICAL FEED SYSTEMS  
MECHANICAL AND ELECTRICAL

ELECTRICAL  
CHEMICAL AREA  
FIRST FLOOR POWER AND LIGHTING PLAN

CITY FILE NUMBER  
SHEET OF  
CITY DRAWING NUMBER  
1-0601C-A-E0113-001-01D