

- NOTES:**
- SEE MCC #1A & #1B SINGLE LINE DIAGRAM AND DP-F01, DP-F02, DP-F03 AND DP-F04 POWER DISTRIBUTION FOR 600V POWER DISTRIBUTION.
 - ALL 120 AND 208V LOADS ARE FED FROM LP-F01.
 - SEE DWG WB-E0404 FOR POWER FEEDS TO VALVES
 - SEE DWG WB-E0404 AND WB-E0405 FOR POWER WIRING TO BACKWASH PUMPS
 - SEE SWGR 1A & 1B SINGLE LINE DIAGRAM FOR 600V POWER DISTRIBUTION TO BACKWASH PUMPS

LOWER LEVEL PROCESS PLAN (AREA 2)

1:100

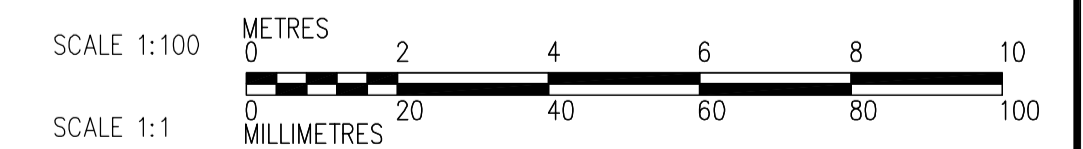
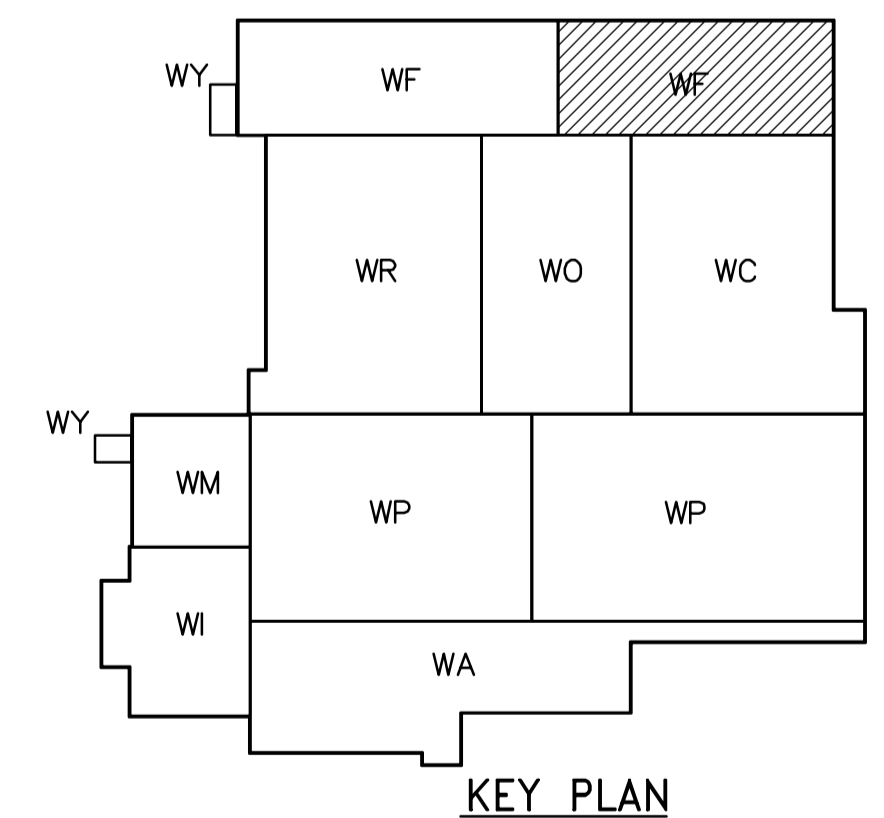

<p>Certificate of Authorization CH2M HILL Canada Ltd. No. 1441 Expiry: April 30, 2007</p>	<p>Frederickson Cooper ARCHITECTS</p>		<p>A You International Ltd. Company</p>		ENGINEER'S SEAL ORIGINAL SIGNED BY L.D. LLEWELLYN 2006/03/29	<p>THE CITY OF WINNIPEG WATER AND WASTE DEPARTMENT ENGINEERING DIVISION</p> <p>WATER TREATMENT PLANT FILTRATION MECHANICAL AND ELECTRICAL</p> <p>ELECTRICAL FILTRATION AREA 2 LOWER LEVEL PROCESS PLAN</p>	CITY FILE NUMBER SHEET OF
	DESIGNED BY JT CHECKED BY ND		APPROVED BY AHL		CONSULTANT DRAWING NO. WF-E0104		CITY DRAWING NUMBER 1-0601F-A-E0104-001-01D
	DRAWN BY KJ SCALE: 1:100		RELEASED FOR CONSTRUCTION BY: R. SOROKOWSKI				
	NO. REVISIONS 01 742-2005 ADDENDUM 3 06/05/05 LL 00 ISSUED FOR TENDER 06/03/29 LL		DATE BY 2005/07/13		DATE 2006/03/29		