

- NOTES**
1. ALL 120V AND 208V LOADS ARE FED FROM LP-H31.
  2. EMERGENCY LIGHTING EM-X-1,-2 ARE FED FROM BATTERY PACK EM-X.
  3. SEE DRAWING WB-E0401 FOR MOUNTING DETAILS FOR TYPE "A" FIXTURES.

**THIRD FLOOR POWER AND LIGHTING PLAN**  
1:100

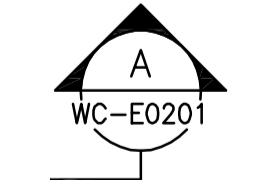
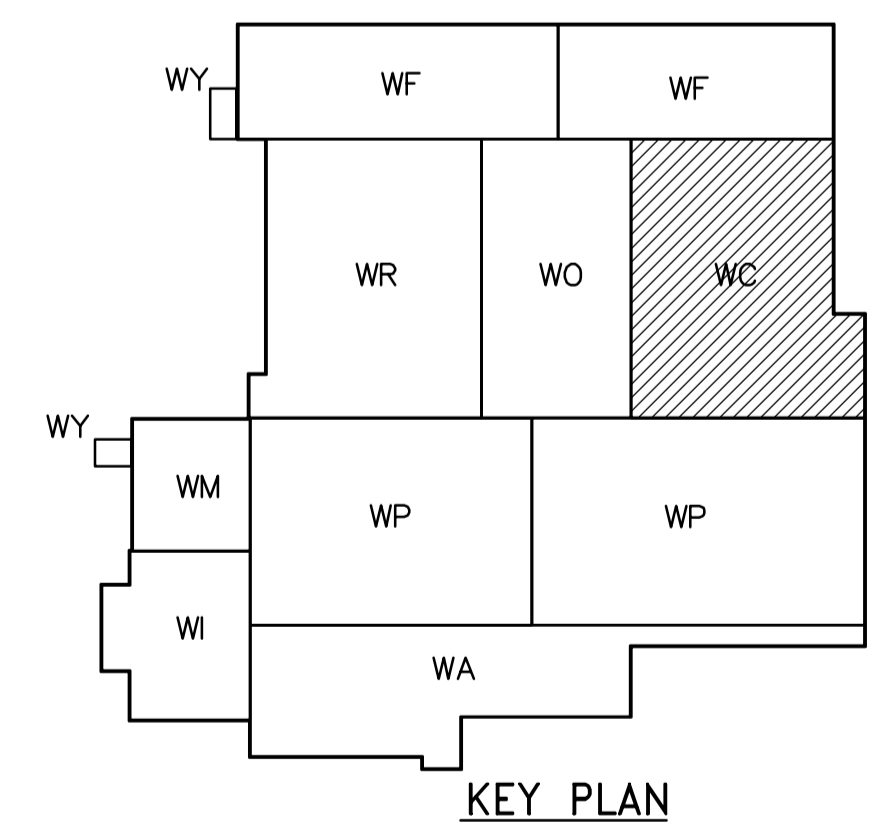

<p><b>APEGM</b> Certificate of Authorization CH2M HILL Canada Ltd. No. 1441 Expiry: April 30, 2007</p>	B.M. ELEV.	<p>Frederickson Cooper ARCHITECTS</p>	<p>EarthTech A You International Ltd. Company</p>	ENGINEER'S SEAL	<p><b>THE CITY OF WINNIPEG</b> WATER AND WASTE DEPARTMENT ENGINEERING DIVISION</p>		
				DESIGNED BY LL		CHECKED BY ND	ORIGINAL SIGNED BY L.D. LLEWELLYN
				DRAWN BY TL		APPROVED BY AHL	2006/03/29
				SCALE: 1:100		RELEASED FOR CONSTRUCTION BY: R. SOROKOWSKI	CONSULTANT DRAWING NO. WC-E0133
	NO. REVISIONS	DATE BY	DATE 2006/02/12	DATE 2006/03/29	<p>WATER TREATMENT PLANT CHEMICAL FEED SYSTEM MECHANICAL AND ELECTRICAL</p> <p>ELECTRICAL CHEMICAL AREA THIRD FLOOR POWER AND LIGHTING PLAN</p>		
					<p>CITY FILE NUMBER</p> <p>SHEET OF</p> <p>CITY DRAWING NUMBER</p> <p>1-0601C-A-E0133-001-020</p>		