

- NOTES:**
1. ALL 120V AND 208V LOADS ARE FED FROM LP-M11.
  2. EMERGENCY LIGHTING EM-X-1, -2 ETC ARE FED FROM BATTERY PACK EM-X.

**FIRST FLOOR POWER AND LIGHTING PLAN**  
1:100

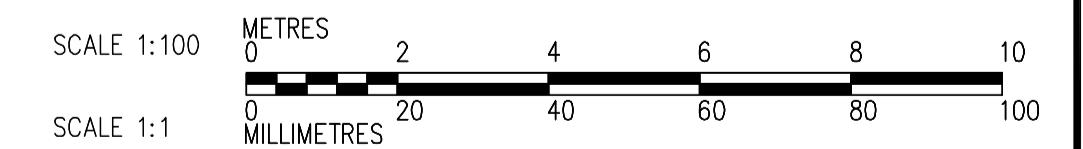
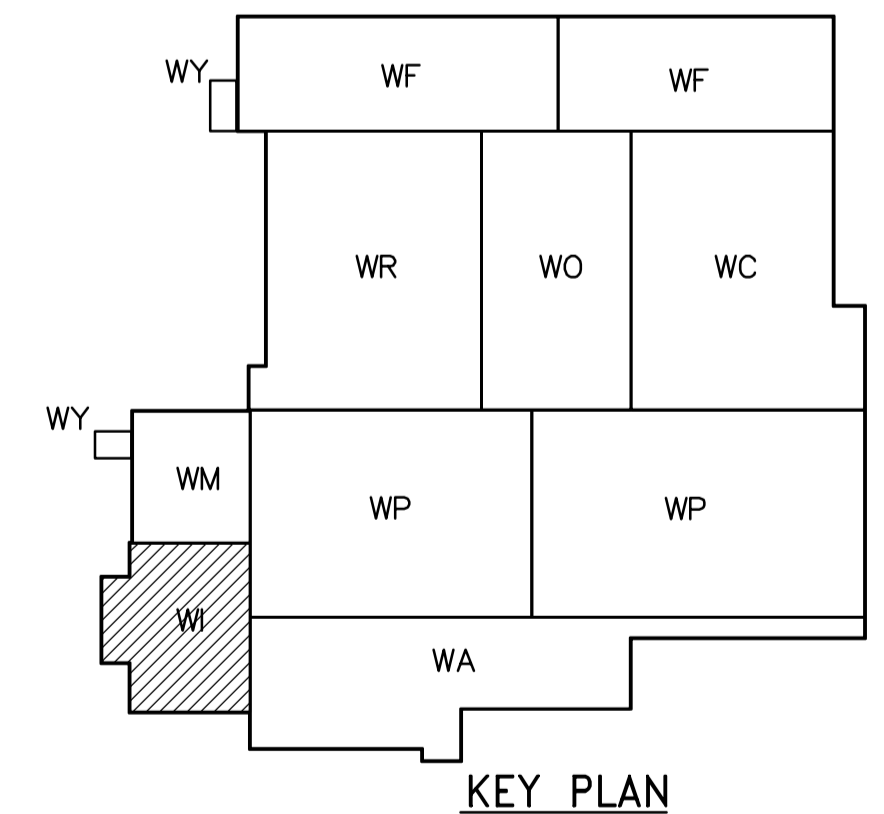

 <b>APECA</b> Certificate of Authorization CH2M HILL Canada Ltd. No. 1441 Expiry: April 30, 2007	B.M. ELEV.	 Frederickson Cooper ARCHITECTS	 A Terra International Ltd. Company	ENGINEER'S SEAL	 <b>THE CITY OF WINNIPEG</b> WATER AND WASTE DEPARTMENT ENGINEERING DIVISION	WATER TREATMENT PLANT INLET WORKS AND RAW WATER PUMPING MECHANICAL AND ELECTRICAL	CITY FILE NUMBER		
				DESIGNED BY <b>JT</b>			CHECKED BY <b>ND</b>	ORIGINAL SIGNED BY <b>L.D. LLEWELLYN</b>	SHEET OF
				DRAWN BY <b>KJ</b>			APPROVED BY <b>AHL</b>	2006/03/29	CITY DRAWING NUMBER
				SCALE: 1:100			RELEASED FOR CONSTRUCTION BY: <b>R. SOROKOWSKI</b>	CONSULTANT DRAWING NO. <b>WI-E0113</b>	1-06011-A-E0113-001-010
	NO. REVISIONS	DATE BY	DATE	DATE					