

- NOTES:**
1. ALL 120V AND 208V LOADS ARE FED FROM LP-P11.
  2. EMERGENCY LIGHTING EM-X-1, -2 ETC ARE FED FROM BATTERY PACK EM-X.

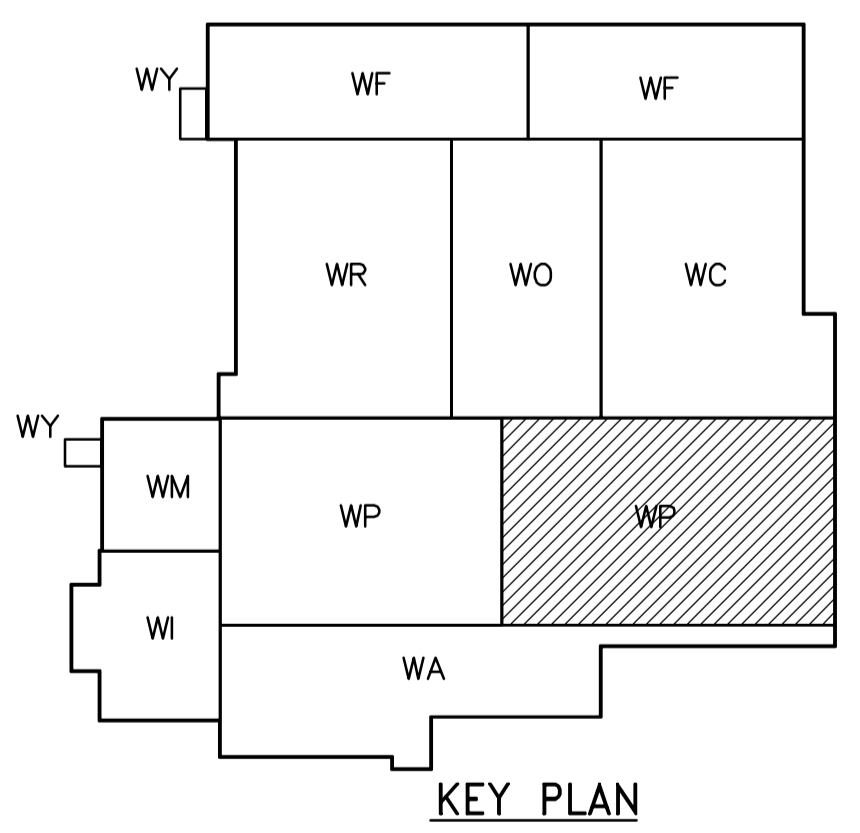

FIRST FLOOR POWER AND LIGHTING PLAN (AREA 2)  
1:100

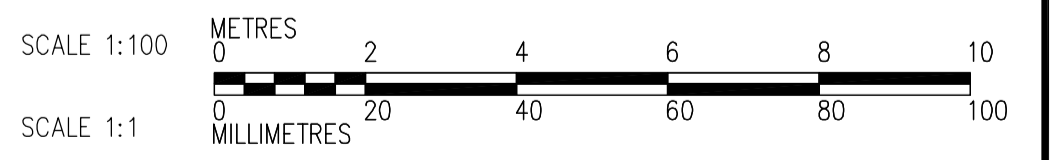

|  |   |  |  |  |  |  |  |  |
|--|---|--|--|--|--|--|--|--|
| <p><b>APEGN</b><br/>Certificate of Authorization<br/>CH2M HILL Canada Ltd.<br/>No. 1441 Expiry: April 30, 2007</p> | <p>Frederickson Cooper<br/>ARCHITECTS</p>                   |  | <p>A You International Ltd. Company</p>  |  | ENGINEER'S SEAL<br><br>ORIGINAL<br>SIGNED BY<br>L.D. LLEWELLYN<br>2006/03/29 | <p><b>THE CITY OF WINNIPEG</b><br/>WATER AND WASTE DEPARTMENT<br/>ENGINEERING DIVISION</p> | WATER TREATMENT PLANT<br>FLOCCULATION AND DAF<br>MECHANICAL AND ELECTRICAL | CITY FILE NUMBER<br>SHEET OF                   |
|  | DESIGNED BY JT CHECKED BY ND<br>DRAWN BY KJ APPROVED BY AHL |  | SCALE: 1:100<br>RELEASED FOR CONSTRUCTION BY:<br>R. SOROKOWSKI   |  | CONSULTANT DRAWING NO.<br>WP-E0116   |  | ELECTRICAL<br>FLOC/DAF AREA 2<br>FIRST FLOOR POWER AND LIGHTING PLAN       | CITY DRAWING NUMBER<br>1-0601P-A-E0116-001-02D |
|  | NO. REVISIONS DATE BY DATE 2005/07/12 DATE 2006/03/29       |  | 02 742-2005 ADDENDUM 5 06/05/19 LL<br>01 742-2005 ADDENDUM 3 06/05/05 LL<br>00 ISSUED FOR TENDER 06/03/29 LL |  |  |  |  |  |
|  |   |  |  |  |  |  |  |  |