

**PRESENTATION OF PROPOSED STAGE 1 DETOUR OPERATION
(SPRING 2008 – FALL 2008)
WESTBOUND BRIDGE CLOSED**

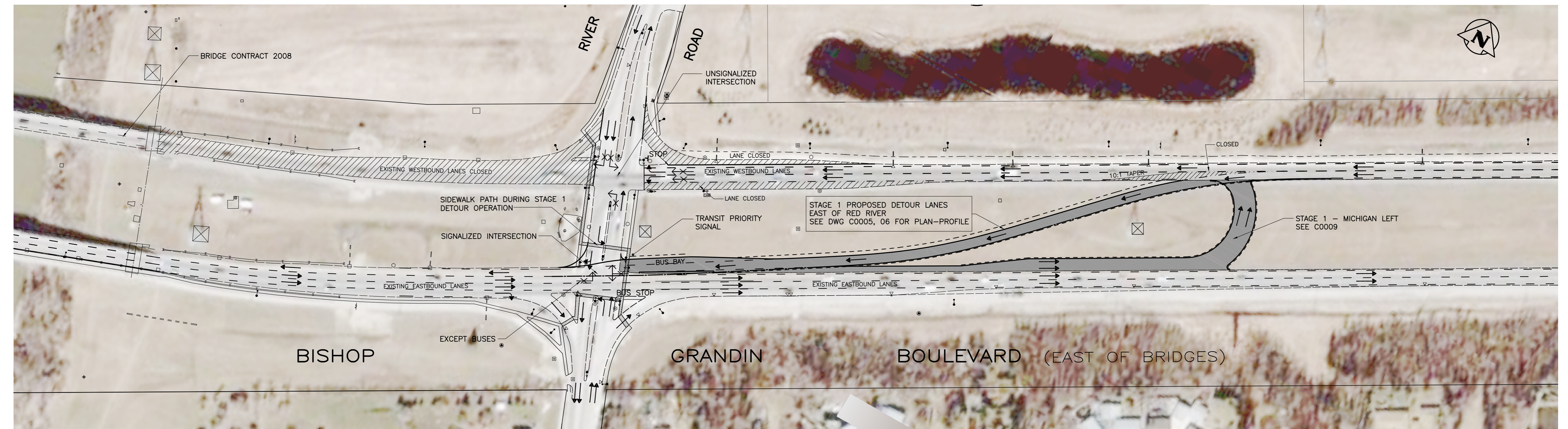

LEGEND:

	TRAFFIC MOVEMENT PROHIBITED
	TRAFFIC MOVEMENT ALLOWED
	NEW PAVEMENT FOR DETOUR ROADWAYS
	EXISTING ROADWAYS AND SIDEWALKS CLOSED DURING CONSTRUCTION

AERIAL PHOTO BACKGROUND IS FOR PRESENTATION PURPOSES ONLY AND IS NOT FULLY ORTHORECTIFIED. DIRECTIONS, DISTANCES, AND/OR ALIGNMENTS SHOULD NOT BE PERFORMED OR INFERRED FROM THE PHOTOGRAPH.

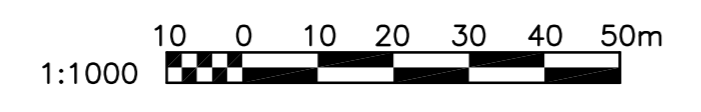

APEGN
Certificate of Authorization
Wardrop Engineering Inc.
No. 195 Expiry: April 30, 2008

B.M. ELEV.		F.B. 2153	
01	ISSUED FOR ADDENDUM 2	07.08.16	WJF
00	ISSUED FOR TENDER	07.08.08	WJF
NO.	REVISIONS	DATE	BY

WARDROP | Engineering Inc.

DESIGNED BY	DAL	CHECKED BY	WJF
DRAWN BY	NL	APPROVED BY	
HOR. SCALE: 1 : 1000		RELEASED FOR CONSTRUCTION	
VERTICAL:		DATE	
		DATE 07.07.02	

PRELIMINARY DRAWING

NOT TO BE USED FOR CONSTRUCTION

CONSULTANT DRAWING NO.
0600070700-DWG-C1001-01

THE CITY OF WINNIPEG
PUBLIC WORKS DEPARTMENT
ENGINEERING DIVISION

FORT GARRY BRIDGE REHABILITATION

**STAGE 1 (2008 PROPOSED OPERATION)
PROPOSED DETOUR LANES
OVERALL PLAN SHOWING TRAFFIC MOVEMENTS**

CITY DRAWING NUMBER
SHEET 1 OF 9
C0001