

1 DECK REINFORCING CROSS SECTION
1 : 20

NOTE
 INFORMATION ABOUT EXISTING DECK REINFORCING WAS TAKEN FROM "AS-BUILT" DRAWINGS DATED NOV. 6/79. BAR SIZES ARE IMPERIAL DESIGNATION AS FOLLOWS:
 #6 - 3/4" (19.0mm) DIA. - AREA = 284mm²
 #5 - 5/8" (15.9mm) DIA. - AREA = 200mm²

D1901X DWLS. @ 350± DRILL & EPOXY GROUT 500 INTO EXISTING CONCRETE - MATCH EXIST. REINF. BARS TO AVOID NELSON STUDS ON THE GIRDER

D1901X DWLS. @ 350± DRILL & EPOXY GROUT 500 INTO EXISTING CONCRETE - MATCH EXIST. REINF. BARS TO AVOID NELSON STUDS ON THE GIRDER

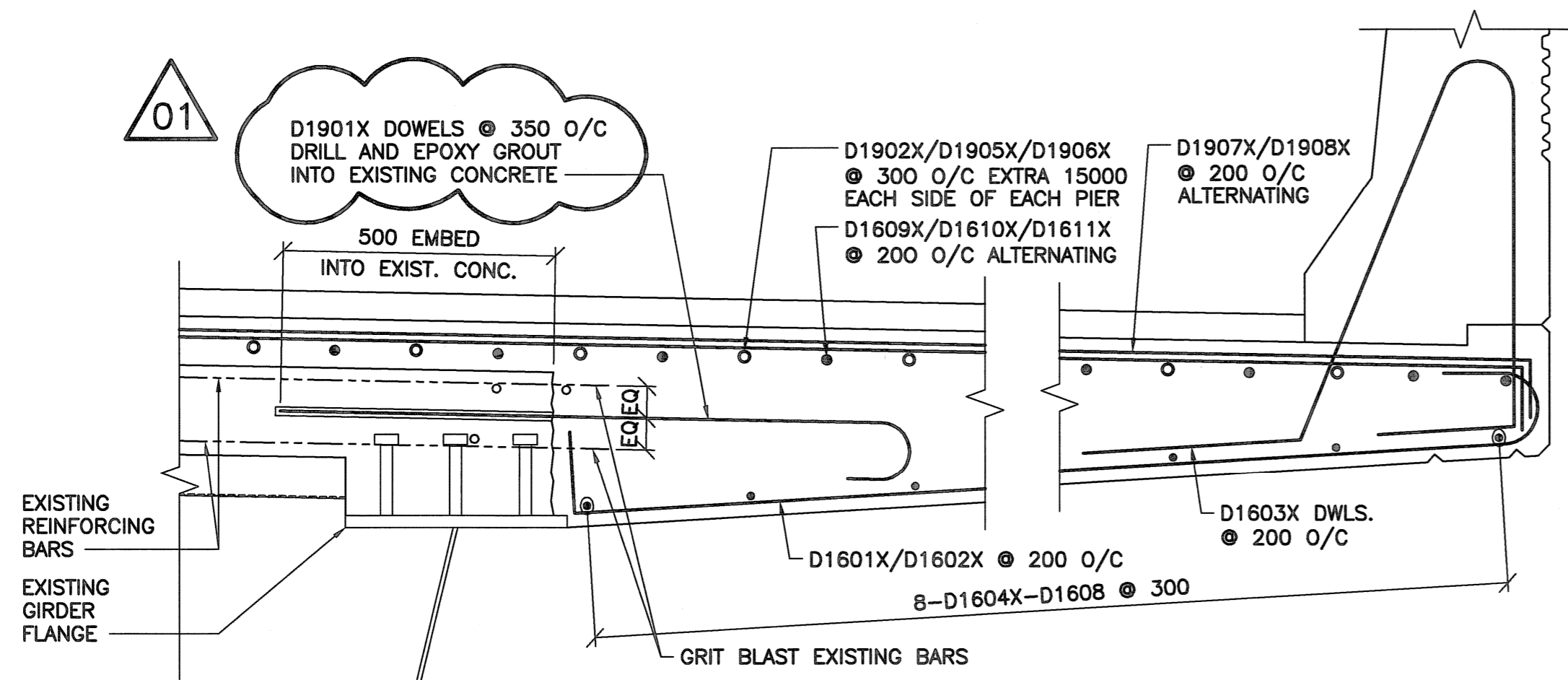

2 DECK REINFORCING CANTILEVER DETAIL
1 : 10

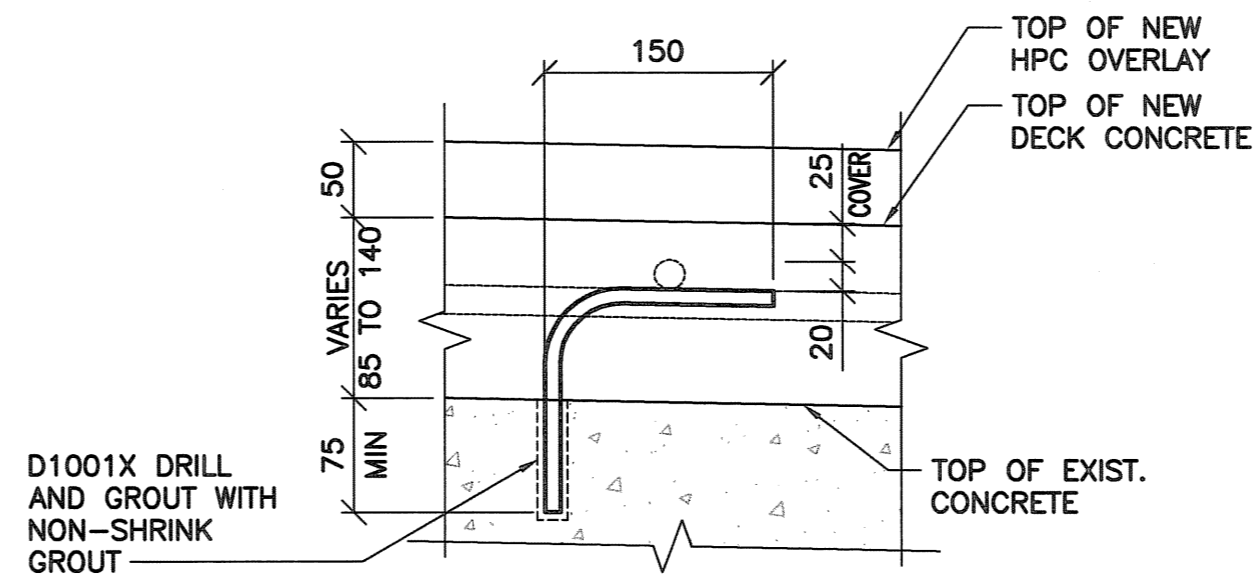

3 TYPICAL CHAIR DETAIL
1 : 5
 - CHAIRS ARE PLACED TO ENSURE A COVER OF 25mm TO THE TOP OF NEW DECK CONCRETE FOR THE UPPERMOST BARS



B.M. ELEV.	F.B.	WARDROP Engineering Inc.	ORIGINAL DRAWING REVISION "00" SEALED BY E.F. SHEHATA 08.02.05	THE CITY OF WINNIPEG PUBLIC WORKS DEPARTMENT TRANSPORTATION ENGINEERING DIVISION	CITY DRAWING NUMBER B173-08-029W SHEET 29 OF 54
DESIGNED BY E.F.S.	CHECKER [Signature]				
DRAWN BY P.S.	APPROVED BY [Signature]	HORIZ. SCALE: AS NOTED VERTICAL: AS NOTED	DATE 08.02.05 MANDY FINDAS, P. ENG. BRIDGE PROJECTS ENGINEER		
01 ISSUED FOR ADDENDUM #2 08.03.05 [Signature]	08.03.05 [Signature]				
00 ISSUED FOR TENDER 08.02.05 E.F.S.	08.02.05 E.F.S.				
NO. REVISIONS	DATE BY	DATE	08.02.05		