

WESTBOUND (WB) CONTROL LINE / BASELINE						
CONTROL POINT	STATION	COORDINATES		PARAMETER	CURVE DATA	
		NORTHING	EASTING		(5)	(7)
P.O.T.	0+100	5518200.782	632216.217	R.	307.400	2000.000
T.C.	0+398.600	5518189.873	632514.617	Δc	30°08'39"	1°34'32"
C.T.	0+560.328	5518225.778	632670.403	Tc	82.783	27.502
T.C.	0+760.929	5518320.111	632847.439	L.	161.728	55.000
C.T.	0+815.929	5518345.304	632896.328	L.C.	159.869	54.998
T.C.	0+888.034	5518377.530	632961.032			
C.T.	0+943.214	5518402.723	633009.921			
P.O.T.	1+011.771	5518434.962	633070.425			

EASTBOUND (EB) CONTROL LINE				
CONTROL POINT	STATION	COORDINATES		CURVE DATA
		NORTHING	EASTING	
P.O.T.	0+100	5518191.513	632219.029	R. 300.000
T.C.	0+424.656	5518179.653	632543.469	Δc 31°12'10"
C.T.	0+588.034	5518217.344	632700.371	Tc 83.769
P.O.T.	0+687.912	5518265.932	632787.634	L. 163.377
				L.C. 161.366

EASTBOUND LEFT TURN LANE (EB LTL) CONTROL LINE				
CONTROL POINT	STATION	COORDINATES		CURVE DATA
		NORTHING	EASTING	
T.C.	0+403.755	5518183.914	632522.709	R. 200.000
C.T.	0+483.499	5518196.755	632600.878	Δc 22°50'42"
				Tc 40.409
				L. 79.744
				L.C. 79.217

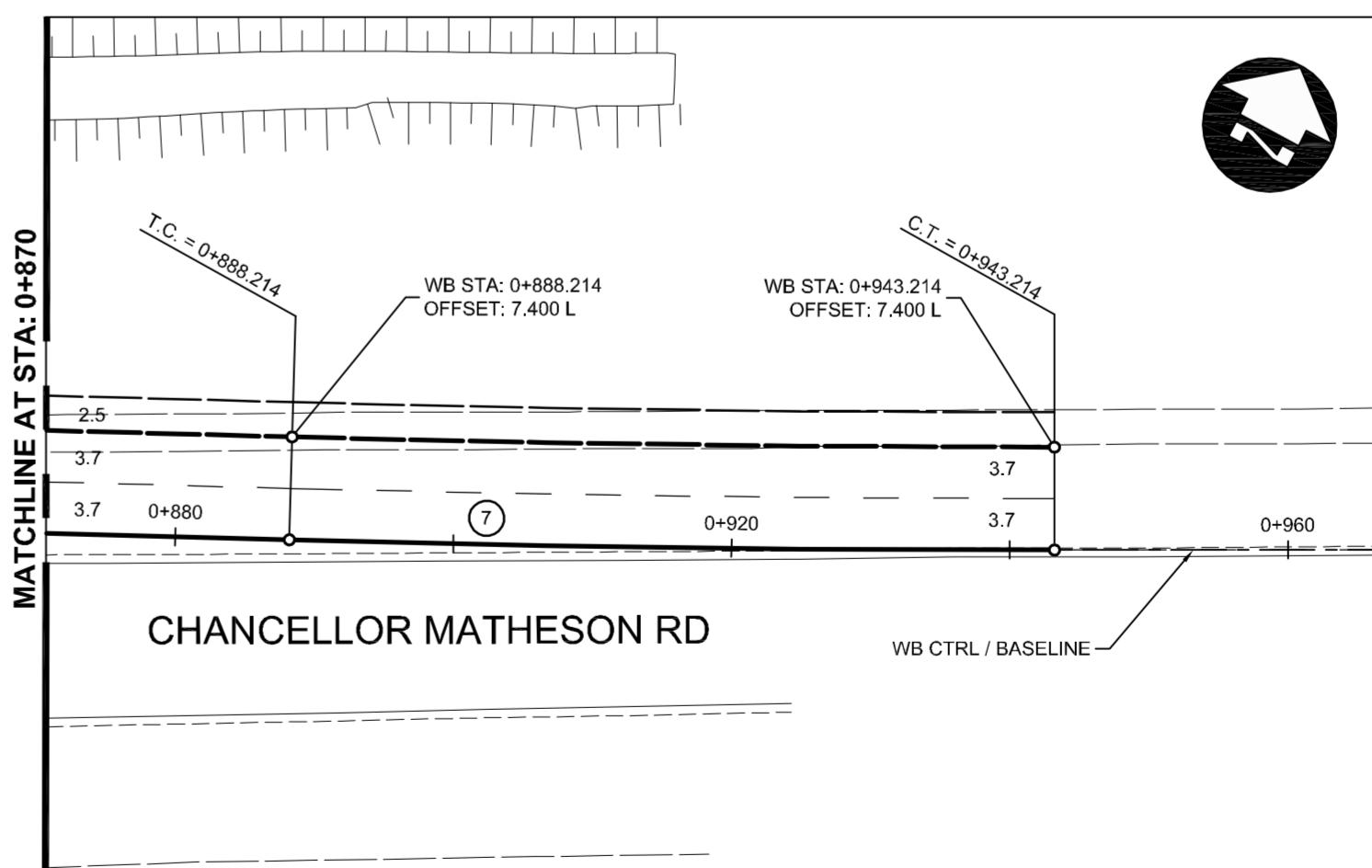

METRIC
WHOLE NUMBERS INDICATE MILLIMETRES
DECIMALIZED NUMBERS INDICATE METRES

WARNING
IF POWER EQUIPMENT OR EXPLOSIVES ARE TO BE USED FOR EXCAVATION ON THIS PROJECT THE CONTRACTOR MUST:
1. NOTIFY THE GAS COMPANY OF THE PROPOSED LOCATION OF EXCAVATION.
2. TAKE PRECAUTION TO AVOID DAMAGE TO GAS COMPANY INSTALLATIONS SEE PROVINCIAL REGULATION 210/72 FOR DETAILS.
3. OBTAIN EXCAVATION PERMITS PRIOR TO CONSTRUCTION.

150 MM	WATERMAIN	150 MM	HYDRO	HYDRO	150 mm W.M.	WATERMAIN	150 mm W.M.
⊕	HYDRANT VALVE	⊕	M.T.S.	M.T.S.	+	HYDRANT VALVE	+
300 LDS	LAND DRAINAGE SEWER	300 LDS			300 mm L.D.S.	LAND DRAINAGE SEWER	300 mm L.D.S.
250 WWS	WASTE WATER SEWER	250 WWS			250 mm W.W.S.	WASTE WATER SEWER	250 mm W.W.S.
○	MANHOLE	●			—	PROFILE	—
□	CATCH BASIN	■			—	NORTH/WEST GUTTER	—
▽	CURB INLET	▽			—	SOUTH/EAST GUTTER	—
—	JUNCTIONS	—			—	NORTH/WEST T/LANE	—
—	CULVERT	—			—	SOUTH/EAST T/LANE	—
100 GAS	GAS	100 GAS			—		—
EXISTING	LEGEND—PLAN	PROPOSED	EXISTING	LEGEND—PLAN	PROPOSED	EXISTING	LEGEND—PROFILE

UNDERGROUND STRUCTURES		B.M.	654271 N 551792.470 E 632610.651
SUPPLY, U/G STRUCTURES COMMITTEE <td>DATE</td> <td>ELEV.</td> <td>233.084</td>	DATE	ELEV.	233.084
NOTE:			
LOCATION OF UNDERGROUND STRUCTURES AS SHOWN ARE BASED ON THE BEST INFORMATION AVAILABLE BUT NO GUARANTEE IS GIVEN THAT ALL EXISTING UTILITIES ARE SHOWN OR THAT THE GIVEN LOCATIONS ARE EXACT. CONFIRMATION OF EXISTENCE AND EXACT LOCATION OF ALL SERVICES MUST BE OBTAINED FROM THE INDIVIDUAL UTILITIES BEFORE PROCEEDING WITH CONSTRUCTION.			
2	ISSUED FOR ADDENDUM #1	11/07/04	JNC
1	ISSUED FOR TENDER	11/06/23	JNC
NO.	REVISIONS	DATE	BY

DESIGNED BY	RTP
DRAWN BY	PMW
CHECKED BY	JNC
APPROVED BY	DPK
HOR. SCALE	1:500
VERTICAL	
RELEASED FOR CONSTRUCTION	ORIGINAL SIGNED BY B. KIBBINS
DATE	11/06/23

ENGINEER'S SEAL
PROVINCE OF MANITOBA
ORIGINAL STAMPED BY
J.N. CRANG
2011/06/23
REGISTERED PROFESSIONAL ENGINEER

THE CITY OF WINNIPEG
PUBLIC WORKS DEPARTMENT

Winnipeg

BISON DRIVE & PEMBINA HIGHWAY INTERSECTION IMPROVEMENTS

CITY DRAWING NUMBER: P-3327-3
SHEET 3 OF 24

CONTROL LINE GEOMETRY
BISON DR. & CHANCELLOR MATHESON RD.

CONSULTANT PROJECT NUMBER: 11-4587
CONSULTANT DRAWING NUMBER

G:\CAD\114587\Contract\Current\Roadway\CONTROL_LINE_GEOMETRY.dwg