

1
NTS
WAVERLEY STREET CROSS SECTION
(STA 10+31.3 TO STA 14+95.6)

DWG NORTH

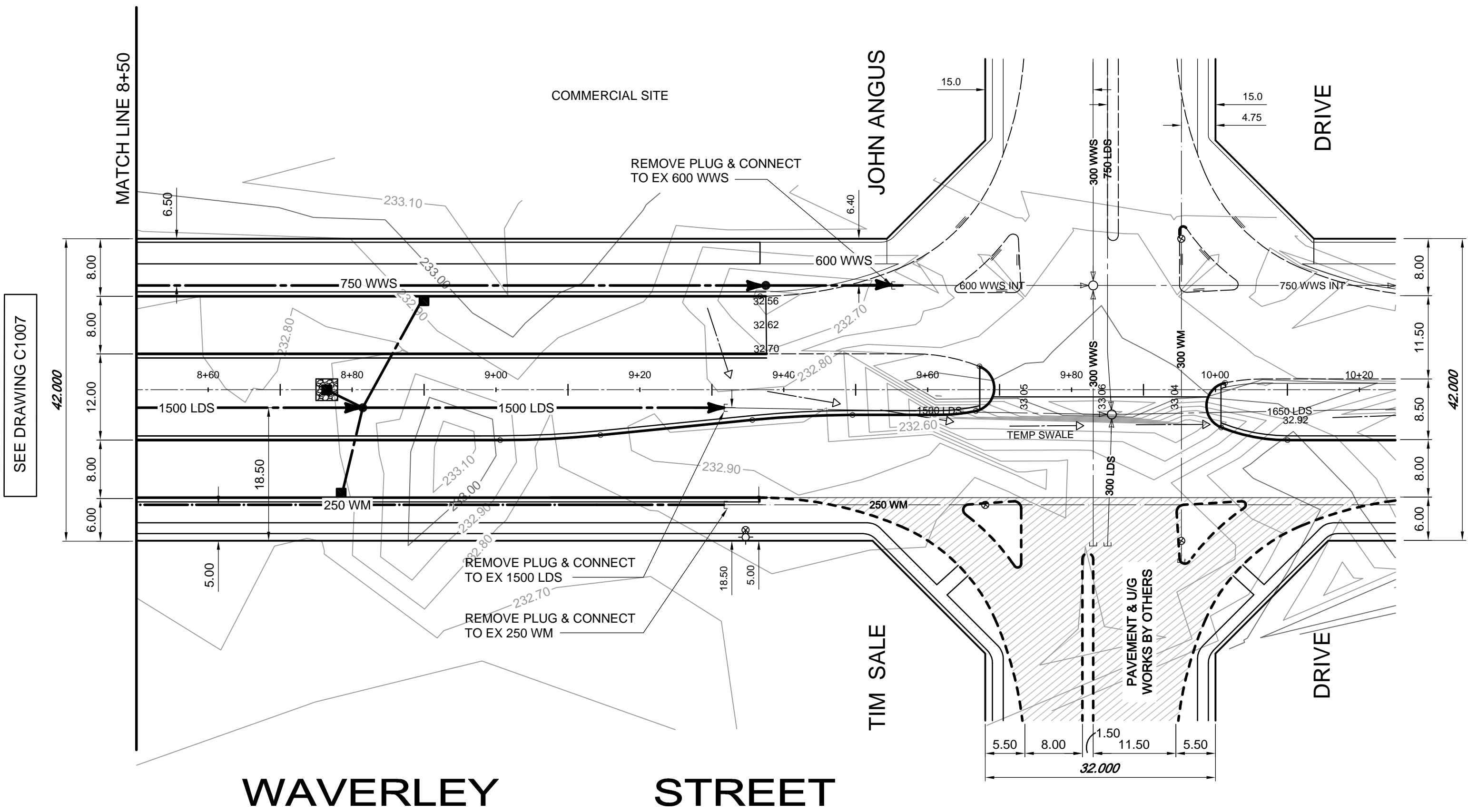

WAVERLEY STREET

- CONSTRUCTION NOTES**
- ALL HYDRANTS AS PER SD-006.
 - ALL PAVEMENT DIMENSIONS ARE TO BACK OF CURB.
 - ALL BACKFILL UNDER BOULEVARD TO BE CLASS 4 UNLESS OTHERWISE NOTED.
 - ALL PIPE UNDER EXISTING AND FUTURE PAVEMENT TO BE INSTALLED USING TRENCHLESS METHODS, WHERE NOT POSSIBLE, OPEN CUT WITH CLASS 2 BACKFILL.
 - USE CLASS 2 BACKFILL WITHIN 3.0m OF NEW MANHOLE INSTALLATIONS.
 - THE LAST RISER SECTION ON ALL NEW MANHOLES TO BE A 300mm SECTION JUST BELOW THE FLAT TOP REDUCER FOR THE PURPOSE OF FUTURE ADJUSTMENT OF MANHOLES.

- GENERAL NOTES**
- CHAINAGE IS ALONG CENTRE LINE OF PROPOSED WAVERLEY STREET RIGHT-OF-WAY.
 - STATION 10+00 - E/L JOHN ANGSTIM SALE DRIVE.
 - SEE DRAWINGS C1001 TO C1005 FOR SURFACE WORKS.

Coordinate Control Survey Monuments

No.	Description	Northing	Easting	Elevation
CP 1	IB CP1	3000.000	10000.000	232.535
CP 2	IB CP3	2741.671	10000.000	232.363
CP 3	GBM82024	2675.060	10035.366	232.259
CP 4	GBM82025	1827.090	10031.834	232.917

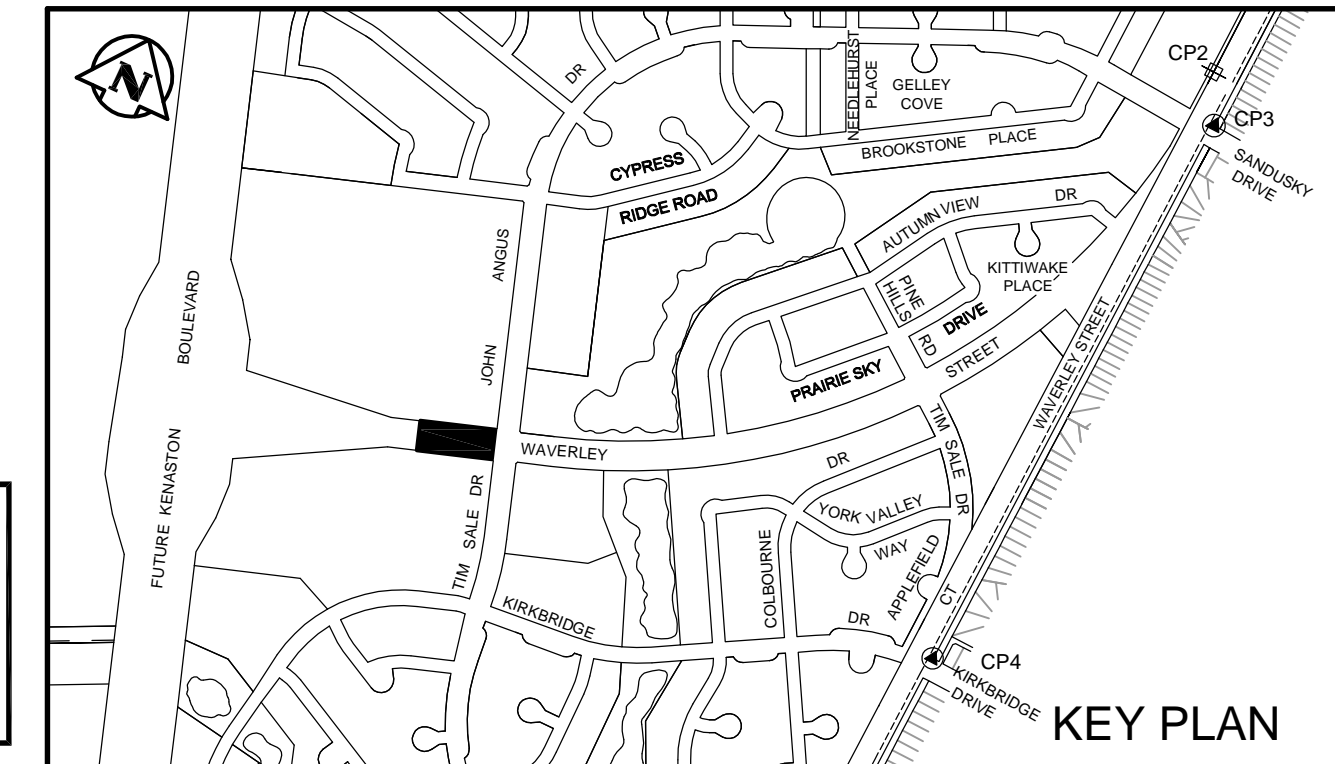

APEGM
Certificate of Authorization
Wardrop Engineering Inc.
No. 195 Expiry: April 30, 2013

EXISTING	LEGEND-PLAN	PROPOSED	EXISTING	LEGEND-PLAN	PROPOSED	EXISTING	LEGEND-PLAN	PROPOSED
150 WM	WATERMAIN	150 WM	SWALE	RIGHT-OF-WAY	LOCATION APPROVED UNDERGROUND STRUCTURES	B.M. ELEV.		
400 FM	FEEDERMAIN	400 FM	MANHOLE	GAS				
300 LDS	LAND DRAINAGE SEWER	300 LDS	CATCHBASIN	HYDRO				
250 WWS	WASTEWATER SEWER	250 WWS	HYDRO BOX	MTS				
300 CS	COMBINED SEWER	300 CS	HYDRO POLE	SPRINKLER				
200 FCM	FORCEMAIN	200 FCM	LIGHT STANDARD	ELEVATION				
	JUNCTIONS		ANCHOR	SIDEWALK				
	HYDRANT		TREE	CURB				
	VALVE		SURVEY BAR	ASPHALT				
	CURB STOP		SIGNAL CONTROLLER	CONCRETE				
	LEGEND-PLAN		LEGEND-PLAN	LEGEND-PLAN				

LOCATION APPROVED UNDERGROUND STRUCTURES

SUPV. U/G STRUCTURES COMMITTEE DATE

NOTE: LOCATION OF UNDERGROUND STRUCTURES AS SHOWN ARE BASED ON THE BEST INFORMATION AVAILABLE. BUT NO GUARANTEE IS GIVEN THAT ALL EXISTING UTILITIES ARE SHOWN OR THAT THE GIVEN LOCATIONS ARE EXACT. CONFIRMATION OF EXISTENCE AND EXACT LOCATION OF ALL SERVICES MUST BE OBTAINED FROM THE INDIVIDUAL UTILITIES BEFORE PROCEEDING WITH CONSTRUCTION.

TETRA TECH

DESIGNED BY: GWC
DRAWN BY: GMD

CHECKED BY:
APPROVED BY:

HOR. SCALE: 1:500
VERTICAL: 1:50

12.06.19
12.06.11

01 ISSUED FOR ADDENDUM No. 1
00 ISSUED FOR TENDER

PRELIMINARY DRAWING

NOT TO BE USED FOR CONSTRUCTION

CONSULTANT DRAWING NO. 1200070300-DWG-C1008-01

THE CITY OF WINNIPEG
WATER AND WASTE DEPARTMENT

WAVERLEY STREET EXTENSION
KENASTON BOULEVARD (FUTURE) TO TIM SALE DRIVE

WAVERLEY STREET UNDERGROUND SERVICES
118m WEST OF TIM SALE DRIVE TO
TIM SALE DRIVE

CITY DRAWING NUMBER
SHEET 8 OF 11
C1008