

- 1+18.80 CONNECT TO EXIST 150 AC WM
- 1+18.80 INSTALL 150-45° BEND
- 1+18.80 INSTALL 150-45° BEND
- 0+94.516 S R GRANT AVE & INSTALL 150 VALVE
- 0+94.55 ABANDON EXIST VALVE
- 0+98.78 REMOVE EXIST 200x200x150 CROSS AND INSTALL 200x200x150 CROSS
- 1-00
- 1+04.00 INSTALL 150-45° VERT. BEND (SD-005)
- 1+05.00 INSTALL 150-45° VERT. BEND (SD-005)
- 1+06.71 EXIST BEND
- 1+06.83 EXIST BEND
- 1+08.34 EXIST BEND
- 1+09.72 EXIST BEND
- 1+18.80 INSTALL 150-45° VERT. BEND (SD-005)
- 1+19.80 INSTALL 150-45° VERT. BEND (SD-005)
- 1+25 N R GRANT AVE & INSTALL 150 VALVE
- 1+25.59 ABANDON EXIST VALVE
- 1+26.42 REMOVE EXIST HYDRANT
- 1+26.50 INSTALL HYDRANT (SD-007)
- 1+28.00 INSTALL 150x150x150 TEE
- 1+50 GRADE CHANGE
- 1+87.50 INSTALL HYDRANT (SD-007)
- 1+89.00 INSTALL 150x150x150 TEE

NOTE: CHAINAGES SHOWN ARE ALONG E R OF WAVERLEY ST

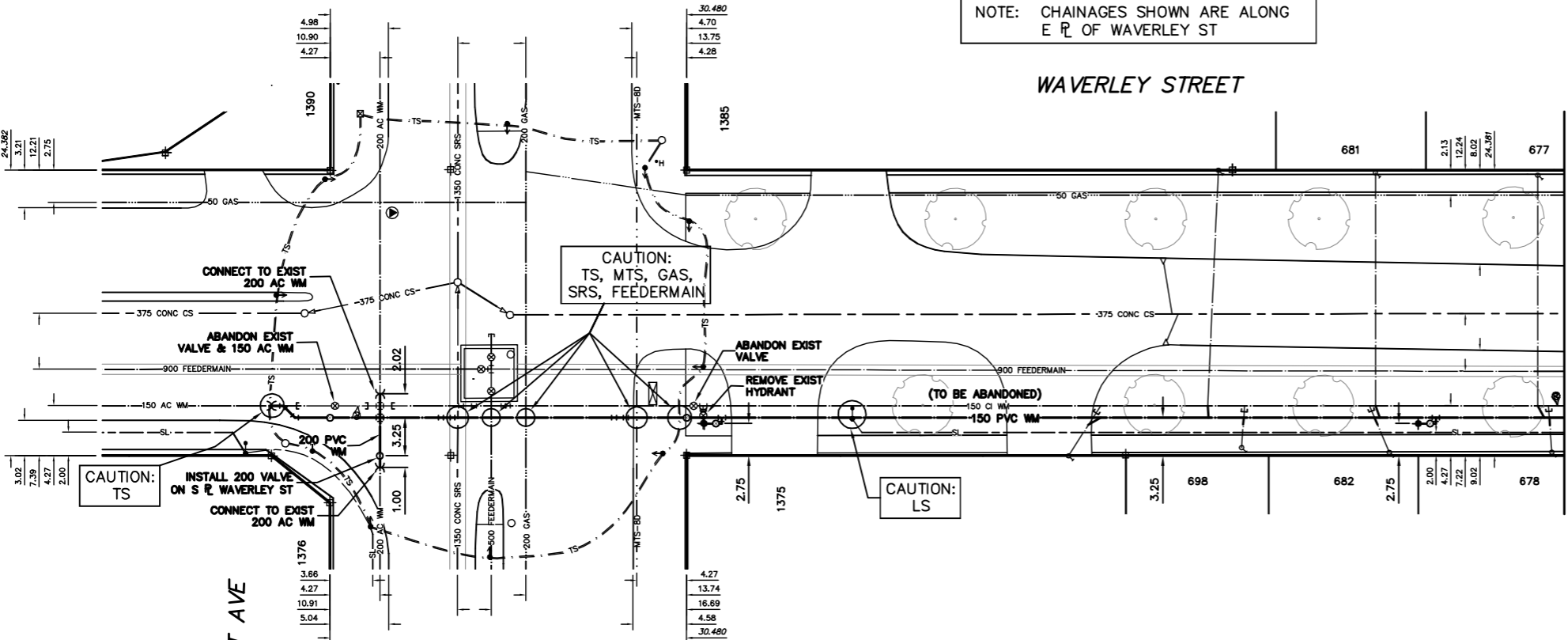

WATER SERVICE INFORMATION

ADDRESS	SIZE (mm) (STREET)	SIZE (mm) (PROP.)	SHORT & LONG MEASUREMENT	CORP. LOCATION	REMARKS
677 WAVERLEY ST	20	20	72.71>NNL GRANT	OPP S/C	-
RESIDENTIAL	COPPER	COPPER	-	-	-
678 WAVERLEY ST	20	20	73.88>NNL GRANT	0.3 S OF S/C	-
RESIDENTIAL	COPPER	COPPER	-	-	-
681 WAVERLEY ST	20	20	58.78>NNL GRANT	OPP S/C	-
RESIDENTIAL	COPPER	COPPER	-	-	-
682 WAVERLEY ST	20	20	60.09>NNL GRANT	1.8 S OF S/C	-
RESIDENTIAL	COPPER	COPPER	-	-	-
698 WAVERLEY ST	20	20	47.51>NNL GRANT	0.3 N OF S/C	-
RESIDENTIAL	COPPER	COPPER	-	-	-
1375 GRANT AVE	25	25	32.65>NNL GRANT	2.7 N OF S/C	SERV. OFF WAVERLEY
RESIDENTIAL	COPPER	COPPER	-	-	-
1385 GRANT AVE	25	25	45.47>NNL GRANT	0.8 S OF S/C	SERV. OFF WAVERLEY
RESIDENTIAL	COPPER	COPPER	-	-	-

*SERVICES TO BE RENEWED TO R ALL OTHERS TO BE RECONNECTED

CONSTRUCTION NOTES:

NO CONSTRUCTION EQUIPMENT OR MATERIAL TO BE PLACED OR SETUP DIRECTLY OVER 900 FEEDERMAIN.

DO NOT USE VIBRATORY EQUIPMENT WITHIN 3.0 m OF 900 FEEDERMAIN.

NOTE: ALL VALVES TO BE INSTALLED COUNTER-CLOCKWISE TO CLOSE

METRIC
WHOLE NUMBERS INDICATE MILLIMETRES
DECIMALIZED NUMBERS INDICATE METRES

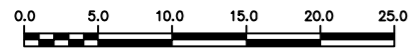

WARNING

IF POWER EQUIPMENT OR EXPLOSIVES ARE TO BE USED FOR EXCAVATION ON THIS PROJECT THE CONTRACTOR MUST:

- NOTIFY THE GAS COMPANY OF THE PROPOSED LOCATION OF EXCAVATION.
- TAKE PRECAUTION TO AVOID DAMAGE TO GAS COMPANY INSTALLATIONS.

SEE PROVINCIAL REGULATION 210/72 FOR DETAILS

LOCATION APPROVED UNDERGROUND STRUCTURES

SUPV. U/G STRUCTURES COMMITTEE DATE

NOTE:
LOCATION OF UNDERGROUND STRUCTURES AS SHOWN ARE BASED ON THE BEST INFORMATION AVAILABLE BUT NO GUARANTEE IS GIVEN THAT ALL EXISTING UTILITIES ARE SHOWN OR THAT THE GIVEN LOCATIONS ARE EXACT. CONFIRMATION OF EXISTENCE AND EXACT LOCATION OF ALL SERVICES MUST BE OBTAINED FROM THE INDIVIDUAL UTILITIES BEFORE PROCEEDING WITH CONSTRUCTION.

NO.	REVISIONS	DATE	BY
1	ADDENDUM REVISIONS (TEXT MASKING)	12/08/02	CJH

DESIGNED BY	NC	CHECKED BY	SC
DRAWN BY	CJH	APPROVED BY	KZ
SCALE:	HORIZONTAL 1:250 VERTICAL 1:50		
RELEASED FOR CONSTRUCTION	K.R. ZUREK		
DATE	2012 07 31		
DATE	JULY 30, 2012		

ENGINEER'S SEAL

ORIGINAL SIGNED BY S.R.J. COURNOYER 12-07-30

CONSULTANT DRAWING NUMBER

THE CITY OF WINNIPEG
WATER AND WASTE DEPARTMENT
ENGINEERING DIVISION

2012 WATERMAIN RENEWALS

WAVERLEY STREET
GRANT AVENUE TO
75 N OF GRANT AVENUE

SHEET 8 OF 9
CITY DRAWING NUMBER
D-13031