

NOTE: CHAINAGES SHOWN ARE ALONG W. R. OF OSBORNE ST.

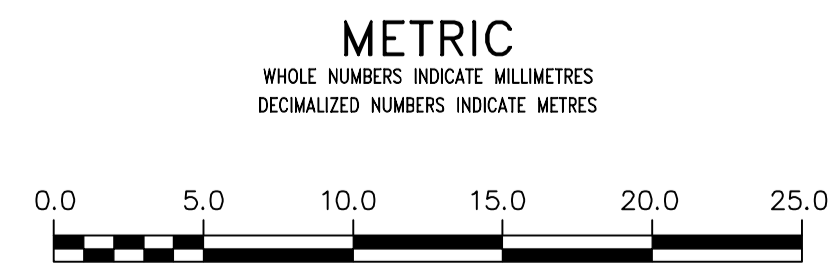
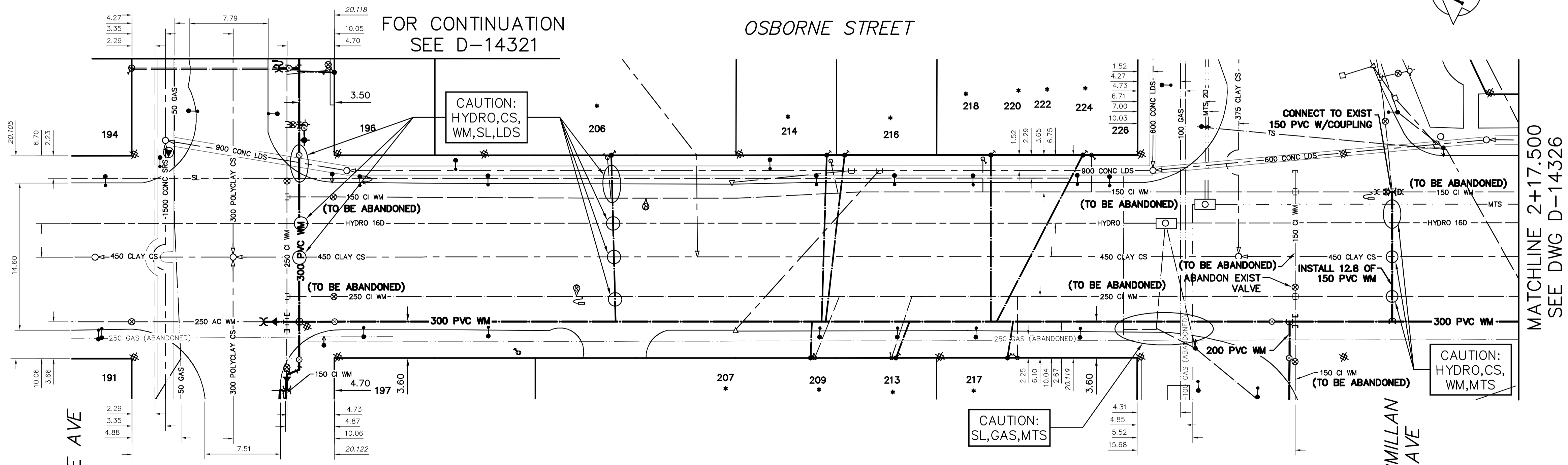

**WARNING**  
 IF POWER EQUIPMENT OR EXPLOSIVES ARE TO BE USED FOR EXCAVATION ON THIS PROJECT THE CONTRACTOR MUST:  
 1) NOTIFY THE GAS COMPANY OF THE PROPOSED LOCATION OF EXCAVATION.  
 2) TAKE PRECAUTION TO AVOID DAMAGE TO GAS COMPANY INSTALLATIONS.  
 SEE PROVINCIAL REGULATION 210/72 FOR DETAILS

**LOCATION APPROVED UNDERGROUND STRUCTURES**  
 SUPV. U/G STRUCTURES COMMITTEE DATE  
 NOTE:  
 LOCATION OF UNDERGROUND STRUCTURES AS SHOWN ARE BASED ON THE BEST INFORMATION AVAILABLE BUT NO GUARANTEE IS GIVEN THAT ALL EXISTING UTILITIES ARE SHOWN OR THAT THE GIVEN LOCATIONS ARE EXACT. CONFIRMATION OF EXISTENCE AND EXACT LOCATION OF ALL SERVICES MUST BE OBTAINED FROM THE INDIVIDUAL UTILITIES BEFORE PROCEEDING WITH CONSTRUCTION.

B.M. ELEV.					
1	REVISED DRAWING	16/05/30	RS		
NO.	REVISIONS	DATE	BY		

DESIGNED BY	JF	CHECKED BY	SC
DRAWN BY	RJ	APPROVED BY	KZ
SCALE:		RELEASED FOR CONSTRUCTION	
HORIZONTAL	1:250	DATE	2016 05 30
VERTICAL	1:50	DATE	2016 05 30
DATE	2016 05 30		
PLOT DATE:	2016 05 30		

ENGINEER'S SEAL  
 ORIGINAL SIGNED BY  
 S.R.J.  
 COURNOYER  
 16-05-30  
 CONSULTANT DRAWING NUMBER

**THE CITY OF WINNIPEG**  
 WATER AND WASTE DEPARTMENT  
 ENGINEERING DIVISION  
 2016 WATER MAIN RENEWALS  
 CONTRACT 8  
**OSBORNE STREET**  
 GERTRUDE AVENUE TO  
 38 E OF MCMILLAN AVENUE

FILE PATH: R:\DRAWINGS\WATER\RENEWAL\2016 RENEWALS\Contract 8\Construction Dwg\  
 FILE NAME: MCMILLAN-1.dwg

SHEET 10 OF 13  
 CITY DRAWING NUMBER  
**D-14325**

NOTE: ALL VALVES TO BE INSTALLED COUNTERCLOCKWISE TO CLOSE