

WAVERLY - SOUTHBOUND ROAD AND SIDEWALK/BIKE PATH PROFILES

SCALE H 1:1000
V 1:100

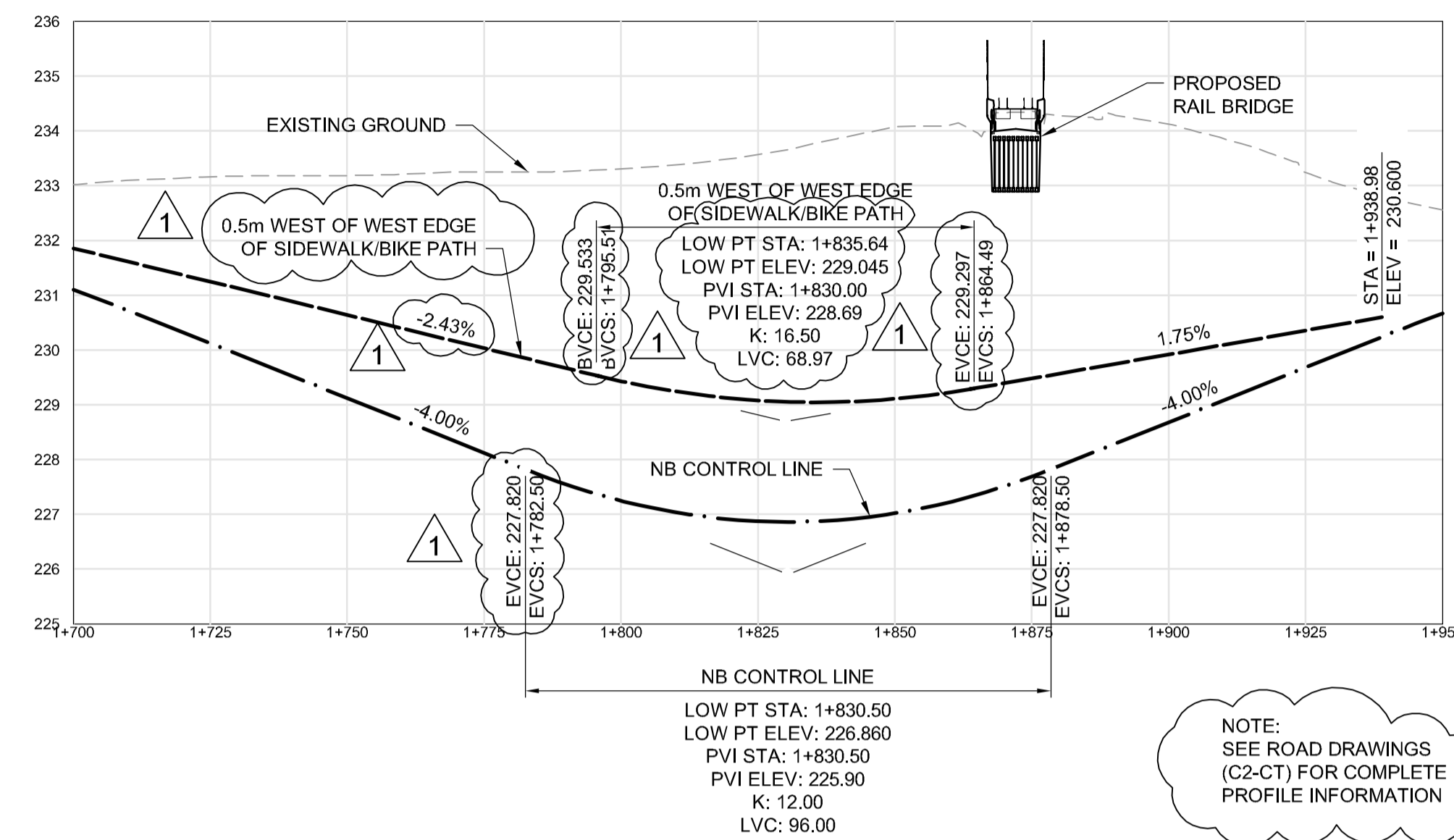

WAVERLY - NORTHBOUND ROAD AND SIDEWALK/BIKE PATH PROFILES

SCALE H 1:1000
V 1:100

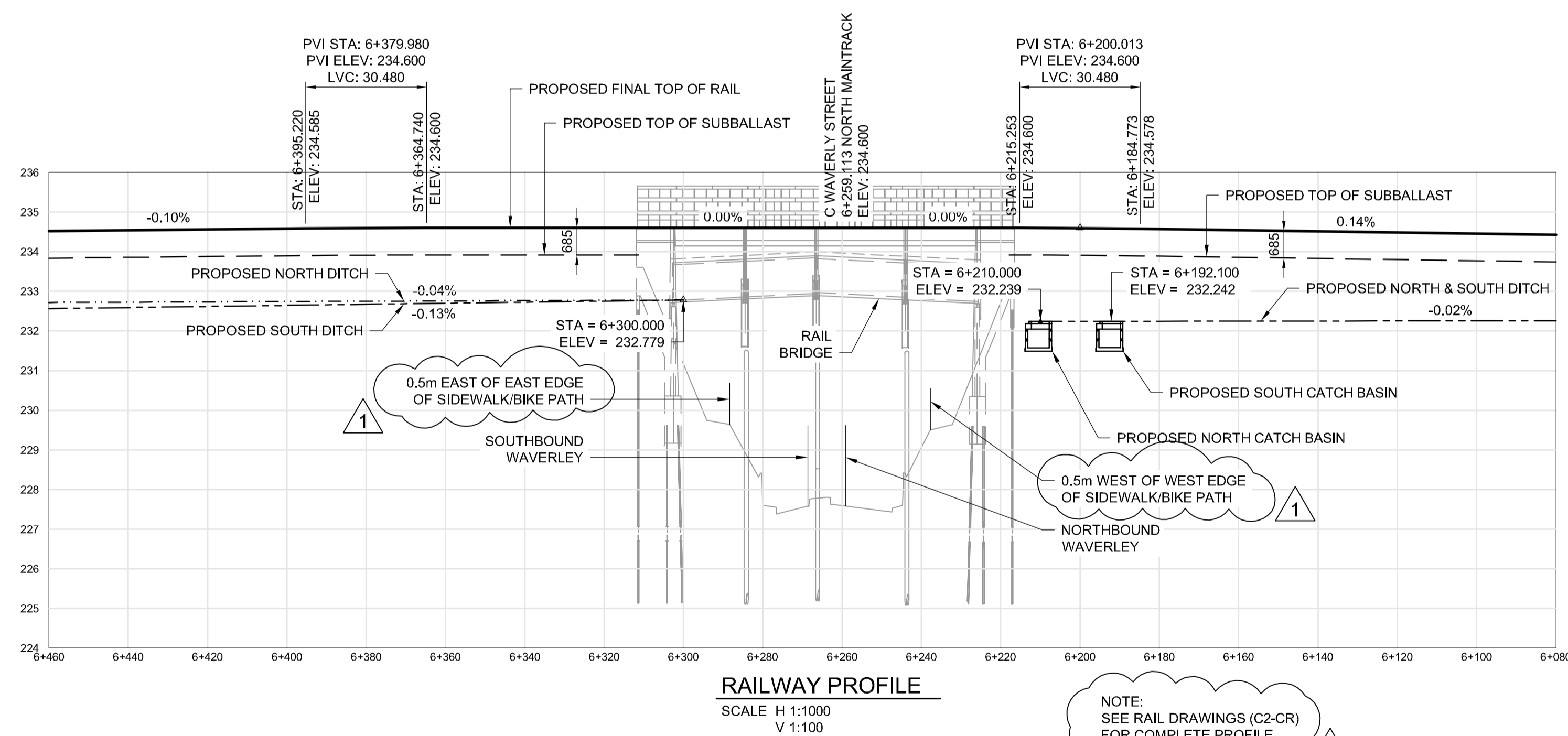

RAILWAY PROFILE

SCALE H 1:1000
V 1:100

NOTE:
SEE RAIL DRAWINGS (C2-CR)
FOR COMPLETE PROFILE
INFORMATION

NOTICE:
THE EXISTENCE, LOCATION AND ELEVATION OF UTILITIES AND/OR CONCEALED STRUCTURES AT THE PROJECT SITE ARE BASED ON THE BEST INFORMATION AVAILABLE AND ARE NOT GUARANTEED BY DILLON CONSULTING LIMITED. THE CONTRACTOR IS RESPONSIBLE FOR DETERMINING THE EXISTENCE, LOCATION AND ELEVATION OF ALL SUCH UTILITIES AND/OR CONCEALED STRUCTURES AND IS RESPONSIBLE FOR NOTIFYING THE APPROPRIATE COMPANY, DEPARTMENT OR PERSON(S) OF ITS INTENTION TO CARRY OUT HIS OPERATIONS.



NO.	REVISIONS	DATE	BY
1	ADDENDUM #1	17/01/25	RE
0	ISSUED FOR TENDER	17/01/09	RE

		DESIGNED BY	RE	CHECKED BY	SSR
		DRAWN BY	CGC	APPROVED BY	DBW
HOR. SCALE		AS SHOWN		RELEASED FOR CONSTRUCTION	
VERTICAL		AS SHOWN		DATE	

ENGINEER'S SEAL

 CONSULTANT PROJECT NUMBER
16-3353

THE CITY OF WINNIPEG
 PUBLIC WORKS DEPARTMENT

WAVERLEY STREET UNDERPASS AT CN MILE 3.89 RIVERS SUB
 CONTRACT 2: UNDERPASS STRUCTURE, RAILWORKS, ROADWORKS, LAND DRAINAGE SEWER, PUMPING STATION AND LANDSCAPING WORKS
 ROAD AND RAILWAY PROFILES AT BRIDGE SITE
 CITY DRAWING NUMBER: U-239-2016-C2-CS-004
 SHEET 004 OF 085
 CONSULTANT DRAWING NUMBER: C2-CS-004