

PHASE II - STAGE 1 NOTES:

- SUGGESTED SCHEDULE
- 12 MONTHS (PHASE II - STAGE 1, 2 AND 3)
 - NOVEMBER (2017) TO OCTOBER (2018)

- MAJOR CONSTRUCTION ACTIVITIES
1. REMOVE EXISTING CN TRackage (BY OTHERS)
 2. CONSTRUCTION OF WESTBOUND HURST ROADWAY AND DRAINAGE WORKS
 3. CONSTRUCTION OF LDS PUMPING STATION
 4. CONSTRUCTION OF LDS ALONG TAYLOR TWINNING
 5. CONSTRUCTION OF LDS AT TAYLOR/WAVERLEY INTERSECTION
 6. CONSTRUCTION OF UNDERPASS STRUCTURE
 7. REPLACEMENT OF WATERMAIN
 8. CONSTRUCTION OF AUXILIARY LANES AND DRAINAGE WORKS AT WILKES/HURST INTERSECTION
 9. RELOCATE HYDRO UTILITIES FOR TAYLOR TWINNING (BY OTHERS)
 10. RECONSTRUCT ENTRANCE LOOP AT 45 HURST WAY (FINAL REPAIRS AFTER TRANSIT BUSES FINISHED IN PHASE IV - STAGE 1)
 11. CONSTRUCT TAYLOR TWINNING FROM LINDSAY TO BOREBANK
 12. FEEDER MAIN CASING UNDER MAINLINE TRACKS

- TRAFFIC AND PEDESTRIAN CONTROL
- TRAFFIC AND PEDESTRIANS ALONG DETOUR ROADWAY
 - INTERMITTENT LANE AT A TIME CLOSURES AT WILKES/HURST
 - INTERMITTENT LANE AT A TIME CLOSURES ON WAVERLEY NORTH OF TAYLOR
 - INTERMITTENT LANE AT A TIME CLOSURES ON TAYLOR AT LINDSAY
 - ALL RAIL TRAFFIC ON SHOOFLY
 - THE FOLLOWING STREETS MUST HAVE TWO THROUGH LANES OPEN DURING THE SPECIFIED WEEKDAY PEAK PERIOD:
 - (7:00 - 9:00) EASTBOUND WILKES BETWEEN VICTOR LEWIS AND WAVERLEY
 - (7:00 - 9:00 & 15:30 - 17:30) NORTHBOUND DETOUR BETWEEN VICTOR LEWIS AND CAMBRIDGE
 - (15:30 - 17:30) SOUTHBOUND DETOUR BETWEEN CAMBRIDGE AND VICTOR LEWIS
 - (15:30 - 17:30) SOUTHBOUND WAVERLEY BETWEEN MATHERS AND TAYLOR

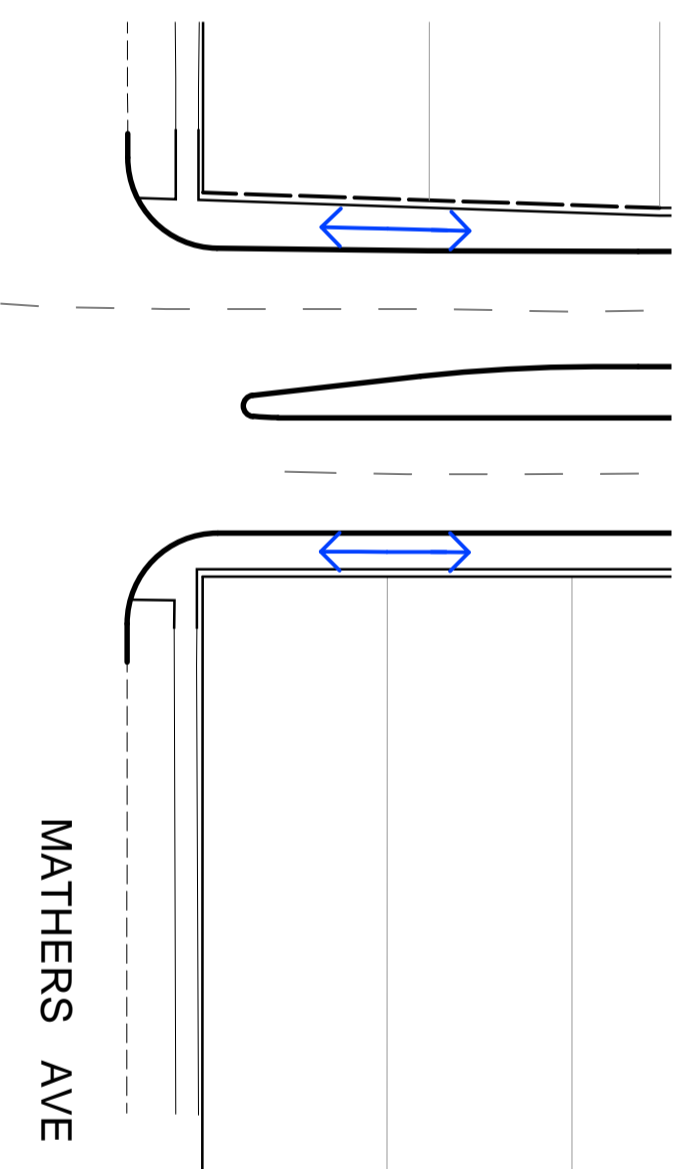
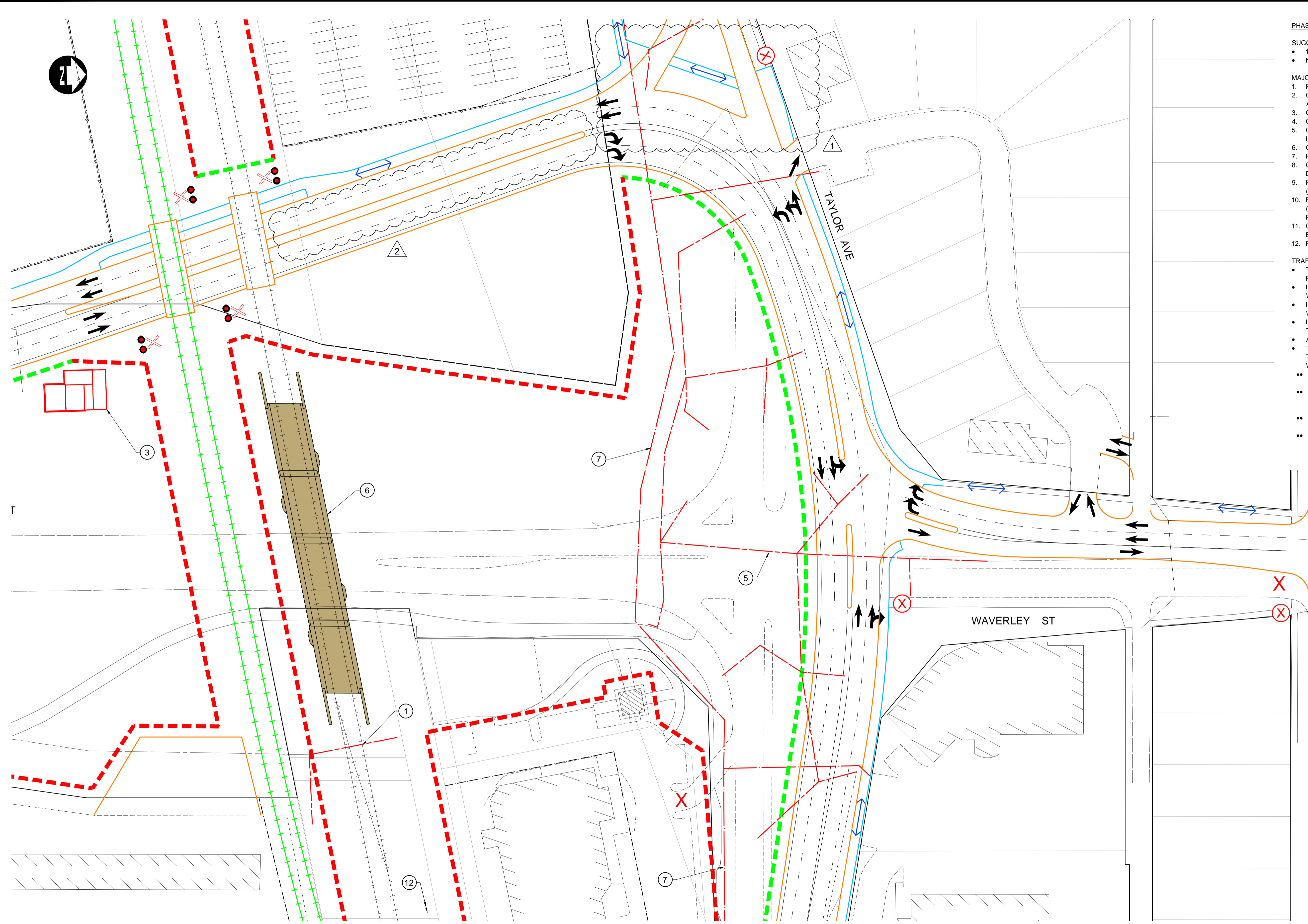

LEGEND - CONSTRUCTION STAGING

- | | | | | | |
|--|-------------------------------------|--|-------------------------------------|--|----------------------------|
| | ACTIVE RAILWAY | | TEMPORARY ROADWAY CONSTRUCTION | | VEHICULAR TRAFFIC |
| | INACTIVE RAILWAY | | TEMPORARY MEDIAN CONSTRUCTION | | PEDESTRIAN/CYCLIST TRAFFIC |
| | SHOOFLY CONSTRUCTION | | PERMANENT ROADWAY CONSTRUCTION | | LANE CLOSED |
| | PERMANENT RAILWAY CONSTRUCTION | | TEMPORARY SIDEWALK/MUP CONSTRUCTION | | SIDEWALK CLOSED |
| | MAJOR UNDERGROUNDS CONSTRUCTION | | PERMANENT SIDEWALK/MUP CONSTRUCTION | | TEMPORARY CROSSING SIGNALS |
| | EXISTING PROPERTY LINE | | BRIDGE CONSTRUCTION | | |
| | PROPOSED PROPERTY LINE | | | | |
| | CONSTRUCTION EASEMENT | | | | |
| | CONTRACTOR LAYDOWN AREA - ACCESS | | | | |
| | CONTRACTOR LAYDOWN AREA - NO ACCESS | | | | |

UNDERGROUND STRUCTURES

SUPPLY	U/G STRUCTURES	DATE

LOCATION OF UNDERGROUND STRUCTURES AS SHOWN ARE BASED ON THE BEST INFORMATION AVAILABLE. BUT NO GUARANTEE IS GIVEN THAT ALL EXISTING UTILITIES ARE SHOWN OR THAT THE GIVEN LOCATIONS ARE EXACT. CONFIRMATION OF EXISTENCE AND EXACT LOCATION OF ALL SERVICES MUST BE OBTAINED FROM THE INDIVIDUAL UTILITIES BEFORE PROCEEDING WITH CONSTRUCTION.

NO.	REVISIONS	DATE	BY	DATE
2	ADDENDUM #3	17/02/15	DBW	
1	ADDENDUM #1	17/01/25	DBW	
0	ISSUED FOR TENDER	17/01/09	DBW	

DESIGNED BY	CHECKED BY
TJH	RTP/DBW
DRAWN BY	APPROVED BY
TJH	DBW
HR. SCALE	RELEASED FOR CONSTRUCTION
1:500	
VERTICAL	DATE

ENGINEER'S SEAL

CONSULTANT PROJECT NUMBER
16-3353

THE CITY OF WINNIPEG
PUBLIC WORKS DEPARTMENT

WAVERLEY STREET UNDERPASS AT CN MILE 3.89 RIVERS SUB
CONTRACT 2: UNDERPASS STRUCTURE, RAILWORKS,
ROADWORKS, LAND DRAINAGE SEWER, PUMPING STATION
AND LANDSCAPING WORKS

CITY DRAWING NUMBER
U-239-2016-C2-GE-035

SHEET 035 OF 052

CONSULTANT DRAWING NUMBER
C2-GE-035

CONSTRUCTION STAGING
PHASE II - STAGE 1 (3 OF 4)

APEGM
Certificate of Authorization
Dillon Consulting Limited (MB)
No. 1789 Date: 17/01/09

G:\CAD\163353\Technical\Workspaces\Engineering\Drawings and Figures\Roadworks\Contract\163353-C2-CON-GE-STAGE-2.1.dwg