

REFER TO C2-LS-005 FOR
WAVERLEY AVE LANDSCAPE PLAN

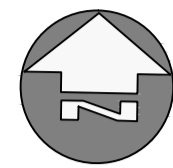
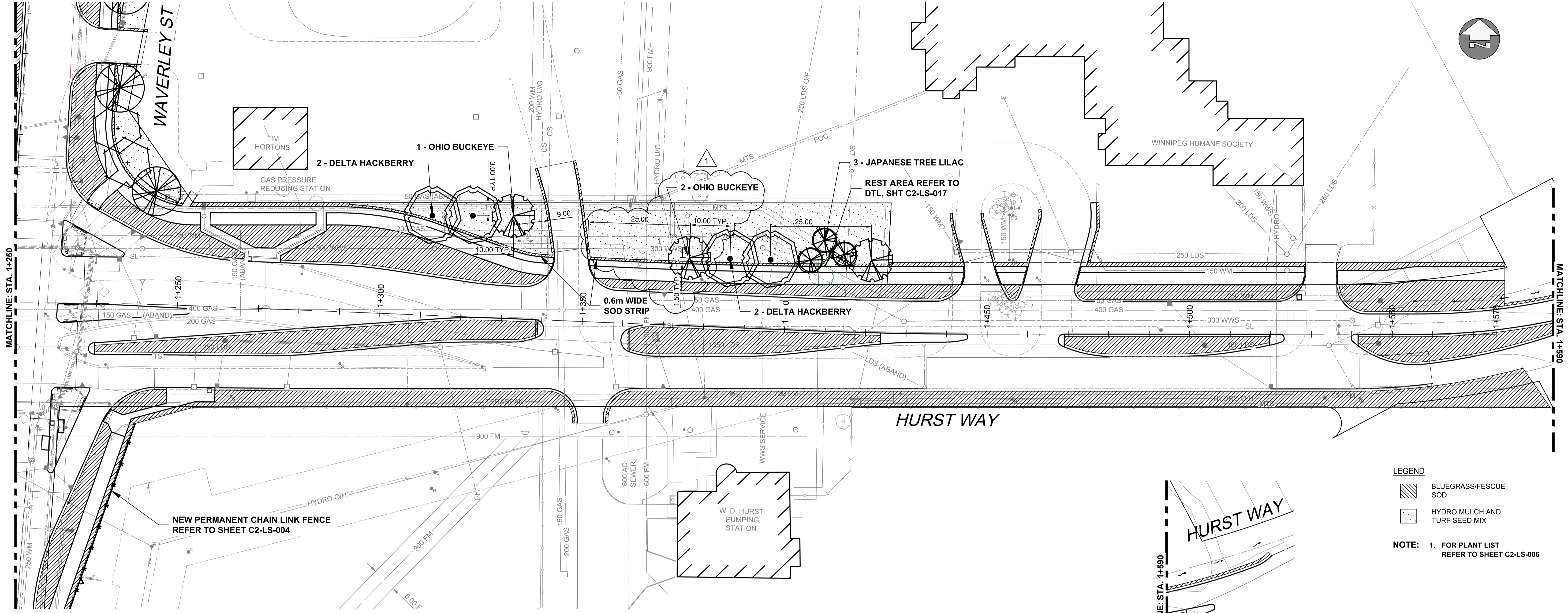

MATCHLINE: STA. 1+250

MATCHLINE: STA. 1+590

MATCHLINE: STA. 1+590

LEGEND

- BLUEGRASS/FESCUE SOD
- HYDRO MULCH AND TURF SEED MIX

NOTE: 1. FOR PLANT LIST
REFER TO SHEET C2-LS-006

NEW PERMANENT CHAIN LINK FENCE
REFER TO SHEET C2-LS-004

HURST WAY

HURST WAY

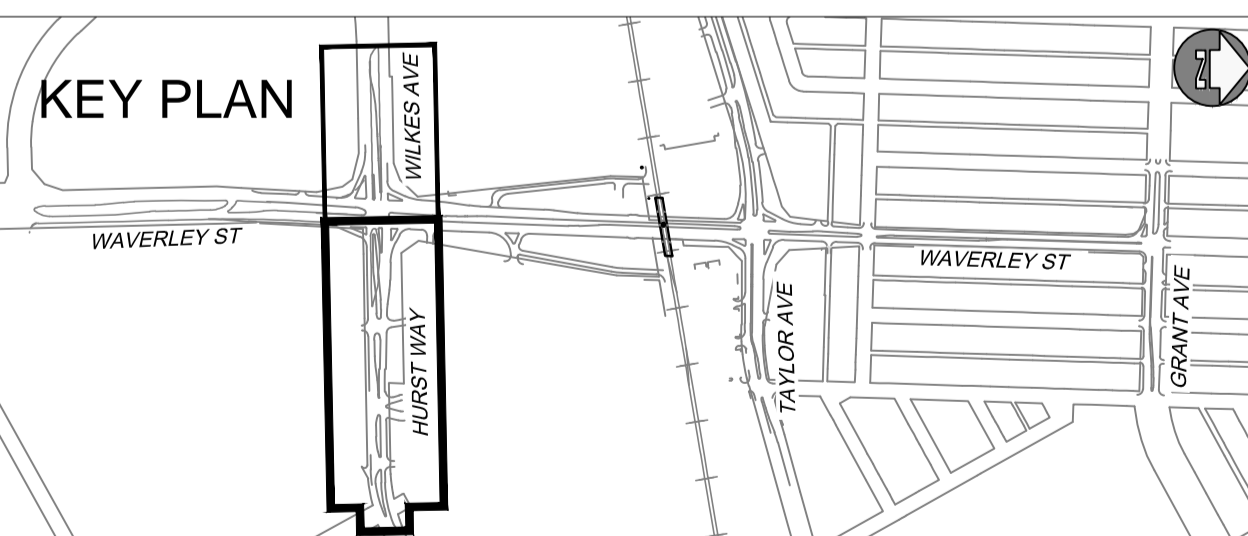

WARNING

- IF POWER EQUIPMENT OR EXPLOSIVES ARE TO BE USED FOR EXCAVATION ON THIS PROJECT THE CONTRACTOR MUST:
1. NOTIFY THE GAS COMPANY OF THE PROPOSED LOCATION OF EXCAVATION.
 2. TAKE PRECAUTION TO AVOID DAMAGE TO GAS COMPANY INSTALLATIONS SEE PROVINCIAL REGULATION 210/72 FOR DETAILS.
 3. OBTAIN EXCAVATION PERMITS PRIOR TO CONSTRUCTION.

METRIC

WHOLE NUMBERS INDICATE MILLIMETRES
DECIMALIZED NUMBERS INDICATE METRES



Certificate of Authorization

UMA Engineering Ltd. (MB)

No. 256 Date: 17/01/09

150 WM	WATERMAIN	150 WM	CONCRETE					
HYDRANT	HYDRANT	ASPHALT						
VALVE	VALVE	SIDEWALK						
MANHOLE	MANHOLE	PAVING STONES						
CATCH BASIN	CATCH BASIN	PROPERTY LINE						
CURB INLET	CURB INLET	DRAINAGE ARROW						
300 LDS	LAND DRAINAGE SEWER	CURB RAMP						
250 WWS	WASTE WATER SEWER	CULVERT						
HYDRO	HYDRO							
MTS	M.T.S.							
100 GAS	GAS							
EXISTING	LEGEND-PLAN	PROPOSED	EXISTING	LEGEND-PROFILE	PROPOSED	EXISTING	LEGEND-PROFILE	PROPOSED

UNDERGROUND STRUCTURES	
SUPV. U/G STRUCTURES	DATE
LOCATION OF UNDERGROUND STRUCTURES AS SHOWN ARE BASED ON THE BEST INFORMATION AVAILABLE BUT NO GUARANTEE IS GIVEN THAT ALL EXISTING UTILITIES ARE SHOWN OR THAT THE GIVEN LOCATIONS ARE EXACT. CONFIRMATION OF EXISTENCE AND EXACT LOCATION OF ALL SERVICES MUST BE OBTAINED FROM THE INDIVIDUAL UTILITIES BEFORE PROCEEDING WITH CONSTRUCTION.	

B.M. ELEV.			
1	ISSUED FOR ADDENDUM 4	17/02/24	LJV
0	ISSUED FOR TENDER	17/01/09	LJV
NO.	REVISIONS	DATE	BY

AECOM	
DESIGNED BY	LJV
CHECKED BY	
DRAWN BY	LJV
APPROVED BY	
HOR. SCALE	1:500
VERTICAL	NA
RELEASED FOR CONSTRUCTION	
DATE	

ENGINEER'S SEAL	
L. JOY VIBERG	member no. 125
CONSULTANT PROJECT NUMBER	60321148

THE CITY OF WINNIPEG PUBLIC WORKS DEPARTMENT	
WAVERLEY STREET UNDERPASS AT CN MILE 3.89 RIVERS SUB CONTRACT 2: UNDERPASS STRUCTURE, RAILWORKS, ROADWORKS, LAND DRAINAGE SEWER, PUMPING STATION AND LANDSCAPING WORKS	CITY DRAWING NUMBER U-239-2016-C2-LS-014
WILKES AVENUE - HURST WAY START TO STA. 1+300 TO END LANDSCAPE PLAN	SHEET 014 OF 021 CONSULTANT DRAWING NUMBER C2-LS-014

P:\60321148\900-Work\910-CAD\20-SHEETS\163353-C2-CON-LS-WILKES-HURST.dwg