

WAVERLEY STREET SOUTHBOUND

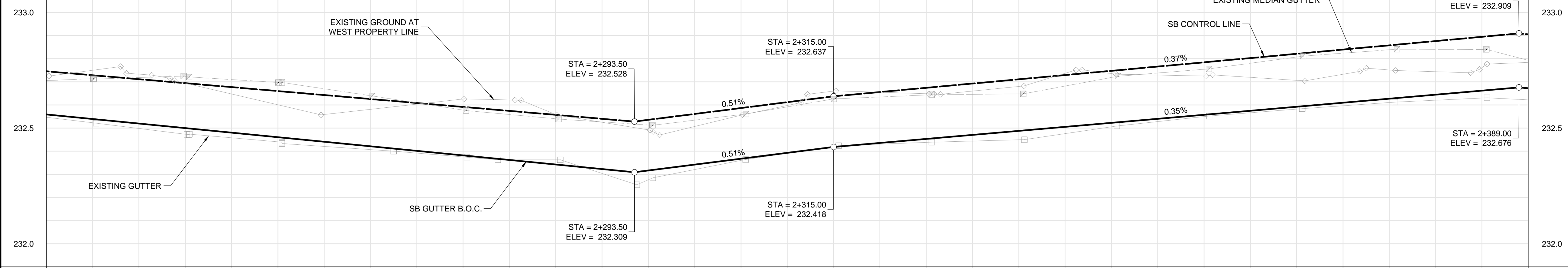

WAVERLEY STREET NORTHBOUND

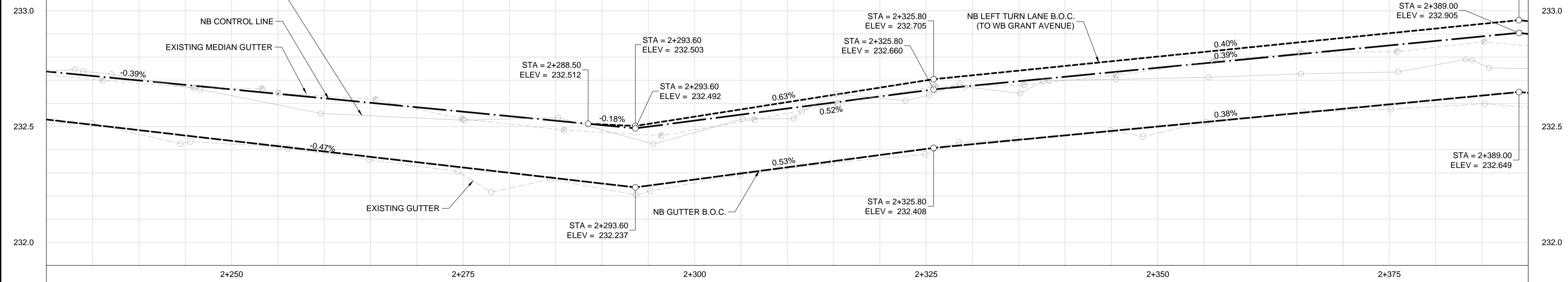

- CONSTRUCTION NOTES:**
- ISOLATE MISCELLANEOUS ITEMS IN NEW CONCRETE WORKS AS PER SD-228C.
 - LEGAL PLAN AND UNDERGROUND INFORMATION FROM CITY OF WINNIPEG L.B.I.S. CONTRACTOR VERIFY ALL UNDERGROUNDS IN THE FIELD.
 - CONTRACTOR TO TAKE PRECAUTIONARY STEPS TO AVOID DAMAGE FROM CONSTRUCTION ACTIVITIES TO TREES WITHIN THE LIMITS OF CONSTRUCTION.
 - LOCATION OF EXISTING SERVICES TO BE CONFIRMED IN THE FIELD BY THE CONTRACTOR.
 - INSTALL CB LEADS AT MIN. 1.0% SLOPE OR AS DIRECTED BY CONTRACT ADMINISTRATOR.
 - FOR CB LEADS, RIP RAP AND LDS INFORMATION SEE "CU" DRAWINGS.
 - CONTRACTOR SHALL CONFIRM EXISTING LEAD INVERT ELEVATIONS PRIOR TO INSTALLATION.

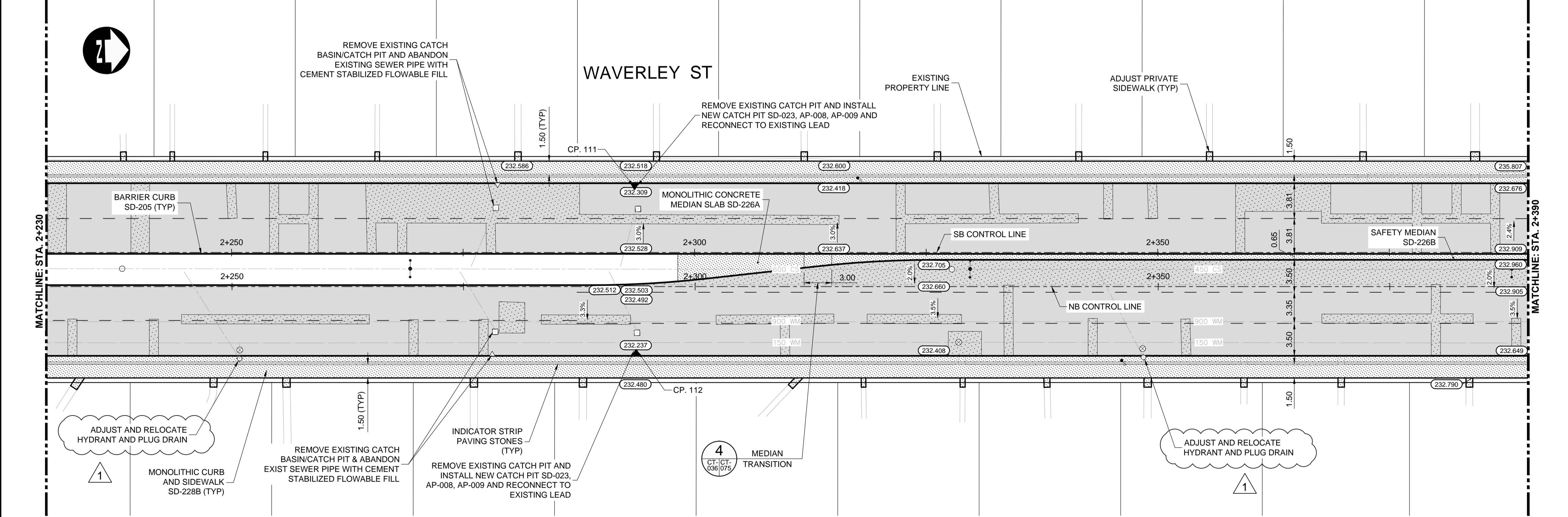

CATCH BASINS					
CB	STA	AP	RIM	BTM	INV
CP. 111	2+293	AP-008 AP-009	232.309		231.459
CP. 112	2+293	AP-008 AP-009	232.237		231.387

APEGM
Certificate of Authorization
Dillon Consulting Limited (MB)
No. 1789 Date: 17/01/09

G:\CAD\163353\Technical\Workspaces\Drawings and Figures\Roadworks\Contract\163353-C2-CON-CT-PLAN-PROFILE-WAVERLEY-NORTH.dwg

EXISTING	LEGEND-PLAN	PROPOSED	EXISTING	LEGEND-PLAN	PROPOSED	EXISTING	LEGEND-PROFILE	PROPOSED
	WATERMAIN			CONCRETE			WATERMAIN	
	HYDRANT			ASPHALT			LAND DRAINAGE SEWER	
	VALVE			PLANING			WASTE WATER SEWER	
	MANHOLE			SIDEWALK			HYDRANT	
	CATCH BASIN			PAVING STONES			VALVE	
	CURB INLET			PARTIAL DEPTH REPAIR			PROFILE	
	LAND DRAINAGE SEWER			PROPERTY LINE			NORTH/WEST GUTTER	
	WASTE WATER SEWER			DRAINAGE ARROW			SOUTH/EAST GUTTER	
	HYDRO			CURB RAMP (SD-229C)			NORTH/WEST DITCH	
	M.T.S.			DETECTABLE WARNING			SOUTH/EAST DITCH	
	GAS			SURFACE TILE (SD-229AA)				
	EXISTING			PROPOSED				

UNDERGROUND STRUCTURES

SUPPLY U/G STRUCTURES DATE

NO.	REVISIONS	DATE	BY
1	ADDENDUM #7	17/03/20	DBW
0	ISSUED FOR TENDER	17/01/09	DBW

DILLON CONSULTING

DESIGNED BY	PMW	CHECKED BY	RTP
DRAWN BY	RD	APPROVED BY	DBW
HOR. SCALE	1:250	RELEASED FOR CONSTRUCTION	
VERTICAL	1:10	DATE	

ENGINEER'S SEAL
PROVINCE OF MANITOBA
D.B. WIEBE
Member 22480
REGISTERED PROFESSIONAL ENGINEER
CONSULTANT PROJECT NUMBER
16-3353

THE CITY OF WINNIPEG
PUBLIC WORKS DEPARTMENT

WAVERLEY STREET UNDERPASS AT CN MILE 3.89 RIVERS SUB
CONTRACT 2: UNDERPASS STRUCTURES, RAILWORKS,
ROADWORKS, LAND DRAINAGE SEWER, PUMPING STATION
AND LANDSCAPING WORKS

CITY DRAWING NUMBER
U-239-2016-C2-CT-036
SHEET 036 OF 081
CONSULTANT DRAWING NUMBER
C2-CT-036