

NOTE: CHAINAGES SHOWN ARE ALONG CL OF PROPOSED PIPE

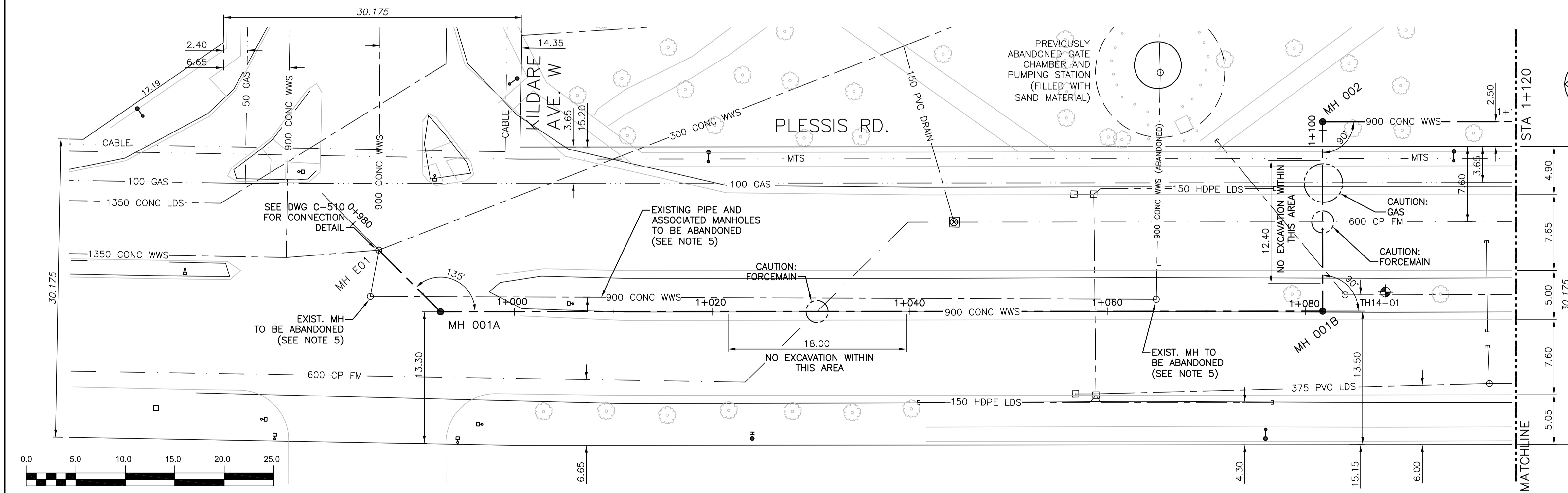

WARNING
 IF POWER EQUIPMENT OR EXPLOSIVES ARE TO BE USED FOR EXCAVATION ON THIS PROJECT THE CONTRACTOR MUST:
 1) NOTIFY THE GAS COMPANY OF THE PROPOSED LOCATION OF EXCAVATION.
 2) TAKE PRECAUTION TO AVOID DAMAGE TO GAS COMPANY INSTALLATIONS. SEE PROVINCIAL REGULATION 210/72 FOR DETAILS.

- CONSTRUCTION NOTES:**
- SEWER AND WATER SERVICES SHOWN ON DRAWING ARE APPROXIMATE ONLY.
 - LOCATION OF ALL SEWER AND WATER LINES TO BE CONFIRMED IN FIELD.
 - INSTALL NEW SEWER BY TRENCHLESS METHODS, UNLESS OTHERWISE NOTED.
 - REFER TO CONTRACT SPECIFICATION FOR TRAFFIC ACCOMMODATION STRATEGY REQUIREMENTS AT JUNCTION OF PLESSIS ROAD - KILDARE AVENUE - TRANSCONA BOULEVARD.
 - EXISTING ABANDONED MANHOLES AND 900 WWS PIPE (FROM MH 001 TO MH E01) TO BE INVESTIGATED FOR ANY LIVE CONNECTIONS AND REPORT TO BE PROVIDED TO CONTRACT ADMINISTRATOR. MANHOLES AND 900 PIPE TO BE ABANDONED AFTER INSTRUCTION FROM CONTRACT ADMINISTRATOR AS DETAILED IN SPECIFICATIONS.

1 REVISED ALIGNMENT AND PROFILE BETWEEN MH E01 AND MH 002



SEE DRAWING C-202

APEGM
 Certificate of Authorization
 CH2M HILL Canada Ltd.
 No. 1441 Date: 2016 02 11

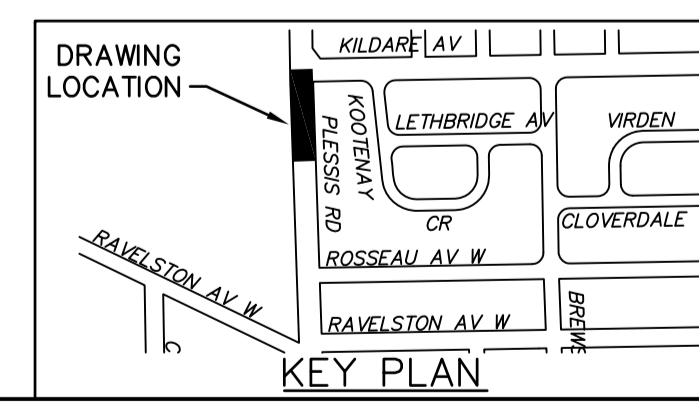

200 WM	WATERMAIN	200 WM	SL - HYDRO	150 WM	WATERMAIN	150 WM
+	HYDRANT	+	MTS	+	HYDRANT	+
o	VALVE	o	TRAFFIC SIGNALS	o	VALVE	o
525 LDS	LAND DRAINAGE SEWER	525 LDS	50 GAS	300 LDS	LAND DRAINAGE SEWER	300 LDS
375 WWS	WASTEWATER SEWER	375 WWS	50 GAS	250 WWS	WASTEWATER SEWER	250 WWS
o	MANHOLE	o	FENCE	o	C PROFILE	o
o	CATCH BASIN	o	POLE - HYDRO, MTS	o	GROUND ABOVE PIPE	o
o	CURB INLET	o	CURB STOP	o		o
o	JUNCTIONS	o	GUY ANCHOR	o		o
o	CULVERT	o	LIGHT STANDARD	o		o
o	ANODE	o	TREE	o		o
o	EXISTING	o	PROPOSED	o	EXISTING	o
o	LEGEND-PLAN	o	PROPOSED	o	LEGEND-PROFILE	o
o	PROPOSED	o	EXISTING	o	PROPOSED	o

LOCATION APPROVED UNDERGROUND STRUCTURES

DATE

NOTE: LOCATION OF UNDERGROUND STRUCTURES AS SHOWN ARE BASED ON THE BEST INFORMATION AVAILABLE BUT NO GUARANTEE IS GIVEN THAT ALL EXISTING UTILITIES ARE SHOWN OR THAT THE GIVEN LOCATIONS ARE EXACT. CONFIRMATION OF EXISTENCE AND EXACT LOCATION OF ALL SERVICES MUST BE OBTAINED FROM THE INDIVIDUAL UTILITIES BEFORE PROCEEDING WITH CONSTRUCTION.

NO.	ISSUED FOR	REVISIONS	DATE	BY
1	ISSUED FOR ADDENDUM NO. 2		02/16	JBC
0	ISSUED FOR TENDER		02/16	JBC

ch2m

DESIGNED BY: MAF
 CHECKED BY: MD
 DRAWN BY: JBC
 APPROVED BY: ES

SCALE: HORIZONTAL 1:250
 VERTICAL 1:50

DATE: 02-12-16
 DATE: 02-12-16

ENGINEER'S SEAL

ORIGINAL SIGNED BY
 S.D. GODON
 02-12-16

CONSULTANT DRAWING NUMBER
 C-201

THE CITY OF WINNIPEG
 WATER AND WASTE DEPARTMENT
 ENGINEERING DIVISION

TRANSCONA SEWER RELIEF WORKS
 CONTRACT NO. 1
 PLESSIS RD
 FROM STA 0+980 TO 1+120

SHEET 4 OF 24
 CITY DRAWING NUMBER
 LD-7745