

A1 SIZE - 594mm x 841mm

©CH2M HILL 2017. ALL RIGHTS RESERVED.

PIPE LIST 1	PIPE LIST 2	PIPE LIST 3
200-BLS-CS01 CL EL 237.250	200-BLS-CS01 CL EL 237.250	200-BLS-CS01 CL EL 237.250
200-BLS-CS01 CL EL 236.950	200-BLS-CS01 CL EL 236.950	200-BLS-CS01 CL EL 236.950
200-BLS-CS01 CL EL 236.650	200-BLS-CS01 CL EL 236.650	200-BLS-CS01 CL EL 236.650
75-FSW-SS01 CL EL 236.400	75-FSW-SS01 CL EL 236.400	75-FSW-SS01 CL EL 236.400
300-HRS-CS01 CL EL 236.400	300-HRS-CS01 CL EL 236.400	300-HRS-CS01 CL EL 236.400
75-MP-PV01 CL EL 234.983	75-MP-PV01 CL EL 234.983	75-MP-PV01 CL EL 234.975
65-SNS-CS01 CL EL 234.975	65-SNS-CS01 CL EL 234.975	65-SNS-CS01 CL EL 234.975
38-SHC-PV01 CL EL 234.850	38-SHC-PV01 CL EL 234.850	38-SHC-PV01 CL EL 234.850

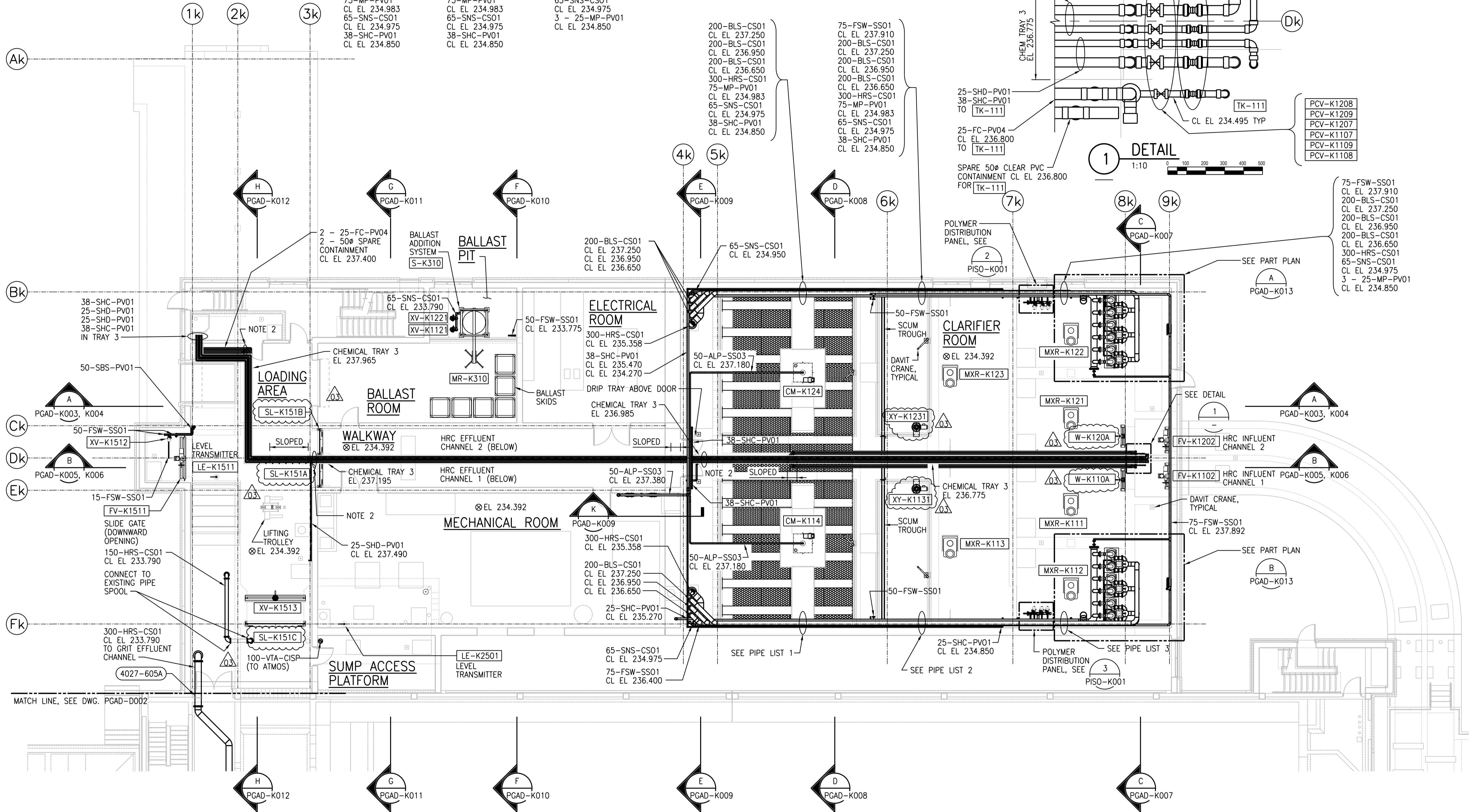
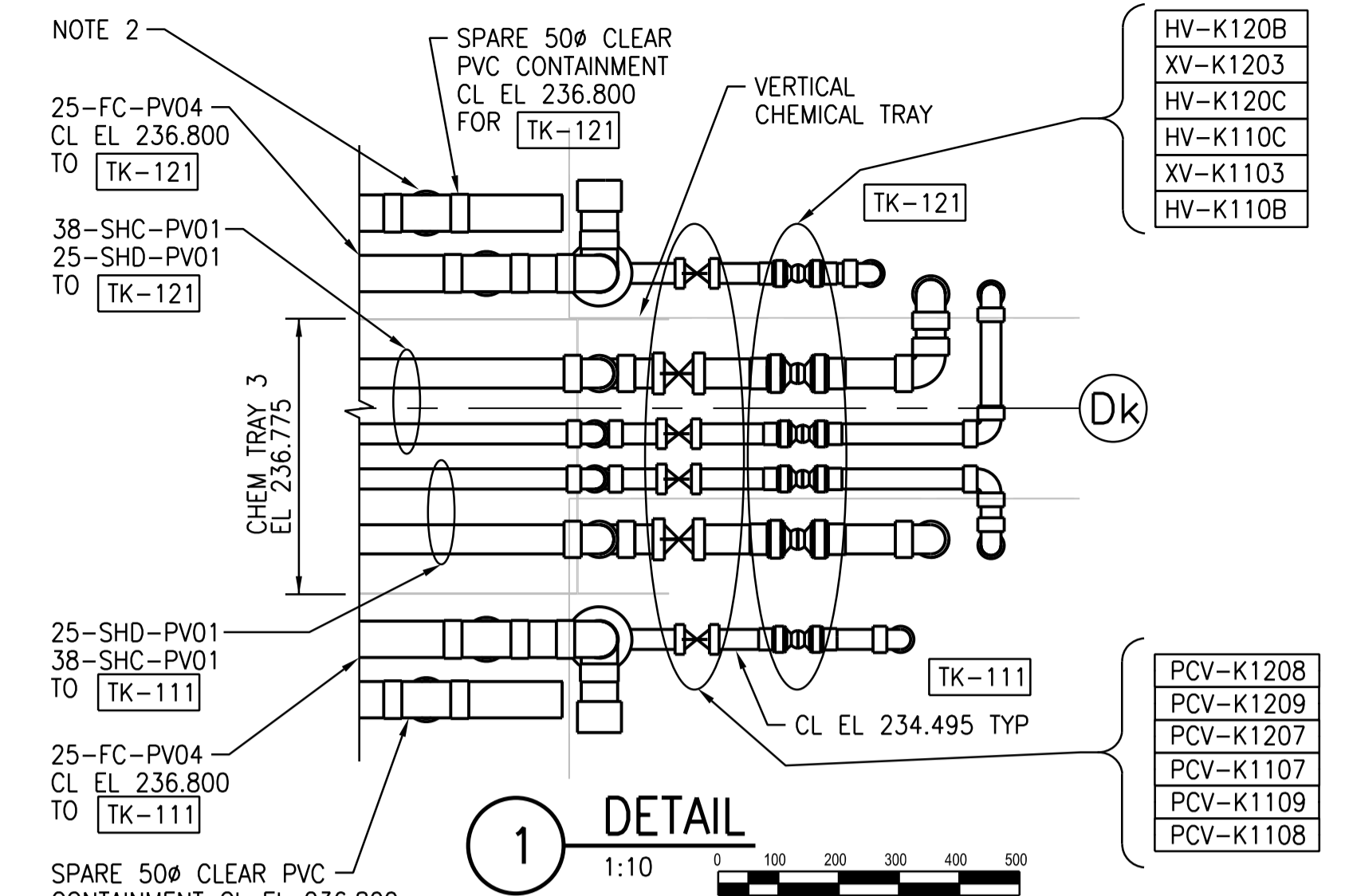

- NOTES:
- REFER TO SHOP DRAWINGS PROVIDED BY VEOLIA WATER TECHNOLOGIES CANADA INC. FOR EQUIPMENT CONFIGURATIONS AND INSTALLATION DETAILS.
 - FOR 25-FC-PV04 PROVIDE DROP LEGS OF CLEAR PVC. GANG TOGETHER CONTAINMENT PIPING REDUCE TO 12MM CLEAR PVC AND RUN TO NEAREST WALL OR VERTICAL TRAY. TERMINATE WITH A 12MM PVC BALL VALVE 500MM ABOVE THE FLOOR. REFER TO SECTION A ON DWG PGAD-C005 FOR CONCEPT.

GROUND FLOOR PLAN
1:100

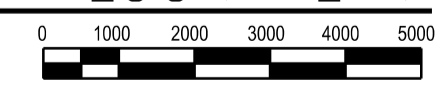

NO.	REVISIONS	DATE	DESIGN	CHECK
03	ISSUED FOR ADDENDUM 2 - 976-2016	2017/06/09	B.C.	J.C.
02	ISSUED FOR CONSTRUCTION - 976-2016	2017/04/05	B.C.	J.C.
01	ISSUED FOR CONSTRUCTION	10/2015	B.C.	J.C.
00	ISSUED FOR TENDER	08/2015	B.C.	J.C.

CH2MHILL
SNC-LAVALIN
DESIGNED BY: J. KRAEMER
DRAWN BY: B. COOPER
SCALE: 1:100
DATE: 2017/04/05
CONSULTANT NO.: 474248

ENGINEER'S SEAL
CHECKED BY: F. ABSI
APPROVED BY: H. T. FREIHAMMER
ISSUED FOR CONSTRUCTION
BY: J. SHUMKA
DATE: 2017/04/05

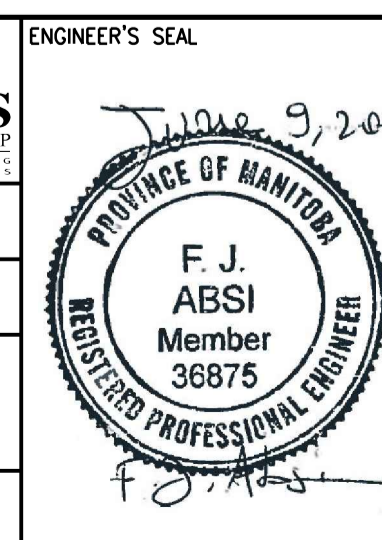

THE CITY OF WINNIPEG
WATER AND WASTE DEPARTMENT

SOUTH END WATER POLLUTION CONTROL CENTRE
SEWPPC UPGRADING/EXPANSION PROJECT
PROCESS
HIGH RATE CLARIFIER BUILDING
GROUND FLOOR PLAN

CITY DRAWING NUMBER: 1-0102-PGAD-K002
SHEET: 03
REV: A1
SIZE: A1

