

1 BASEMENT FLOOR PLAN ELEV.756'-8"
M101|101

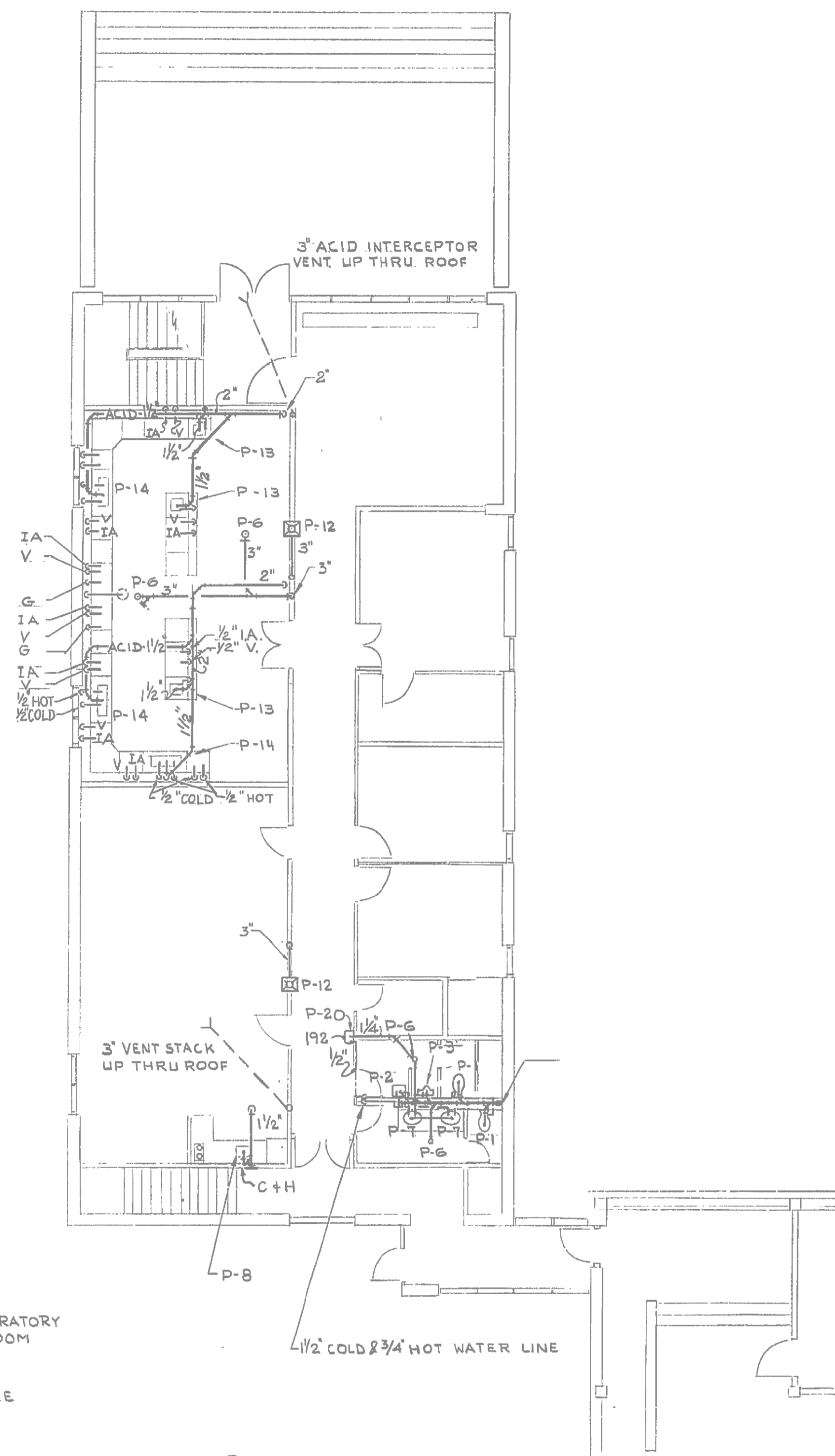

2 GROUND FLOOR PLAN ELEV.768'-8"
M101|101

- PLUMBING SYMBOLS**
- COLD WATER (POTABLE DOMESTIC)
 - HOT WATER (POTABLE DOMESTIC)
 - RECIRC. HOT WATER (POTABLE DOMESTIC)
 - S- SANITARY OR STORM LINE
 - VENT LINE
 - CLEAN OUT
 - PIPE CAPPED OFF
 - BALANCE FITTING
 - GATE VALVE
 - CHECK VALVE
 - GLOBE VALVE
 - ROOF HOPPER
 - P-1 PLUMBING FIXTURE NUMBER
 - AIR CHAMBER
 - G- GAS LINE (NATURAL)
 - ACID WASTE
 - PLUG COCK
 - SHOCK ARRESTOR
 - UNION
 - A- COMPRESSED AIR
 - F- FIRE LINE
 - W- WEeping TILE
 - FOS- FUEL OIL SUPPLY
 - FOR- FUEL OIL RETURN
 - RWL- RAIN WATER LEADER

- NOTES:**
- 1 SEE SPECIFICATION PLUMBING FIXTURE SCHEDULE FOR PLUMBING "P" NUMBER REFERENCE
 - 2 WASTE PIPING SHOWN ON BASEMENT PLAN TO BE RUN BELOW BASEMENT FLOOR SLAB. WASTE PIPING SHOWN ON GROUND FLOOR TO BE RUN AT BASEMENT CEILING
 - 3 INSULATE R.W.L. FROM ROOF HOPPER TO BASEMENT SLAB EXCEPT WHERE CONCEALED IN WALL FURRING
 - 4 INSULATE DOMESTIC HOT, COLD & RECIRCULATING POTABLE WATER LINES
 - 5 VENT ALL FIXTURES ACCORDING TO CODE
 - 6 CANVAS SEeping TILE TO BE AFTER UNIT FILTERS

PLAN AND SECTIONS
NTS

- NOTES:**
1. REMOVE ALL EXISTING LABORATORY RELATED PIPING AND CAP OFF AT MAIN AND BRANCH PIPES.
 2. REFER TO DRAWINGS 1-0102-MGAD-M501 FOR NEW WORK. REMOVE ALL EXISTING PLUMBING EQUIPMENT IN THE EXISTING LABORATORY WHICH IS NOT RELATED TO THE NEW WORK.
 3. REFER TO GENERAL DEMOLITION NOTES DRAWING 1-0102-DAAA-AD01.
 4. CONFIRMED ABESTOS CONTAINING MATERIALS IN LABORATORY FUMHOOD. REFER TO ASBESTOS ABATEMENT SPECIFICATION FOR ABATEMENT PROCEDURES.

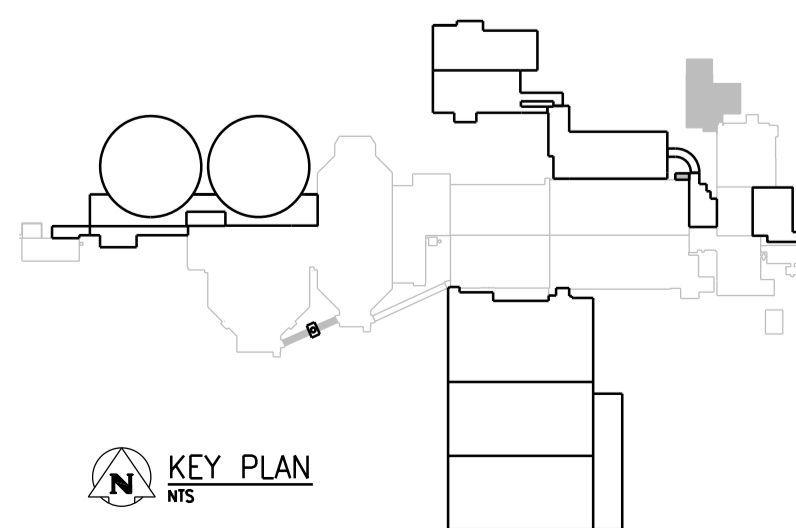

NO.	REVISIONS	DATE	DESIGN	CHECK
01	ISSUED FOR ADDENDUM 7 - 976-2016	2017/07/24	JBC	
00	ISSUED FOR CONSTRUCTION - 976-2016	2017/04/05	J.C.	J.C.

CH2MHILL		ENGINEER'S SEAL	
DESIGNED BY: T. RTAN	CHECKED BY: D. CUDDINGTON		T.T. TRAN Member 40578 REGISTERED PROFESSIONAL ENGINEER
DRAWN BY: K. FONG	APPROVED BY: H.T. FREIHAMMER		
SCALE: NTS	ISSUED FOR CONSTRUCTION BY: J. SHUMKA		
DATE: 2017/04/05	DATE: 2017/04/05		
CONSULTANT NO.: 474248			

SEALING ARCHITECT OR ENGINEER ACCEPTS RESPONSIBILITY ONLY FOR AREAS IDENTIFIED BY CLOUDING ON THIS DRAWING.

NOTE: THIS DRAWING SUPERSEDES DRAWING SEP-16

THE CITY OF WINNIPEG
Winnipeg WATER AND WASTE DEPARTMENT

SOUTH END WATER POLLUTION CONTROL CENTRE
SEWPCC UPGRADING/EXPANSION PROJECT
MECHANICAL
ADMINISTRATION BUILDING
LAB - DEMOLITION

CITY DRAWING NUMBER
1-0102-MGAD-MD50

SHEET REV. SIZE
001 01 A1