

- REFERENCE NOTES**
- PAVEMENT DIMENSIONS ARE TO BACK OF CURB
 - BASELINE IS CENTRE LINE RIGHT-OF-WAY
 - PROPERTY LINES OBTAINED FROM CITY OF WINNIPEG L.B.I.S., AND NO SCALE FACTOR WAS APPLIED
 - REFER TO AECOM FIELD BOOK NO. 4977

- CONSTRUCTION NOTES**
- PLACE NEW ASPHALTIC PAVEMENT TYPE 1A (AVG THICKNESS 85mm)
 - RENEW EXISTING BARRIER CURB (100mm REVEAL HT. DOWELED)
 - REMOVE EXISTING CONCRETE PAVEMENT AND CONSTRUCT NEW 150mm REINFORCED CONCRETE PAVEMENT *clw* ASPHALTIC OVERLAY
 - REMOVE EXISTING BARRIER CURB AND CONSTRUCT NEW CONCRETE MODIFIED BARRIER CURB (150mm REVEAL HT. DOWELED)
 - RENEW EXISTING 100mm CONCRETE SIDEWALK
 - CONSTRUCT CURB RAMP (10mm REVEAL HT. MONOLITHIC)
 - CONSTRUCT NEW CONCRETE BARRIER CURB (100mm REVEAL HT. SEPERATE)
 - ABANDON EXISTING DRAINAGE INLET AND LEAD
 - INSTALL NEW CATCHPIT (SD-023) AND CONNECT TO EXISTING CATCHBASIN
 - CONSTRUCT NEW CONCRETE MODIFIED BARRIER CURB (150mm REVEAL HT. INTEGRAL)
 - ADJUST EXISTING MANHOLE/CATCHBASIN TO GRADE
 - REMOVE EXISTING FRAME AND COVER AND INSTALL NEW FRAME AND SOLID COVER (AP-006 & AP-007)
 - INSTALL NEW CAST IRON RISER RING
 - ADJUST EXISTING WATER VALVE TO GRADE
 - PARTIAL DEPTH PLANING OF EXISTING JOINTS AND ASPHALT PATCHING OF EXISTING JOINTS USING TYPE 1A
 - INSTALL NEW DETECTABLE WARNING SURFACE TILES
 - CONSTRUCT NEW CURB RAMP (10mm REVEAL HT. INTEGRAL)
 - REMOVE EXISTING BARRIER CURB FRAME AND COVER AND INSTALL NEW BARRIER CURB FRAME AND COVER (AP-011 & AP-012)
 - REMOVE EXISTING FRAME AND COVER AND INSTALL NEW FRAME AND GRATED COVER (AP-006 & AP-008)

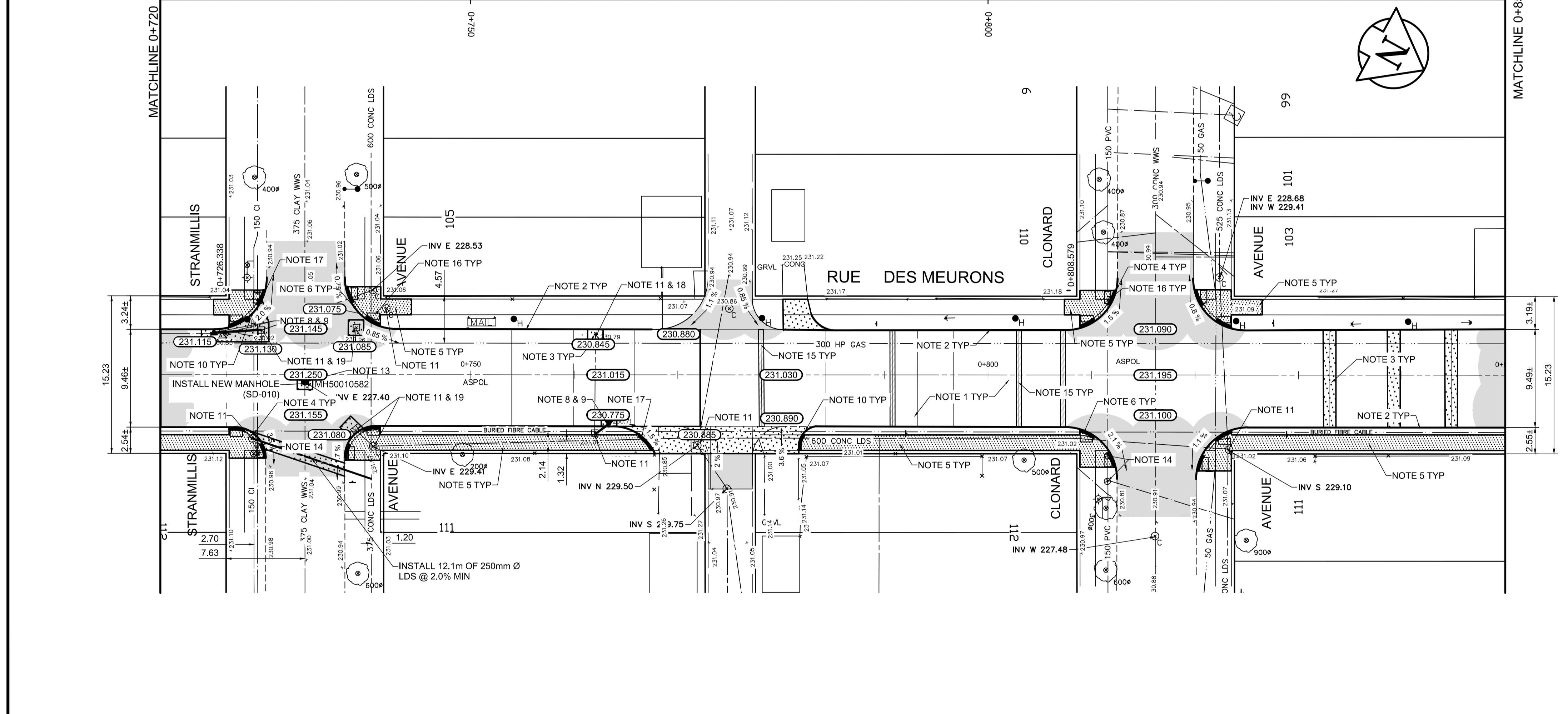

METRIC.
WHOLE NUMBERS INDICATE MILLIMETRES
DECIMALIZED NUMBERS INDICATE METRES

150 mm W.W.		300mm L.D.S.		250mm W.W.S.		HYDRO		C PROFILE	
◇	WATERMAIN	◇	LAND DRAINAGE SEWER	◇	WASTEWATER SEWER	—	M.T.S.	—	WEST GUTTER
○	VALVE	○	MANHOLE	○	CATCH BASIN	—	CONCRETE	—	EAST GUTTER
□	CATCH PIT	□	JUNCTIONS	□	CULVERT	—	ASPHALT	—	NW PROPERTY LINE
—	EXISTING	—	LEGEND - PLAN	—	PROPOSED	—	EXISTING	—	LEGEND - PROFILE
—	LEGEND - PLAN	—	PROPOSED	—	EXISTING	—	LEGEND - PLAN	—	PROPOSED

LOCATION APPROVED UNDERGROUND STRUCTURES

SUPV. U/G STRUCTURES COMMITTEE DATE

NOTE:
LOCATION OF UNDERGROUND STRUCTURES AS SHOWN ARE BASED ON THE BEST INFORMATION AVAILABLE, BUT NO GUARANTEE IS GIVEN THAT ALL EXISTING UTILITIES ARE SHOWN OR THAT THE GIVEN LOCATIONS ARE EXACT. CONFIRMATION OF EXISTENCE AND EXACT LOCATION OF ALL SERVICES MUST BE OBTAINED FROM THE INDIVIDUAL UTILITIES BEFORE PROCEEDING WITH CONSTRUCTION.

B.M. 52-054 85R410 S.W. Cor. Des Meurons & Vivian Ave., 1.8m on top of 0.05 m dia. x 2.4 m non pipe, beneath ELEV. 231.032 Valve Box, 1.8 m E. of W.L. of Rue Des Meurons & on S.L. of Vivian

DESIGNED BY	JT	CHECKED BY	TDW/BC
DRAWN BY	BC/PB	APPROVED BY	
HOR. SCALE:	1:250	RELEASED FOR CONSTRUCTION BY:	
VERTICAL:	1:10	DATE	

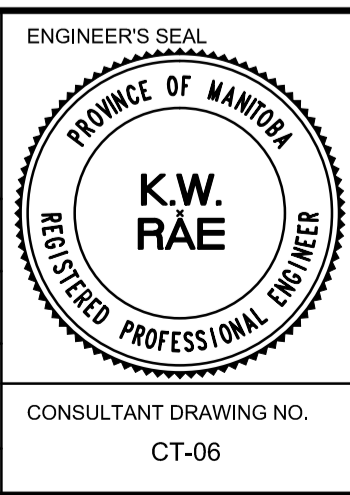

THE CITY OF WINNIPEG
PUBLIC WORKS DEPARTMENT
ENGINEERING DIVISION

2017 LOCAL STREET RENEWAL PROGRAM

RUE DES MEURONS - REGAL AVENUE / VIVIAN AVENUE
PAVEMENT REHABILITATION
STATION 0+720 TO STATION 0+850

CITY DRAWING NUMBER SHEET 06 OF 27

1	MISCELLANEOUS REVISIONS	05/15/17	BC
0	ISSUED FOR TENDER	05/10/17	BC
A	ISSUED FOR REVIEW	05/01/17	BC
NO.	REVISIONS	DATE	BY