

**PARTIAL BASEMENT HVAC DEMOLITION NOTES:**

- 1 EXISTING DUCTWORK TO BE DEMOLISHED
- 2 EXISTING DUCT TO REMAIN
- 3 AIR TIGHT SEAL DUCT OPENING
- 4 REMOVE EXISTING ABANDONED VAV BOX. REMOVE THE ABANDONED COMPRESSED CONTROL AIR TUBE AND CAP OFF COMPRESSED AIR TUBE BACK TO MAIN.
- 5 EXISTING VAV BOX TO REMAIN

**MECHANICAL SYMBOLS**

- EXISTING
- - - TO BE DEMOLISHED/RELOCATED

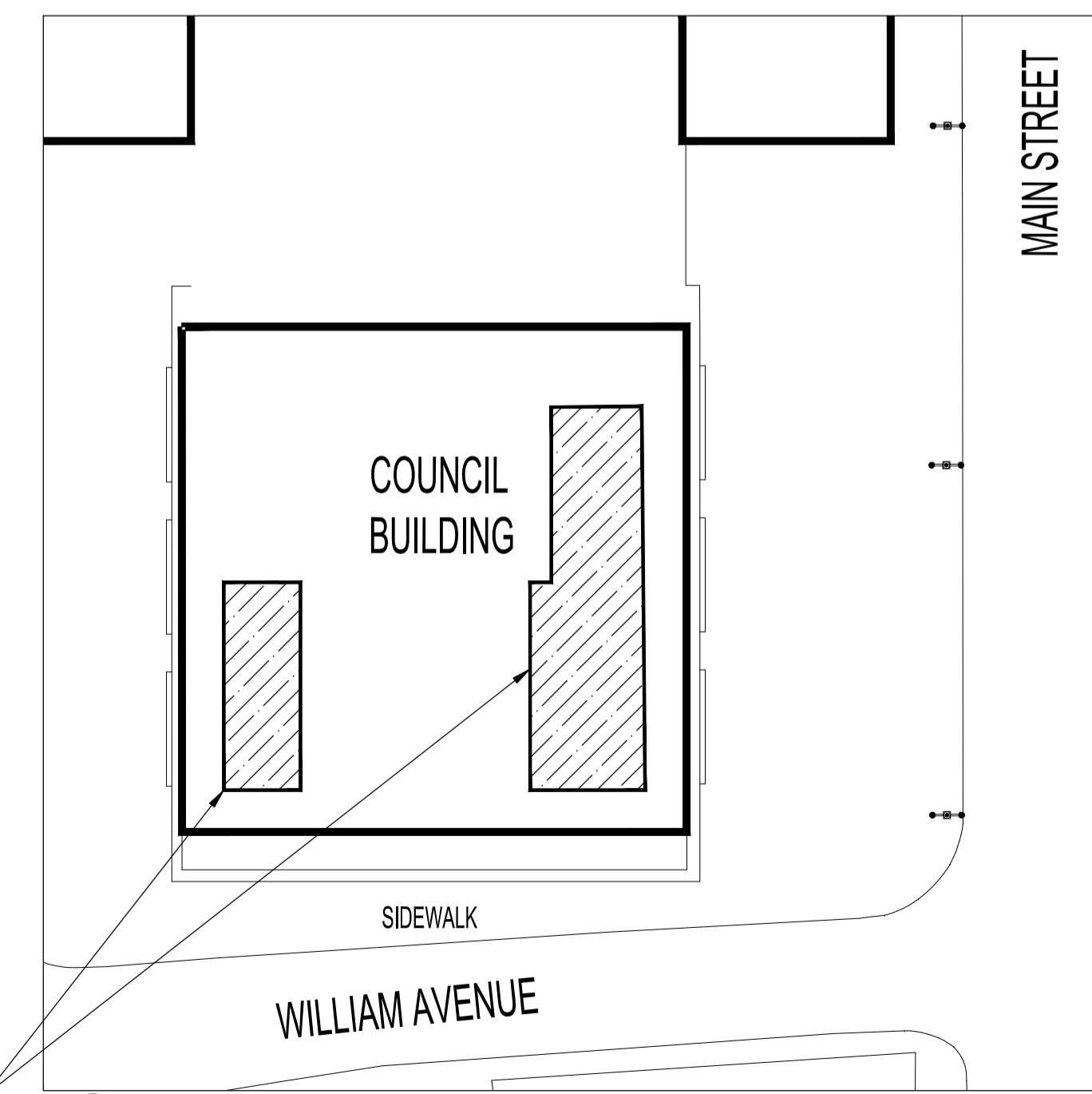

**NOTES:**

THESE DRAWINGS SHALL NOT BE SCALED.

THIS DRAWING IS DIAGRAMMATIC ONLY. CONTRACTOR TO COORDINATE EXACT LOCATIONS OF AND ROUTING ON SITE WITH ALL NEW AND EXISTING SYSTEM.

THE CONTRACTOR SHALL VISIT THE SITE AND SATISFY HIMSELF ALL DIMENSIONS, DATUM, AND DETAILED INFORMATION SHOWN ARE CORRECT.

THE CONTRACTOR IS TO REVIEW AND COORDINATE ALL ARCHITECTURAL, MECHANICAL, ELECTRICAL AND STRUCTURAL DRAWINGS FOR ADDITIONAL OPENINGS THROUGH FLOORS, WALLS, AND CEILINGS FOR DUCT, PIPE & ELECTRICAL RISERS AND ALL OPENINGS NOT SHOWN ON DRAWINGS.

ALL OPENINGS THROUGH FIRE ASSEMBLIES ARE TO BE FIRE STOPPED AND SEALED WITH ULC APPROVED FIRE STOPPING TO MAINTAIN THE INTEGRITY OF THE FIRE SEPARATION, AND PROVIDE A SMOKE-TIGHT BARRIER.

ALL PRODUCTS AND MATERIALS TO BE USED AND INSTALLED SHALL CONFORM WITH MANUFACTURER'S SPECIFICATIONS & APPLICABLE CODES.

THE CONTRACTOR SHALL BE RESPONSIBLE TO PATCH AND MAKE GOOD ALL EXISTING CONSTRUCTION AFFECTED BY THE REMOVAL OF ALL ITEMS FORMING THE PART OF THE RENOVATION WORK.

MECHANICAL DEMOLITION SHALL BE PERFORMED BY A QUALIFIED MECHANICAL SUBTRADE.

AFTER ASBESTOS REMEDIATION IS COMPLETE PROVIDE INSULATION TO CONDITIONED AIR DUCTWORK, DOMESTIC COLD WATER, HOT WATER, RECIRCULATION PIPING IN AFFECTED AREA AS PER THE FOLLOWING:

INSULATE ALL DOMESTIC WATER PIPING WITH 1/2" FIBERGLAS 7 LB. DENSITY. PIPE INSULATION WITH ASJ AS PER MFG. RECOMMENDATIONS. SEAL ALL BREAKS, JOINTS WITH ASJ TAPE.

INSULATE ALL HEATING PIPING AND ALL CHILLED WATER PIPING WITH 1" FIBERGLAS 5 1/2 LB. DENSITY PIPING INSULATION WITH ASJ AS PER MANF. RECOMMENDATIONS. SEAL ALL BREAKS, JOINTS WITH ASJ TAPE.

ALL COLD PIPING INSULATION SHALL BE C/W WITH VAPOUR BARRIER.

ACOUSTIC INSULATION ON SUPPLY DUCTWORK, WHERE SHOWN ON THE DRAWINGS, SHALL BE 1" THICK FIBREGLAS RIGID COATED DUCT LINER. THE DUCT SIZES SHOWN ON THE DRAWING REPRESENTS THE FINAL INTERNAL SIZE REQUIRED. IMPALE ON WELDED STUDS SPACED 16" O.C. PAINT BREAKS AND JOINTS WITH BF-60-30N FIRE RETARDANT MASTIC. COAT EXPOSED EDGES WITH ADHESIVE. PROJECTING FASTENERS AND ENDS CUT OFF VERTICALLY FLUSH.

INSULATION ON PIPING IN FINISHED AREAS TO BE RECANVASSED OR COVERED WITH WHITE P.V.C. INSULATION COVER.

INSULATE CONDITIONED AIR DUCTWORK WITH 1" FIBERGLAS RFFRK FLEXIBLE OR RIGID DUCT INSULATION INSTALLED IN ACCORDANCE WITH MANUFACTURER'S RECOMMENDATIONS.

No.	REVISION/DESCRIPTION	BY	DATE
2	ISSUED FOR ADDENDUM #2	JAW	MAR 15 2018
1	ISSUED FOR ADDENDUM #1	JAW	MAR 13 2018
0	ISSUED FOR CONSTRUCTION	JAW	DEC 21 2017

DRAWN	CHECKED	DESIGNED	APPROVED
JAW	XYW	XYW	XYW
DATE: 2017.12.21	USER APPROVAL		

THE CITY OF WINNIPEG  
 PLANNING, PROPERTY AND  
 DEVELOPMENT DEPARTMENT  
 MUNICIPAL ACCOMMODATIONS DIVISION  
 3-65 GARRY STREET, R3C 4K4

**PROJECT**  
 510 MAIN COUNCIL BUILDING  
 PRINT SHOP CEILING ASBESTOS  
 REMEDIATION  
 510 MAIN STREET

**SHEET TITLE**  
 PARTIAL BASEMENT FLOOR PLAN  
 MECHANICAL DEMOLITION

SCALE	PROJECT No:	SHEET No:
AS SHOWN	2017-098	M1-R2

**PARTIAL BASEMENT FLOOR PLAN - HVAC DEMOLITION**  
 SCALE: 1/8" = 1'-0"

**KEY PLAN**  
 SCALE: N.T.S.