

# Burrows Ave

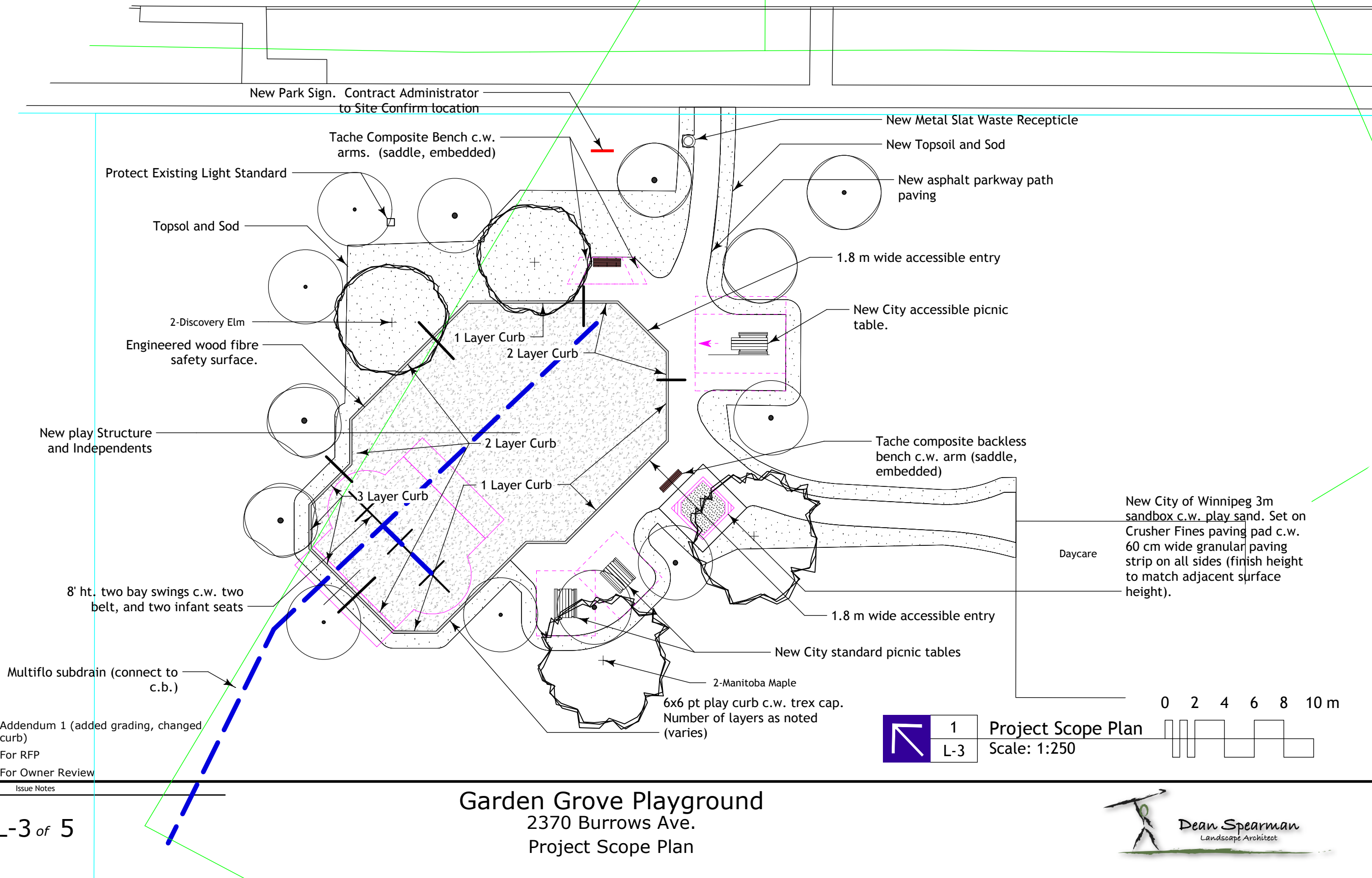

New Park Sign. Contract Administrator to Site Confirm location

Tache Composite Bench c.w. arms. (saddle, embedded)

New Metal Slat Waste Recepticle

New Topsoil and Sod

Protect Existing Light Standard

New asphalt parkway path paving

Topsoil and Sod

1.8 m wide accessible entry

2-Discovery Elm

Engineered wood fibre safety surface.

1 Layer Curb

2 Layer Curb

New City accessible picnic table.

New play Structure and Independents

2 Layer Curb

Tache composite backless bench c.w. arm (saddle, embedded)

3 Layer Curb

1 Layer Curb

New City of Winnipeg 3m sandbox c.w. play sand. Set on Crusher Fines paving pad c.w. 60 cm wide granular paving strip on all sides (finish height to match adjacent surface height).

Daycare

8' ht. two bay swings c.w. two belt, and two infant seats

1.8 m wide accessible entry

New City standard picnic tables

Multiflo subdrain (connect to c.b.)

2-Manitoba Maple

6x6 pt play curb c.w. trex cap. Number of layers as noted (varies)

No.	Date	Issue Notes
C	18-4-29	Addendum 1 (added grading, changed curb)
B	18-4-11	For RFP
A	18-4-6	For Owner Review

Drawing No.

L-3 of 5