

SOUTHBOUND

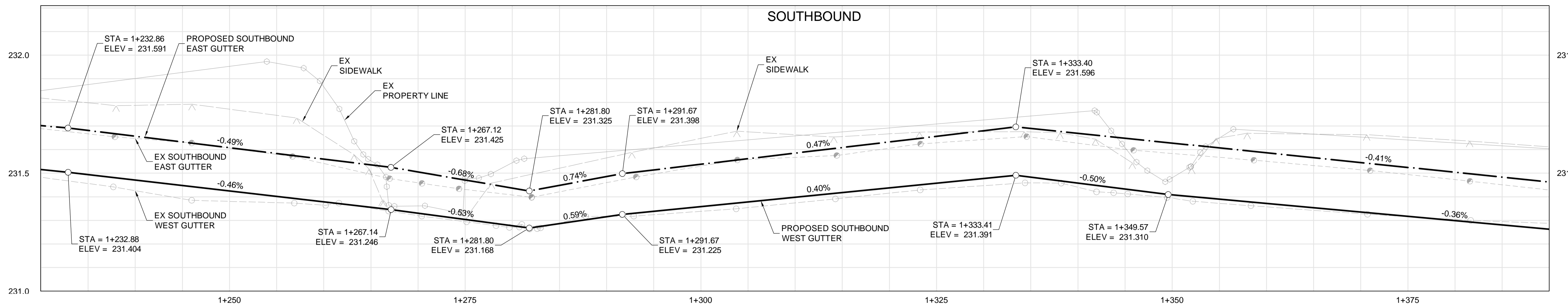

NORTHBOUND

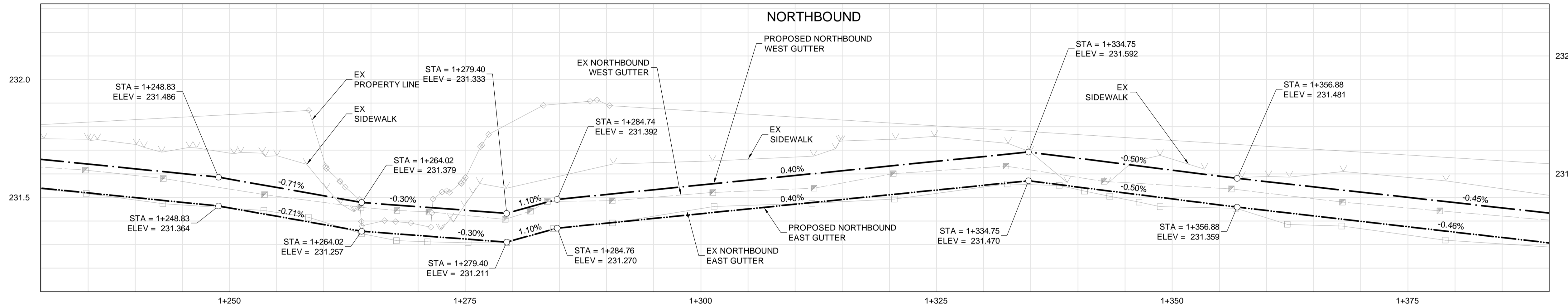

CONSTRUCTION NOTES:

- ALL WORK AND MATERIALS TO BE IN ACCORDANCE WITH LATEST REVISION OF THE CITY OF WINNIPEG STANDARD CONSTRUCTION SPECIFICATIONS.
- LEGAL PLAN AND UNDERGROUND INFORMATION FROM CITY OF WINNIPEG LBIS. CONTRACTOR TO VERIFY ALL UNDERGROUNDS IN THE FIELD.
- CONTRACTOR TO TAKE PRECAUTIONARY STEPS TO AVOID DAMAGE FROM CONSTRUCTION ACTIVITIES TO TREES WITHIN THE LIMITS OF CONSTRUCTION.
- LOCATION OF EXISTING SERVICES TO BE CONFIRMED IN THE FIELD BY THE CONTRACTOR.
- INSTALL CB LEADS AT MIN 1% SLOPE OR AS DIRECTED BY THE CONTRACT ADMINISTRATOR.

LEGEND

○	ADJUST
◻	REMOVE
◻	REMOVE BY OTHERS
◻	RELOCATE

BORE HOLE LOCATIONS

TEST HOLE ID	NORTHING	EASTING
16	5522366.691	635466.648

ABBREVIATIONS:

CONC	CONCRETE ROADWAY
ASP	ASPHALT ROADWAY
ASP OVLY	ASPHALT OVERLAY ROADWAY
GRAN	GRANULAR ROADWAY
PVS	PAVING STONE/BRICK
CSW	CONCRETE SIDEWALK
ASW	ASPHALT SIDEWALK
GSW	GRANULAR SIDEWALK
TYP	TYPICAL
EX	EXISTING
MH	MANHOLE
WV	WATER VALVE
EL	ELEVATION
CB	CATCH BASIN
CP	CATCH PIT
CI	CURB INLET
CL	CONTROL LINE

METRIC

WHOLE NUMBERS INDICATE MILLIMETRES
DECIMALIZED NUMBERS INDICATE METRES

WARNING

IF POWER EQUIPMENT OR EXPLOSIVES ARE TO BE USED FOR EXCAVATION ON THIS PROJECT THE CONTRACTOR MUST:

- NOTIFY THE GAS COMPANY OF THE PROPOSED LOCATION OF EXCAVATION.
- TAKE PRECAUTION TO AVOID DAMAGE TO GAS COMPANY INSTALLATIONS SEE PROVINCIAL REGULATION 210/72 FOR DETAILS.
- OBTAIN EXCAVATION PERMITS PRIOR TO CONSTRUCTION.

APEGM
Certificate of Authorization
Dillon Consulting Limited (MB)
No. 1789 Date: 20/12/03

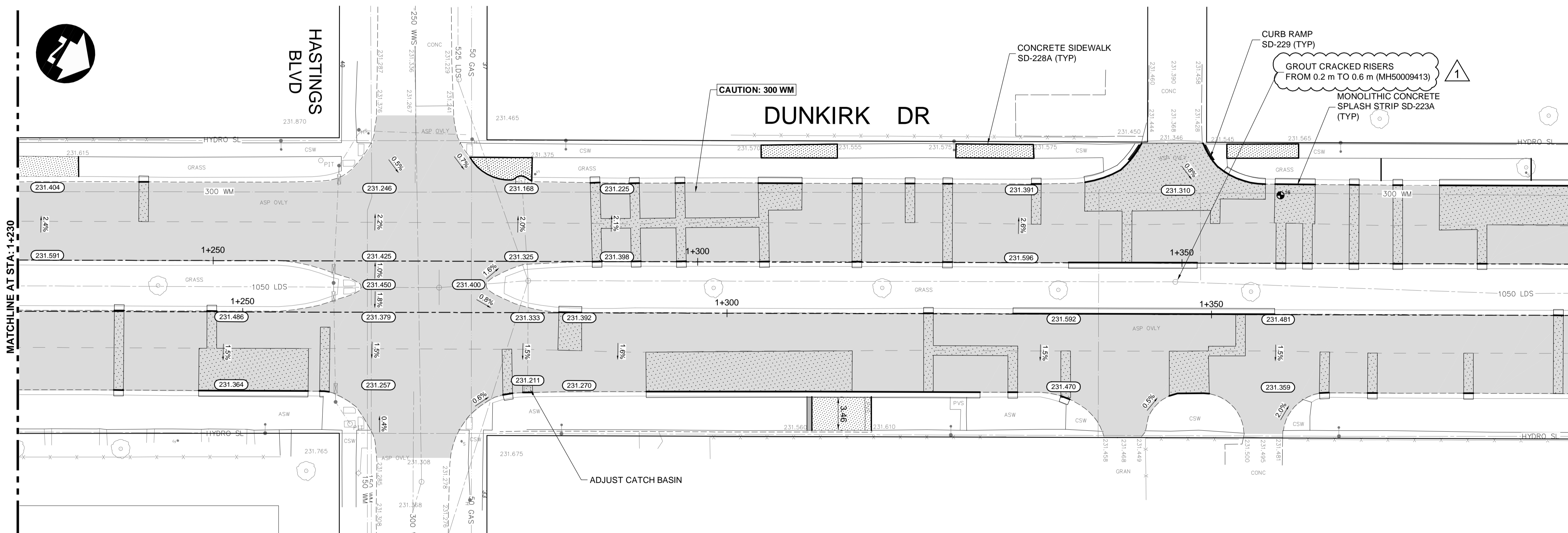

C:\pwworking\directory\projects\2020_40\p\18155\202434-DUN-CT-COON-PLAN-PROFILE.dwg

EXISTING	LEGEND-PLAN	PROPOSED	EXISTING	LEGEND-PLAN	PROPOSED	EXISTING	LEGEND-PROFILE	PROPOSED
○	HYDRANT	●	▬	CONCRETE	▬	▬	150 WM	▬
○	VALVE	●	▬	ASPHALT	▬	▬	300 LDS	▬
○	MANHOLE	●	▬	SIDEWALK	▬	▬	250 WWS	▬
○	CATCH BASIN	●	▬	PAVING STONES	▬	▬	HYDRANT	+
○	CATCH PIT	●	▬	PAVEMENT REPAIR FABRIC	▬	▬	VALVE	x
▬	150 WM	▬	▬	PROPERTY LINE	▬	▬	◊	PROFILE
▬	300 LDS	▬	▬	ELEVATION	▬	▬	○	NORTH/WEST GUTTER
▬	250 WWS	▬	▬	TRAFFIC SIGNAL	▬	▬	○	SOUTH/EAST GUTTER
▬	HYDRO	▬	▬	SURVEY BAR	▬	▬	▬	NORTH/WEST DITCH
▬	M.T.S.	▬	▬	CURB RAMP	▬	▬	▬	SOUTH/EAST DITCH
▬	100 GAS	▬	▬	DETECTABLE TILE	▬	▬	▬	

UNDERGROUND STRUCTURES
UGS APPROVED - NOVEMBER 20, 2020

NO.	REVISIONS	DATE	BY
1	ISSUED FOR ADDENDUM #2	20/12/16	DBW
0	ISSUED FOR TENDER	20/12/03	DBW

LOCATION OF UNDERGROUND STRUCTURES AS SHOWN ARE BASED ON THE BEST INFORMATION AVAILABLE, BUT NO GUARANTEE IS GIVEN THAT ALL EXISTING UTILITIES ARE SHOWN OR THAT THE GIVEN LOCATIONS ARE EXACT. CONFIRMATION OF EXISTENCE AND EXACT LOCATION OF ALL SERVICES MUST BE OBTAINED FROM THE INDIVIDUAL UTILITIES BEFORE PROCEEDING WITH CONSTRUCTION.

DESIGNED BY	RTP/PMW
DRAWN BY	PMW
CHECKED BY	TCS
APPROVED BY	DBW
HOR. SCALE	1:250
VERTICAL	1:10
RELEASED FOR CONSTRUCTION	DATE

ENGINEER'S SEAL
DILLON CONSULTING
TENDER DRAWING
NOT TO BE USED FOR CONSTRUCTION

THE CITY OF WINNIPEG
PUBLIC WORKS DEPARTMENT
2021-2023 REGIONAL PAVEMENT RENEWAL PROJECT
DUNKIRK DRIVE REHABILITATION
ST MARY'S ROAD TO FERMOR AVENUE
PLAN PROFILE (STA 1+230 TO 1+390)

CITY DRAWING NUMBER: P-3537-2021-05
SHEET 05 OF 28
CONSULTANT DRAWING NUMBER