

PLAN VIEW: UNDERGROUND CONSTRUCTION
1:250

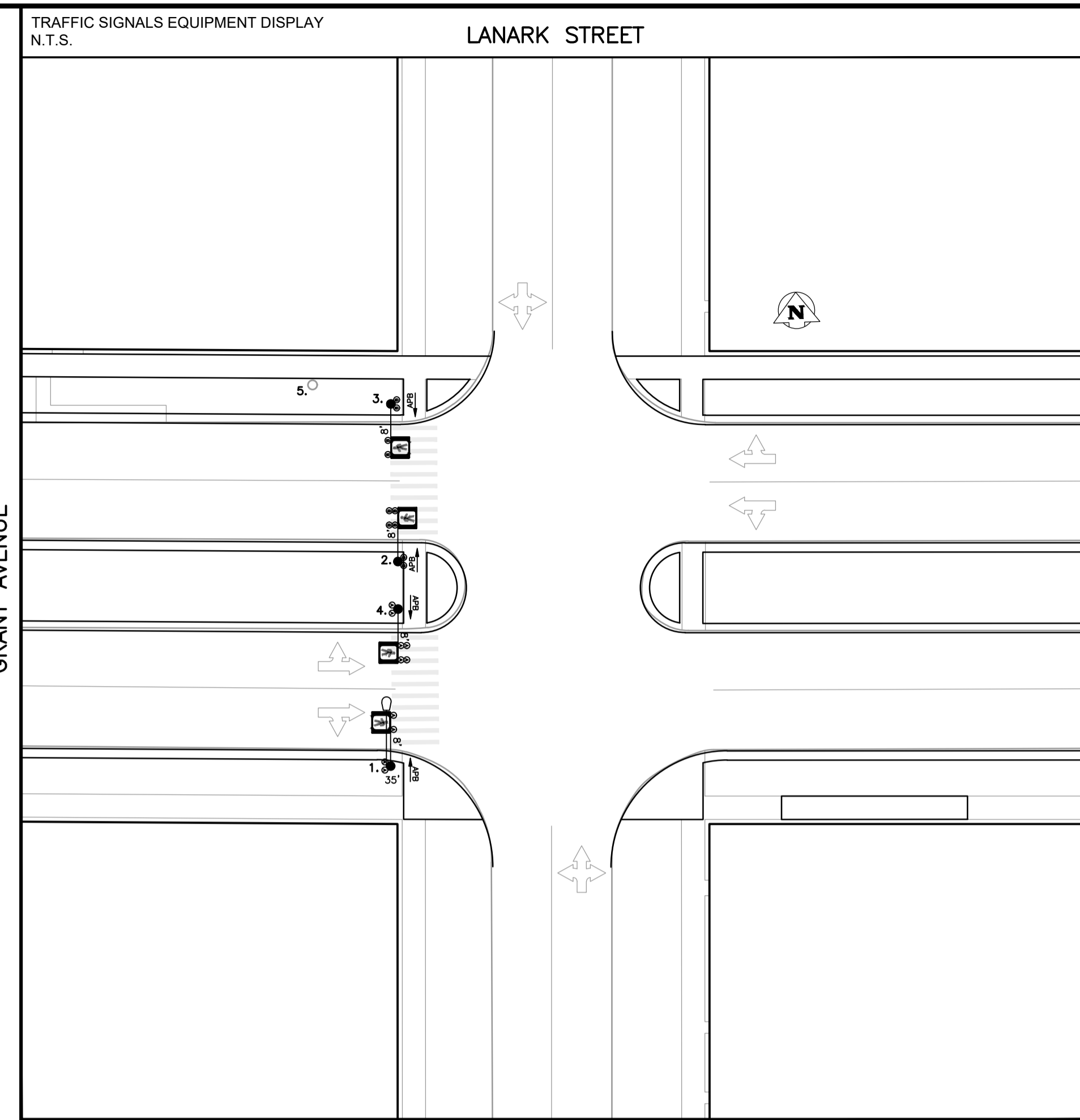

EQUIPMENT DISPLAY LEGEND

	EXISTING		PROPOSED (AS SHOWN BELOW)		TRAFFIC SIGNAL HEAD		LOW ARM (SHOWN FROM CENTRE)		HIGH ARM (SHOWN FROM SIDE)
			PB		TRAFFIC SIGNAL POLE		RED FLASHER		LUMINAIRE
	RFB (PHASE 'A' OR 'B')		APS SINGLE DIRECTION		APS DUAL DIRECTION (2 SEPARATE SPEAKERS)		AMBER FLASHER (CIRCUIT 'A' OR 'B')		CAMERA

NO.	EQUIPMENT LIST	ARM	BASE	B.B.	NO.	EQUIPMENT LIST	ARM	BASE	B.B.
1.	35' SIGNAL FOR XX WATT (XXXX LUMEN) LUMINAIRE	8'	A	AD					
2.	CANTILEVER	8'	G	GC					
3.	DAVIT	8'	A	AD					
4.	CANTILEVER	8'	OD	DC					
5.	HYDRO WOOD SERVICE:								

TRAFFIC SIGNALS UNDERGROUND LEGEND

	1 1/2" PE CONDUIT		POLE BASE		CONTROLLER BASE
	2" PE CONDUIT		PEDESTAL BASE		TERMINAL BASE
	4" PVC CONDUIT		SERVICE BOX (PIT)		24" PRECAST PIT
	AERIAL / BURIED CABLE		30" PRECAST PIT		36" PRECAST PIT
	CONDUIT STUB		SAW-CUT LOOPS		PREFORMED LOOPS
	BREAK-IN		REMOVAL		
	SPLICE				

SIGNAL BASE BOLT SQUARE TYPES

	TYPE "A" - 8 1/8"		TYPE "B" - 6 3/4"
	TYPE "C" - 8 1/8" SCREW TYPE		TYPE "D" - 12 3/4", 1 1/4" DIA. BOLTS, 24" DIA.
	TYPE "E" - 12 3/4", 1 1/4" DIA. BOLTS, 28" DIA.		TYPE "F" - 9 9/16" SCREW TYPE
	TYPE "G" - 9 9/16" SCREW TYPE		TYPE "H" - 9 7/8" SCREW TYPE
	TYPE "I" - 7 3/4"		TYPE "J" - 10 5/8", 1 1/4" DIA. BOLTS
	TYPE "K" - 10 5/8", PRECAST, 1 1/4" DIA. BOLTS		TYPE "L" - 6", 5/8" DIA. BOLTS
	TYPE "M" - 8 1/8", PRECAST, 5/8" DIA. BOLTS		

EXISTING	LEGEND	PROPOSED	EXISTING	LEGEND	PROPOSED	EXISTING	LEGEND	PROPOSED
	WATERMAIN			ROADWAY			TELEPHONE	
	VALVE			CURB & CURB RAMP			STREET LIGHT	
	MANHOLE			SLOPE			BANNER POLE	
	CATCH BASIN			BUILDING			GUY-WIRE	
	CURB INLET			TREE			FENCE	
	HYDRO			GAS			GUARDRAIL	

UNDERGROUND STRUCTURES

UNDERGROUND STRUCTURES ID _____ DATE (YYYYMMDD) _____

WATER & WASTE REVIEW ID _____

NOTE: LOCATIONS OF UNDERGROUND STRUCTURES AS SHOWN ARE BASED ON THE BEST INFORMATION AVAILABLE. BUT NO GUARANTEE IS GIVEN THAT ALL EXISTING UTILITIES ARE SHOWN OR THAT THE GIVEN LOCATIONS ARE EXACT. CONFIRMATION OF EXISTENCE AND EXACT LOCATION OF ALL SERVICES MUST BE OBTAINED FROM THE INDIVIDUAL UTILITIES BEFORE PROCEEDING WITH CONSTRUCTION.

CONSTRUCTION REVISIONS

NO.	REVISION	DATE (YYYYMMDD)	BY
A	PRELIMINARY DESIGN		

ACCOUNTS:

WT PENDING

LIABILITY DISCLAIMER NOTICE:
THE DIGITAL INFORMATION PROVIDED FOR YOUR CONVENIENCE HEREIN IS FOR USE AT YOUR OWN RISK. THE CITY OF WINNIPEG, PUBLIC WORKS DEPARTMENT, SHALL ASSUME NO RESPONSIBILITY FOR THE INFORMATION AND IT SHOULD NOT BE CONSTRUED AS ASSULT INFORMATION. THE INFORMATION SHOULD BE USED FOR PLANNING PURPOSES ONLY AND SHOULD BE VERIFIED BY SURVEY. THE DEPARTMENT SHALL NOT IN ANY WAY SUPPORT ANY LIABILITY WHATSOEVER TO ANY PARTY FOR INJURY, LOSS OR DAMAGES SUFFERED BY SUCH PARTY ARISING FROM THEIR USE OF, OR RELIANCE UPON, THIS INFORMATION.

ENGINEER'S SEAL

PRELIMINARY

NOT FOR CONSTRUCTION

THE CITY OF WINNIPEG

Winnipeg

PUBLIC WORKS DEPARTMENT

TRANSPORTATION DIVISION

PEDESTRIAN CORRIDOR

GRANT AVE. & LANARK ST.

UNITS: ALL DIMENSIONS ARE IN METERS UNLESS OTHERWISE NOTED

DRAWING NUMBER: S-1023

U:\Staff\Engineers\Transportation\Grant & Lanark_S-1023.dwg
 U:\Staff\Engineers\Transportation\Grant & Lanark_S-1023.dwg
 U:\Staff\Engineers\Transportation\Grant & Lanark_S-1023.dwg