

- Construction Specifications**
- Construction must conform to the City of Winnipeg, *Standard Construction Specifications* and all references contained herein refer to these specifications. "SD" refers to City of Winnipeg standard details.
 - All materials used for construction must conform to City of Winnipeg, *Approved Products for Underground Use Within the City of Winnipeg* except as indicated otherwise.
 - Water Service to CW-2110**
 - All water services to be saddle connection installed according to CW2110, SD-012.
 - Copper water service shall be in accordance with AWWA C600 and ASTM B88M, Type K, seamless water tubing.
 - Use Class 'B' Bedding where required according to SD-001.
 - For backfilling, refer to SD-002 as follows:
 - Class 'S' Backfill in landscaped & untraveled areas
 - Class '2' Backfill in gravel, hard-surfaced & traveled areas
 - Gravity Sewers Service to CW-2030**
 - All WWS service installation shall be in accordance with CW 2030/2130, SD-014
 - 150mm WWS service pipe shall be in accordance with CAN/CSA B182.2 and ASTM D3034, SDR-35.
 - Drain tile to be single-wall perforated pipe with sock, ADS 06730020BS or approved equal.
 - Catchpits to be Nyoplast, Light Duty Inline Drain, no sump and complete with 12" drop-in grate or approved equal.
 - All pipe installations through road right of way shall be completed with trenchless methods. Any open trench construction on site shall be as follows:
 - Class 'B' Bedding to SD-001
 - Backfill to SD-002: Class '2' in gravel, hard-surfaces, and traveled areas; Class 'S' in landscaped and untraveled areas.
 - To CW2030/2130, Detail SD-014
- General Notes**
- Contractor to obtain all necessary permits.
 - Contractor to obtain clearances from all utilities before excavating. Confirm all existing infrastructure information in field before construction. Notify the Engineer immediately of any discrepancies that affect installation or design.
 - Confirm all dimensions before beginning construction.
 - Consult Geotechnical Report (if available) or geotechnical engineer to confirm the suitability of native soils for backfill.
 - Grading by Landscape Architect.
 - Existing topographic by Landscape Architect. Refer to Landscape Architect for topographic information.

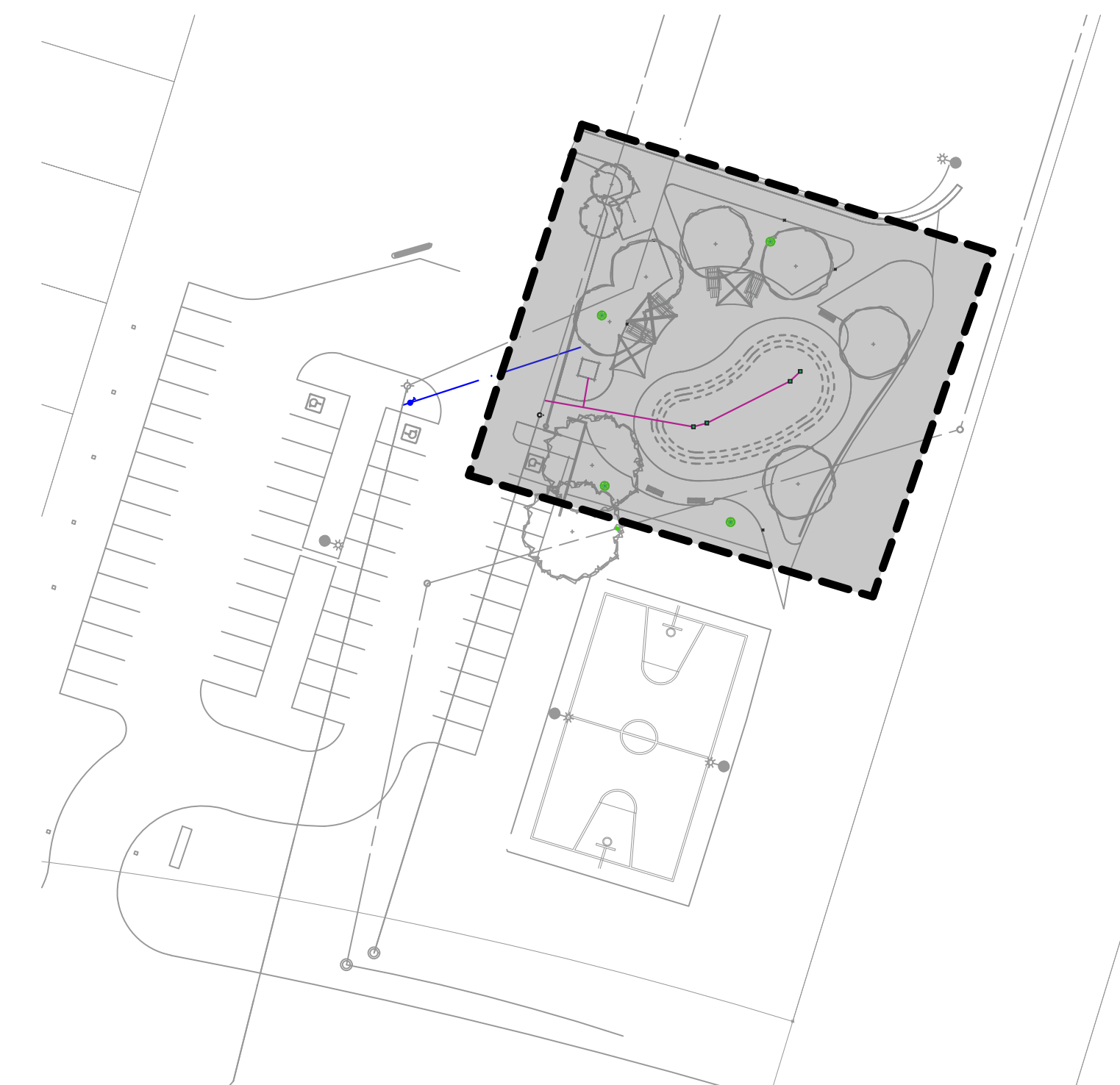

NOTE:

- Outdoor spray features shall be equipped with rain sensing devices as not to allow additional flows into the Wastewater Sewer System during rainfall events. Supplier to provide product specifications.
- Supplier to provide DWG outline of spray patterns for incorporation into Civil plan.
- Supplier to provide estimated flow generated by spray features.

PLAN SITE PLAN
N.T.S.

| EX | LEGEND | PROP |
|---------|---------------------|---------|
| | Slope Direction | 6mm |
| | Topo Grade | 100 |
| 150 W/M | Watermain | 150 W/M |
| 250 WWS | Wastewater Sewer | 250 WWS |
| 300 LDS | Land Drainage Sewer | 300 LDS |
| | Hydrant | |
| | Curb Stop | |
| | Valve | |
| | Manhole | |
| | Catch Basin | |
| | Ponding Area | |

| | | |
|----|-----------|---------------------|
| R4 | 1 APR 22 | CR1 ADDED |
| R3 | 15 MAR 22 | ISSUED FOR TENDER |
| R2 | 25 FEB 22 | ISSUED FOR PRICING |
| R1 | 07 FEB 22 | ISSUED FOR APPROVAL |
| R0 | 14 OCT 21 | PRELIMINARY |

UNITS: Whole numbers are millimetres (mm)
Decimal numbers are metres (m)
Convert Metric to Standard: 1.0m = 3.2808ft
scale

project code
21-079
As Shown