

CONSTRUCTION NOTES:

PROJECT SCOPE

1. INSTALL EQUIPMENT AS SHOWN.

PROJECT COORDINATION

1. TWO WEEKS PRIOR TO CONSTRUCTION, COORDINATE REMOVAL OF HYDRO STREET LIGHT LUMINAIRE FROM JOINT USE POLE #4 BY EMAILING WinnipegStreetLighting@hydro.mb.ca and calling (204) 360-7062 or (204) 360-7519.

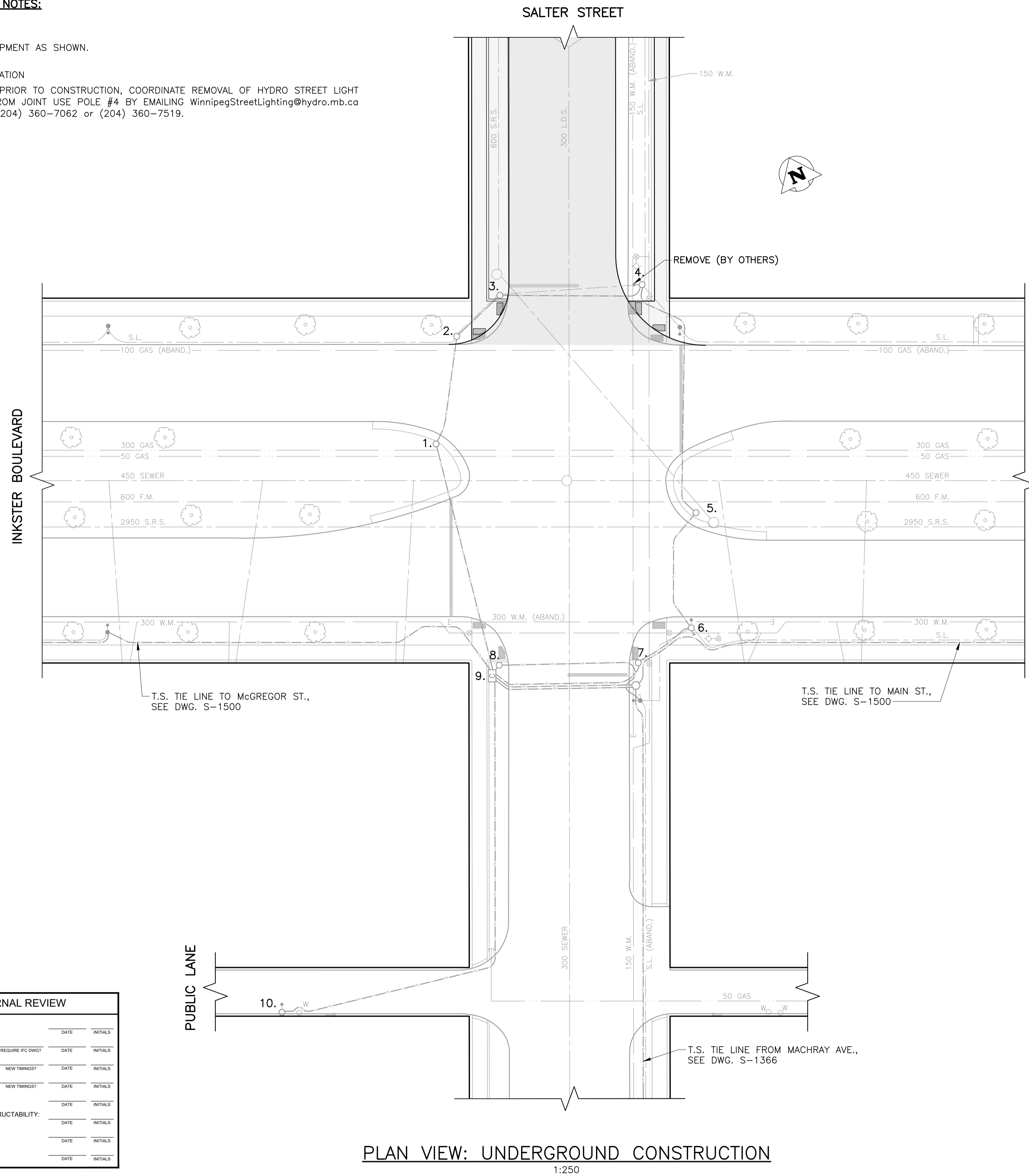

PLAN VIEW: UNDERGROUND CONSTRUCTION

1:250

INTERNAL REVIEW			
OPERATIONS:	DATE	INITIALS	
LAB:	REQUIRE (PC DWG)?	DATE	INITIALS
TIMINGS (INITIAL):	NEW TIMING?	DATE	INITIALS
TIMINGS (PRE-FC):	NEW TIMING?	DATE	INITIALS
TMC:	DATE	INITIALS	
UNDERGROUND CONSTRUCTABILITY:	DATE	INITIALS	
STREET LIGHTING:	DATE	INITIALS	
TRAFFIC MANAGEMENT:	DATE	INITIALS	

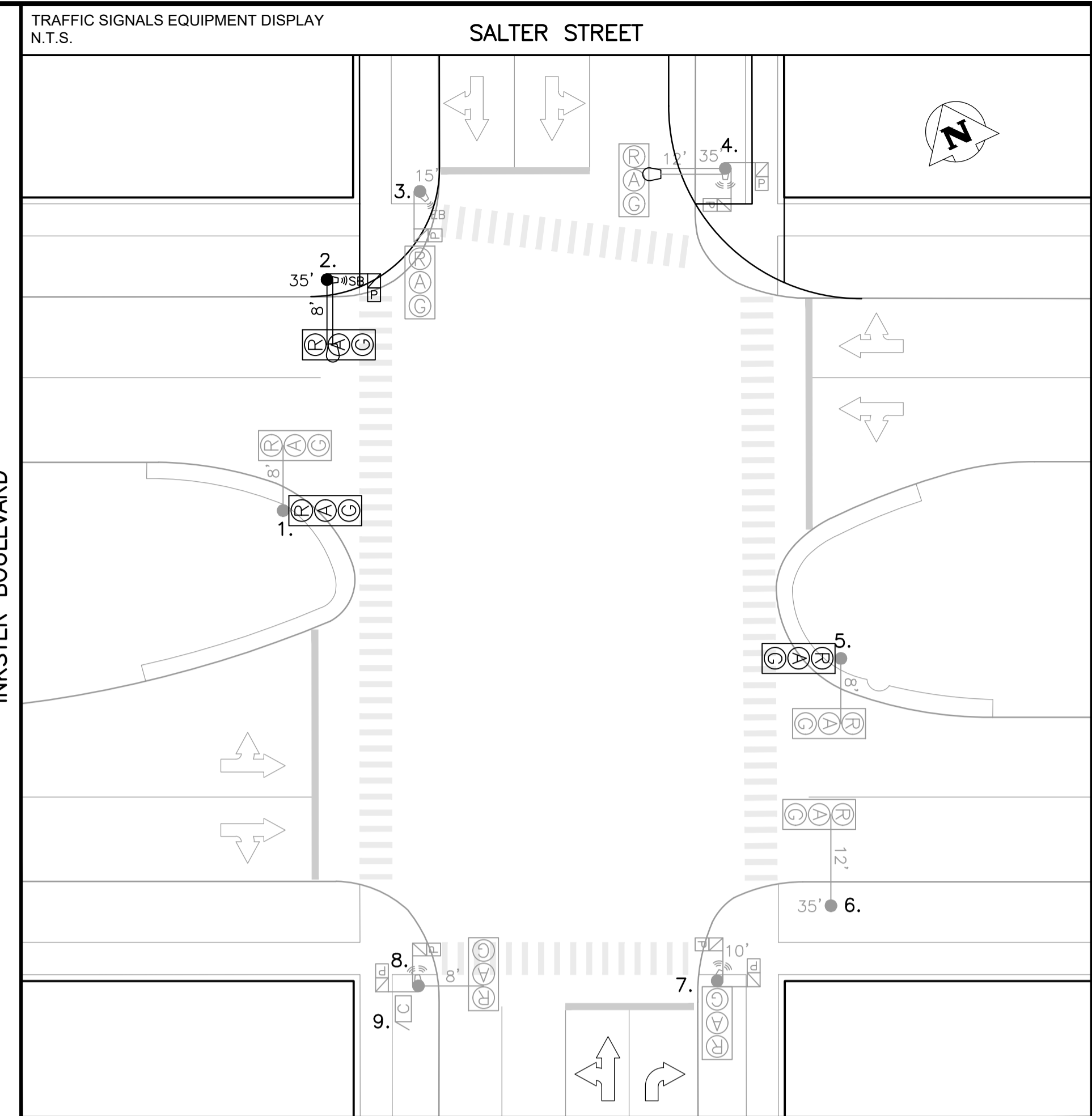

EQUIPMENT DISPLAY LEGEND

EXISTING		PROPOSED (AS SHOWN BELOW)	
	PEDESTRIAN HEAD WITH PCS		VEHICLE DETECTION AREA
	PEDESTRIAN CORRIDOR BOX (CIRCUIT 1023)		TRAFFIC SIGNAL POLE
	RRFB (PHASE 'A' OR 'B')		WOOD POST
	TRAFFIC SIGNAL HEAD		APS SINGLE DIRECTION
	TRAFFIC SIGNAL HEAD		APS DUAL DIRECTION (SEPARATE DISPLAYS)
	LOW ARM (SHOWN FROM CENTRE)		PUSH BUTTON & DIRECTION (APB = ADJUSTABLE PB)
	HIGH ARM (SHOWN FROM SIDE)		RED FLASHER
	LUMINAIRE		AMBER FLASHER
	CAMERA		ELECTRONIC DISPLAY

NO.	EQUIPMENT LIST	ARM	BASE	B.B.	NO.	EQUIPMENT LIST	ARM	BASE	B.B.
1.	DAVIT	8'	A	A	10.	HYDRO WOOD SERVICE:			
2.	35' SIGNAL FOR 150 WATT (15000 LUMEN) LUMINAIRE	8'	B	BD					
3.	15' SIGNAL		B	B					
4.	35' SIGNAL FOR 150 WATT (15000 LUMEN) LUMINAIRE	12'	I	--					
5.	DAVIT	8'	A	A					
6.	35' S.L.	12'	I	--					
7.	10' SIGNAL		A	A					
8.	DAVIT	8'	B	B					
9.	CONTROLLER 170/332								

TRAFFIC SIGNALS UNDERGROUND LEGEND

EXISTING		PROPOSED (AS SHOWN BELOW)	
	1 1/2" PE CONDUIT		POLE BASE
	2" PE CONDUIT		WOOD POST
	4" PVC CONDUIT		CONTROLLER BASE
	AERIAL / BURIED CABLE		PEDESTAL BASE
	CONDUIT STUB		TERMINAL BASE
	BREAK-IN		SERVICE BOX (PIT)
	SPICE		24" PRECAST PIT
	SAW-CUT LOOPS		30" PRECAST PIT
	PREFORMED LOOPS		36" PRECAST PIT
			REMOVAL

SIGNAL BASE BOLT SQUARE TYPES

BOLT SQUARE (B.S.)	DIA.
TYPE "A" - 8 1/8"	
TYPE "B" - 6 3/4"	
TYPE "C" - 8 1/8" SCREW TYPE	
TYPE "D" - 12 3/4", 1 1/4" DIA. BOLTS, 24" DIA.	
TYPE "OD" - 12 3/4", 1 1/4" DIA. BOLTS, 28" DIA.	
TYPE "POD" - 12 3/4", PRECAST, 1 1/4" DIA. BOLTS, 28" DIA.	
TYPE "E" - 9 9/16" SCREW TYPE	
TYPE "F" - 9 9/16"	
TYPE "G" - 8 1/8", 1 1/4" DIA. BOLTS, 89mm PROJ.	
TYPE "GS" - 8 1/8", 1 1/4" DIA. BOLTS, 76mm PROJ.	
TYPE "PG" - 8 1/8", PRECAST, 1 1/4" DIA. BOLTS	
TYPE "H" - 9 7/8" SCREW TYPE	
TYPE "I" - 7 3/4"	
TYPE "J" - 10 5/8", 1 1/4" DIA. BOLTS	
TYPE "K" - 10 5/8", PRECAST, 1 1/4" DIA. BOLTS	
TYPE "L" - 6", 5/8" DIA. BOLTS	
TYPE "PM" - 8 1/8", PRECAST, 5/8" DIA. BOLTS	

EXISTING	LEGEND	PROPOSED	EXISTING	LEGEND	PROPOSED	EXISTING	LEGEND	PROPOSED
	WATERMAIN			ROADWAY			TELEPHONE	
	HYDRANT			SIDEWALK			TELEPHONE	
	SHUTOFF VALVE			CURBS & CURB RAMP			TELEPHONE	
	SEWER			WARNING TILE			TELEPHONE	
	MANHOLE			CULVERT			TELEPHONE	
	CATCH BASIN			BUILDING			TELEPHONE	
	CURB INLET			TREE			TELEPHONE	
	HYDRO			GAS			TELEPHONE	
	100 GAS			GAS			TELEPHONE	

UNDERGROUND STRUCTURES		CONSTRUCTION REVISIONS	
N/A	UNDERGROUND STRUCTURES ID		
N/A	DATE (YYYYMMDD)		
N/A	WATER & WASTE REVIEW ID		
NOTE: LOCATIONS OF UNDERGROUND STRUCTURES AS SHOWN ARE BASED ON THE BEST INFORMATION AVAILABLE. BUT NO GUARANTEE IS GIVEN THAT ALL EXISTING UTILITIES ARE SHOWN OR THAT THE GIVEN LOCATIONS ARE EXACT. CONFIRMATION OF EXISTENCE AND EXACT LOCATION OF ALL SERVICES MUST BE OBTAINED FROM THE INDIVIDUAL UTILITIES BEFORE PROCEEDING WITH CONSTRUCTION.			

NO.	REVISION	DATE (YYYYMMDD)	BY	APPROVED BY
A	ISSUED FOR INTERNAL REVIEW	2022/12/14	A.B.	

DESIGNED BY	DRAWN BY	CHECKED BY
A.B.	A.B.	C.H.

ACCOUNTS:
ENGINEER'S SEAL:
PRELIMINARY
NOT FOR CONSTRUCTION

THE CITY OF WINNIPEG
PUBLIC WORKS DEPARTMENT
TRANSPORTATION DIVISION

TRAFFIC SIGNALS
INKSTER BLVD. & SALTER ST.

UNITS: ALL DIMENSIONS ARE IN METERS UNLESS OTHERWISE NOTED
DRAWING NUMBER: **S-1198**