

**GENERAL NOTES:**

1. THIS DRAWING IS DIAGRAMMATIC ONLY. DO NOT SCALE.
2. THE MECHANICAL SYSTEMS SHOWN ARE APPROXIMATE IN LOCATION ONLY. CONTRACTOR TO VERIFY EXACT LOCATION OF SYSTEMS BEING MODIFIED ON SITE PRIOR TO COMMENCEMENT OF WORK.
3. ALL WORK SHALL COMPLY WITH THE MOST CURRENT VERSION OF ALL APPLICABLE CODES AND STANDARDS, WHICH SHALL BE CONSIDERED PART OF THESE CONTRACT DOCUMENTS. IN THE CASE OF CONFLICTING REQUIREMENTS, THE MOST STRINGENT REGULATION SHALL PREVAIL.
4. CONTRACTOR TO MAINTAIN CURRENT AND READILY REVIEWABLE AS-BUILT DRAWINGS ACCURATELY REFLECTING SITE INSTALLATIONS.
5. CONTRACTOR TO ENSURE ALL MATERIALS MODIFIED OR INSTALLED IN AN AIR PLENUM ARE RATED FOR SUCH USE.
6. CONTRACTOR TO MAINTAIN DIGITAL PHOTOGRAPHIC RECORDS OF ALL INSTALLATIONS PRIOR TO CONCEALMENT BY SUPPORTING TRADES.
7. EXISTING MECHANICAL BEING RE-INSTALLED TO BE TURNED OVER TO INSTALLING CONTRACTOR IN GOOD CONDITION.
8. DEMOLITION CONTRACTOR TO TAPE AND SEAL OPEN ENDED DUCT AS SECTIONS OF SYSTEM ARE REMOVED.

**DRAWINGS NOTES:**

- ① CONNECT OUTDOOR AIR DUCT FROM EXISTING HRV TO RETURN DUCT OF NEW AIR HANDLING UNIT BELOW. INSULATE TO MATCH EXISTING. SEE MECHANICAL DRAWING M5.1 FOR CONTINUATION.
- ② INSTALL DUCT WITH 80 X 50MM Ø HOLE PERFORATION EVENLY SPACED ACROSS ITS LENGTH ALONG WINDOW TO DISCHARGE AT 45 DEGREES TOWARDS GLAZING. (APPROX 960 L/s).
- ③ INSTALL DUCT WITH 145 X 50MM Ø HOLE PERFORATION EVENLY SPACED ACROSS ITS LENGTH ALONG WINDOW TO DISCHARGE AT 45 DEGREES TOWARDS GLAZING. (APPROX 1740 L/s).
- ④ NEW NATURAL GAS LINE TO RISE UP TO TOP OF LOWER ROOF AND RUN SOUTH ALONG ROOF TO EXTERIOR WALL.
- ⑤ NEW NATURAL GAS LINE TO RISE UP TO ALONG WALL TO ABOVE LOWER ROOF PARAPET AND RUN ALONG EXTERIOR WALL TO BACKSIDE OF BUILDING TO CONNECT TO AHU-1.
- ⑥ RELOCATE EXISTING ROOF TOP UNIT AS INDICATED ON MECHANICAL DEMOLITION PLAN M3.0 AND INSTALL IN PLACE OF OTHER DEMOLISHED UNIT. PROVIDE AND INSTALL NEW ELECTRIC HEATING COIL IN OPTIONAL SLOT WITHIN UNIT. HEATING COIL TO BE LENNOX T1EH0225-Y 22.5 KW (PART# 14W37).
- ⑦ SUPPLY AIR DUCTWORK RUNNING ABOVE POOL TO BE UN-INSULATED. DUCTWORK IN SHAFT TO BE INSULATED AS PER MECHANICAL SPECIFICATION 23\_07\_13.
- ⑧ EXISTING OUTDOOR AIR DUCT FROM HRV-1 TO REMAIN. REPAIR INSULATION AS REQUIRED, ALLOW FOR 3000MM LENGTH OF THE 750X750 DUCTWORK TO BE COVERED.



13600

No.	Date	Issue / Revision	By
2	01/02/2024	ISSUED FOR ADDENDUM NO.4	JVL
1	29/01/2024	ISSUED FOR ADDENDUM NO.3	JVL
0	22/12/2023	ISSUED FOR CONSTRUCTION	JVL

Drawn By: EJ  
 Printing Date: 22/12/2023

Drawings and specifications, as instruments of service are the property of the architects, the copyright in the same being reserved to them. No reproduction may be made without the permission of the architects, and when made, must bear their names. All prints to be returned.

The contractor is to verify dimensions and data noted herein with conditions on the site and is held responsible for reporting any discrepancy to the architects for adjustment.



**CITY OF WINNIPEG  
 BONIVITAL POOL RENEWAL**

1215 Archibald St, Winnipeg, MB.

**ROOF -  
 MECHANICAL  
 RENOVATION LAYOUT**

Comm. No.: 2129 Sheet:  
 Potted on:

1 HIGH LEVEL & LOWER ROOF – MECHANICAL RENOVATION LAYOUT  
 M7.0 SCALE: 1:100

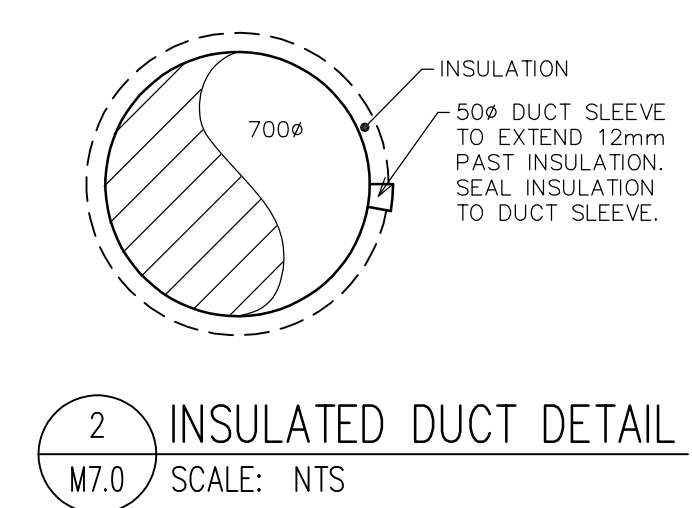

2 INSULATED DUCT DETAIL  
 M7.0 SCALE: NTS

**M7.0R1**