

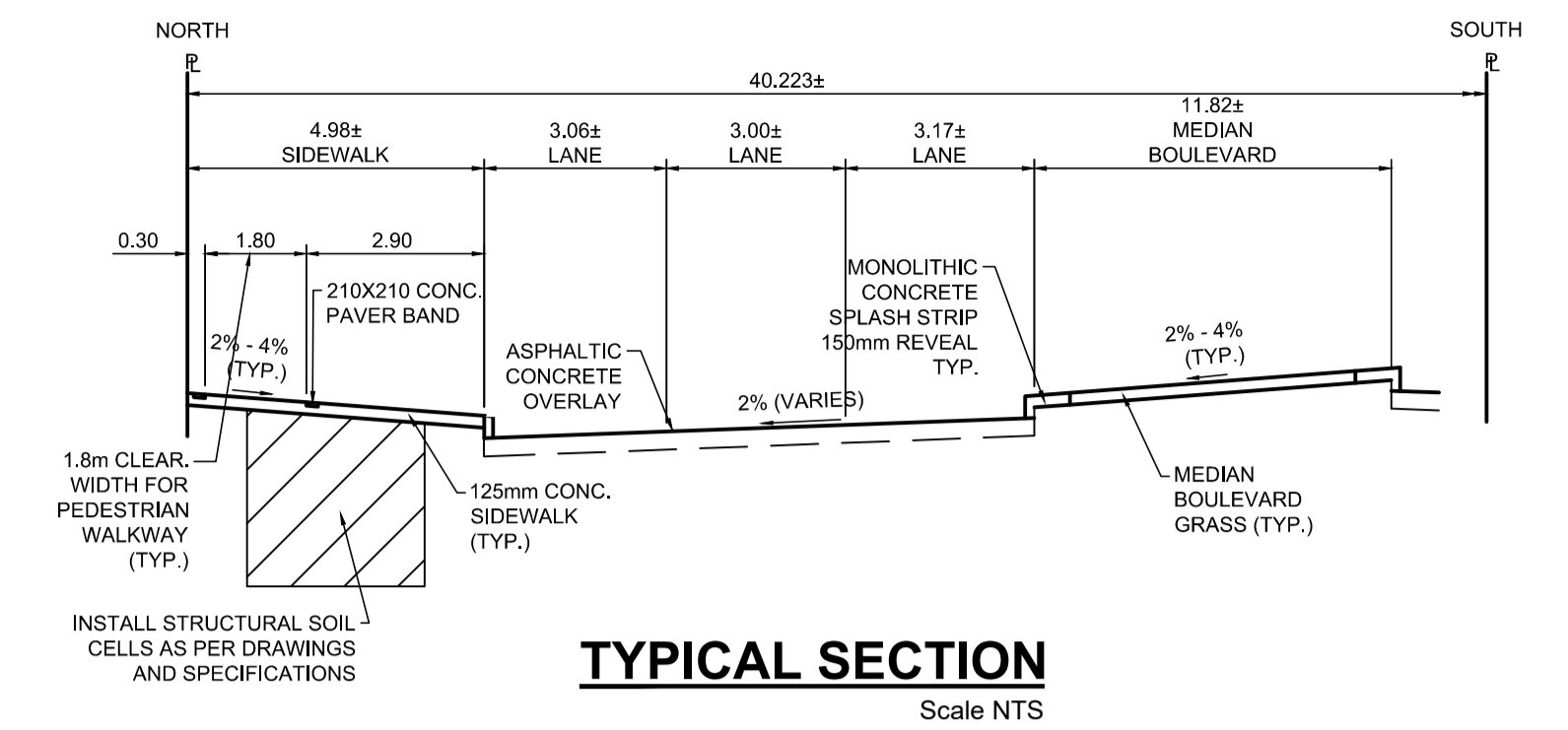

PROFILE
Scale H=1:250 V=1:10



TYPICAL SECTION
Scale NTS

ITEM	RIM ELEV.	Sta	INVERT					CONNECTION	LEAD	FLOW RESTRICTOR
			EAST	WEST	NORTH	SOUTH	V. RISER			
CB1	231.563	0+044			230.363			UNKNOWN	MANHOLE	0.7m-250@ 2% Min

REFERENCE NOTES

- A. PAVEMENT DIMENSIONS ARE TO BACK OF CURB
- B. BASELINE IS CENTRELINE OF RIGHT-OF-WAY
- C. PROPERTY LINES OBTAINED FROM THE CITY OF WINNIPEG L.B.I.S., AND SCALE FACTOR WAS NOT APPLIED
- D. REFER TO AECOM FIELD BOOK NO. 5062 - 5069, 5072
- E. CATCH BASIN CONNECTIONS TO SEWER DESIGNED TO MAINTAIN PRE-CONSTRUCTION CAPACITY BY CATCH BASIN LEAD RESTRICTION AS INDICATED ON THE DRAWINGS. ADDITIONAL OR MODIFIED CONNECTIONS TO THE SEWER SYSTEM BEYOND THOSE INDICATED ON THE DRAWINGS REQUIRE REVIEW AND WRITTEN APPROVAL BY THE CONTRACT ADMINISTRATOR

CONSTRUCTION NOTES

1. PLANE EXISTING ASPHALT AND CONSTRUCT NEW ASPHALTIC PAVEMENT OVERLAY TYPE 1A (AVERAGE THICKNESS 85mm). CONTRACT ADMINISTRATOR TO DETERMINE LOCATIONS FOR INSTALLATION OF PAVEMENT REPAIR FABRIC PRIOR TO ASPHALT PAVING.
2. REMOVE EXISTING PAVEMENT AND COMPLETE 200mm PARTIAL SLAB PATCHES AND SLAB REPLACEMENTS AS NOTED. SLAB REPLACEMENTS TO INCLUDE REINFORCEMENT.
3. REMOVE EXISTING CONCRETE SIDEWALK AND INSTALL STRUCTURAL SOIL CELLS c/w 2-2" PVC CONDUITS AND 1-2" PVC CONDUIT. (SEE CT-20 - CT-24). CONSTRUCT NEW 125mm SIDEWALK WITH BLOCKOUTS c/w PAVING STONES FOR INDICATOR SURFACE. SEE CT-20, CT-21 & CT-22 FOR SIDEWALK AND STREETSCAPING DETAILS.
4. PLACE ASPHALT PAVEMENT (TYPE 1A)
5. INSTALL NEW DETECTABLE SURFACE WARNING TILES
6. CONSTRUCT NEW BARRIER CURB (150mm REVEAL, SEPARATE)
7. CONSTRUCT NEW MONOLITHIC CURB RAMP (10mm HT. INTEGRAL)
8. CONSTRUCT NEW MODIFIED BARRIER CURB (180mm HT. INTEGRAL) AS PER SD-203B AT ALL STREET/LANE INTERSECTION RADI
9. CONSTRUCT MONOLITHIC CONCRETE BULLNOSE AS PER SD-227C
10. CONSTRUCT MONOLITHIC CONCRETE SPLASH STRIP AS PER SD-223A
11. ADJUST EXISTING CATCHBASIN / MANHOLE FRAME AND COVER
12. REMOVE EXISTING CURB INLET AND INSTALL CATCHPIT AND CONNECT TO EXISTING CATCHBASIN
13. REPLACE EXISTING CURB INLET AND CONNECT TO EXISTING CATCHBASIN (SD-024, SD-025) AND CONNECT TO EXISTING SEWER SERVICE. SHIFT CATCHBASIN TO BACK OF CURB AND ELIMINATE CURB INLET IF POSSIBLE
14. REMOVE AND REPLACE EXISTING CATCHBASIN (SD-024, SD-025), AND CONNECT TO EXISTING SEWER SERVICE. SHIFT CATCHBASIN TO BACK OF CURB
15. INSTALL CATCHPIT c/w 10m of 150mm SOLID DISTRIBUTION PIPE DRAINING INTO SILVA CELL (TYP.)
16. ADJUST EXISTING WATERMAIN VALVE BOX TO GRADE
17. ADJUST UTILITY MANHOLE FRAME, REINFORCE ISOLATION WITH 15M BARS FOR ISOLATIONS IN ROADWAYS AND 10M BARS FOR ISOLATIONS IN SIDEWALK.
18. REMOVE/STOCKPILE EXISTING BIKE RACK AND REINSTALL AFTER CONSTRUCTION
19. REMOVE/STOCKPILE EXISTING BENCH AND REINSTALL AFTER CONSTRUCTION
20. INSTALL INFRASTRUCTURE AND CONNECTION TO POWER SOURCE FOR 8x15 HEATED BUS SHELTER. POWER SOURCE TO BE INSTALLED AS PER INCLUDED SKETCHES IN TENDER APPENDIX. BUS SHELTER INSTALLED BY OTHERS
21. STREET LIGHTING TO BE REMOVED AND REPLACED IN ACCORDANCE WITH MANITOBA HYDRO DRAWING PACKAGE 1-0407-DE-50000-0453. ALL SALVAGING OR WORK ON JOINT USE POLES MUST BE COORDINATED WITH TRAFFIC SIGNALS
22. ALL TRAFFIC SIGNALS WORK TO BE COMPLETED BY OTHERS

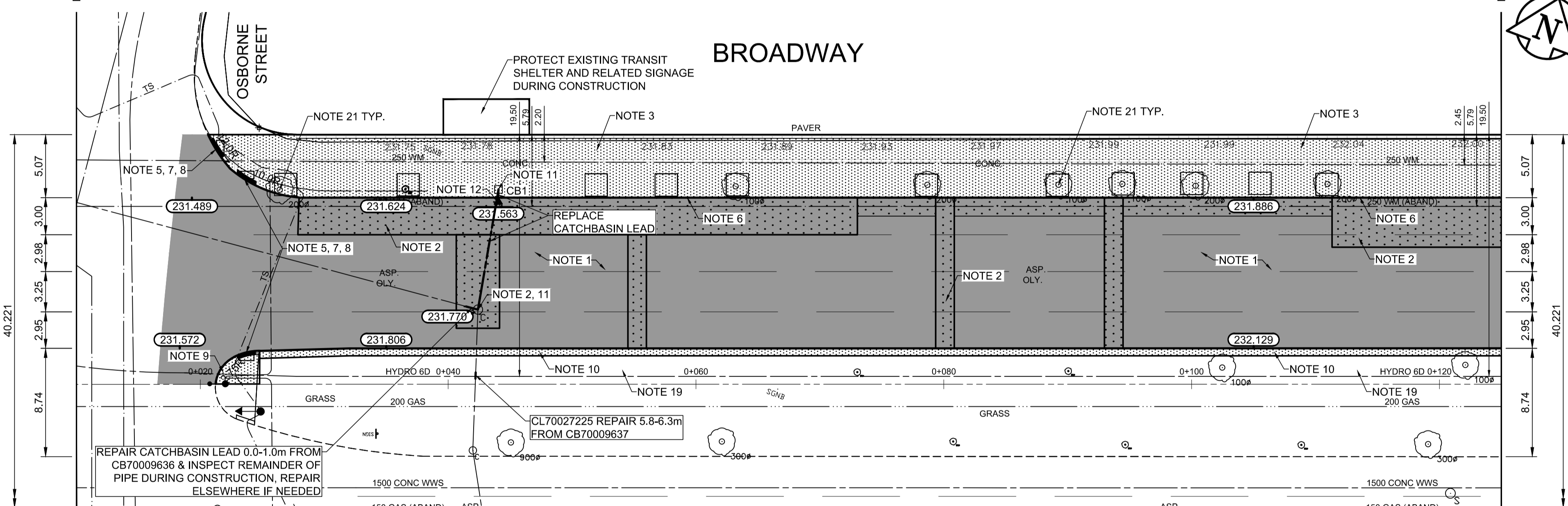

PLAN
Scale 1:250

150 mm W.M.	150 mm W.M.	HYDRO	PROPERTY LINE	PROPERTY LINE	PROPERTY LINE	PROPERTY LINE	PROPERTY LINE
HYDRANT	VALVE	M.T.S.	CONCRETE	ASPHALT	SURVEY BAR	ELEVATION	TREE
LAND DRAINAGE SEWER	WASTEWATER SEWER	CONCRETE	ASPHALT	SURVEY BAR	ELEVATION	TREE	SIDEWALK RAMP
MANHOLE	CATCH BASIN	CONCRETE	ASPHALT	SURVEY BAR	ELEVATION	TREE	CONCRETE SIDEWALK
CATCH PIT	TRAFFIC SIGNAL POLE	CONCRETE	ASPHALT	SURVEY BAR	ELEVATION	TREE	FENCE
STREET LIGHT	GAS	CONCRETE	ASPHALT	SURVEY BAR	ELEVATION	TREE	
EXISTING	LEGEND - PLAN	PROPOSED	EXISTING	LEGEND - PLAN	PROPOSED	EXISTING	LEGEND - PROFILE

LOCATION APPROVED UNDERGROUND STRUCTURES	DATE
SUPV. UG STRUCTURES COMMITTEE	

NO.	REVISIONS	DATE	BY
1	ISSUED FOR ADDENDUM	2024/01/05	TLF
0	ISSUED FOR TENDER	2023/12/15	TLF

DESIGNED BY	CHECKED BY	DRAWN BY	APPROVED BY
SF	BC	RAM	TLF

ENGINEER'S SEAL
PROVINCE OF MANITOBA REGISTERED PROFESSIONAL ENGINEER FINDLAY Member 23820 2024-01-10

ENGINEERS GEOSCIENTISTS MANITOBA
Certificate of Authorization
AECOM Canada Ltd.
No. 4671 Date: 2023/12/15

THE CITY OF WINNIPEG
PUBLIC WORKS DEPARTMENT
ENGINEERING DIVISION

DOWNTOWN PAVEMENT RENEWALS PROJECT
2024 PAVEMENT RENEWALS: WESTBOUND BROADWAY

CITY DRAWING NUMBER P-3573-10
SHEET 10 OF 28

PLAN/PROFILE GRADING PLAN
BROADWAY WESTBOUND
STATION 0+010 TO STATION 0+125



METRIC
WHOLE NUMBERS INDICATE MILLIMETRES
DECIMALIZED NUMBERS INDICATE METRES