

TYPICAL CROSS SECTION

DESCRIPTION	RIM	INVERT			
		NORTH	SOUTH	EAST	WEST
CB 17	31.760		30.16		
CB 18	31.760	30.16			

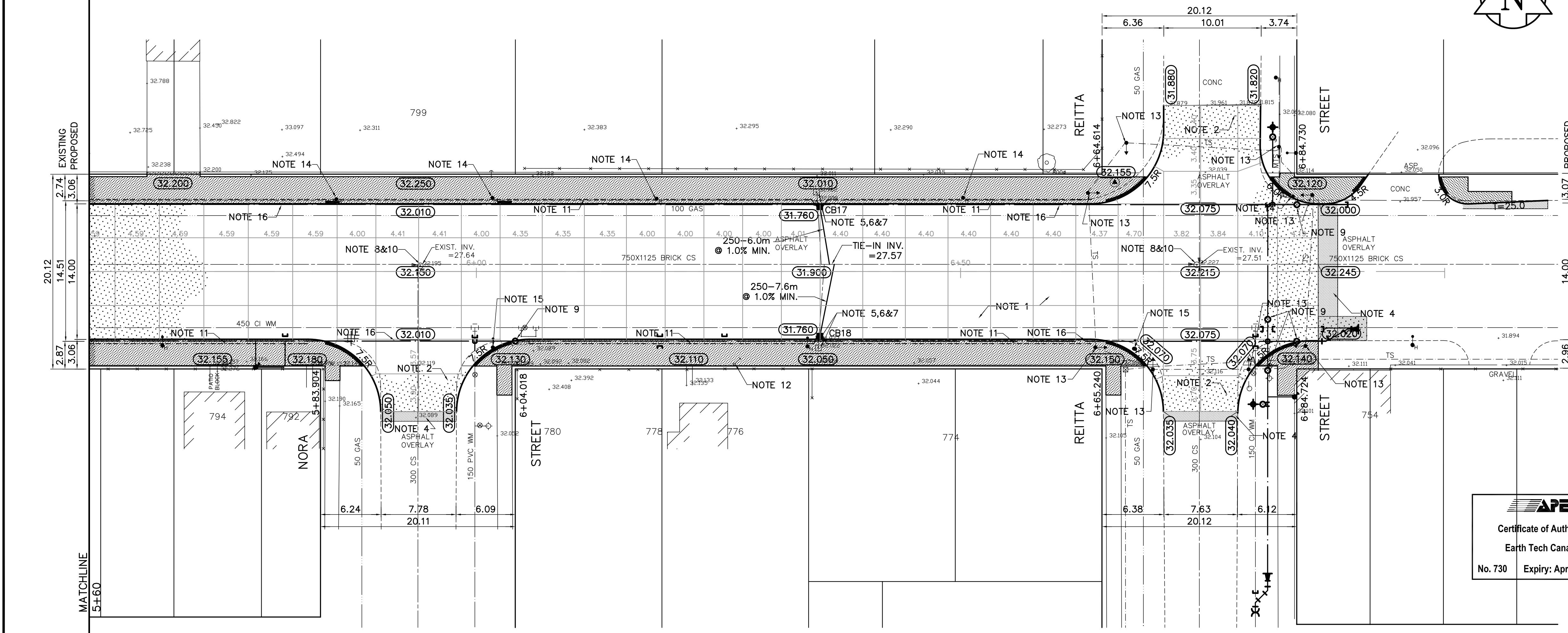
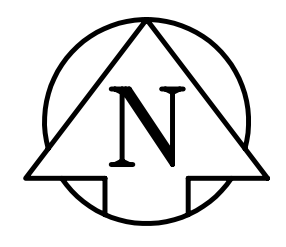

- REFERENCE NOTES**
- BASELINE IS CENTRE OF RIGHT-OF-WAY.
 - LEGAL PLAN - L.B.I.S.
 - ADD 200.000 TO OBTAIN GEODETIC DATUM (PLAN ONLY).
 - PAVEMENT DIMENSIONS ARE TO BACK OF CURB.
 - EARTH TECH FIELD BOOK NOS. 4111, 4281.

- CONSTRUCTION NOTES**
- REMOVE EXISTING PAVEMENT AND CONSTRUCT NEW 230mm PLAIN DOWELLED CONCRETE PAVEMENT.
 - CONSTRUCT NEW 200mm PLAIN DOWELLED CONCRETE PAVEMENT.
 - CONSTRUCT NEW 200mm REINFORCED CONCRETE PAVEMENT.
 - CONSTRUCT NEW 50mm ASPHALTIC CONCRETE OVERLAY.
 - INSTALL NEW CURB & GUTTER INLET c/w CATCHBASIN (SD224) AND CONNECT NEW 250 LEAD TO EXISTING 750 COMBINED SEWER.
 - ABANDON EXISTING DRAINAGE INLET.
 - ABANDON EXISTING CATCHBASIN.
 - ADJUST EXISTING CATCHBASIN/MANHOLE FRAME AND COVER.
 - ADJUST EXISTING WATERMAIN VALVE BOX TO GRADE.
 - INSTALL NEW 50mm CAST IRON RISER RING.
 - INSTALL 150mm SUBDRAIN.
 - ADJUST EXISTING CURB STOP BOX TO GRADE.
 - RELOCATE EXISTING TRAFFIC SIGNALS POLE (BY OTHERS).
 - RELOCATE EXISTING HYDRO POLE (BY OTHERS).
 - RELOCATE EXISTING MTS POLE (BY OTHERS).
 - PROPOSED WATERMAIN (BY OTHERS).

APEGM
 Certificate of Authorization
 Earth Tech Canada Inc.
 No. 730 Expiry: April 30, 2004

METRIC
 WHOLE NUMBERS INDICATE MILLIMETRES
 DECIMALIZED NUMBERS INDICATE METRES

EXISTING	LEGEND - PLAN	PROPOSED	EXISTING	LEGEND - PLAN	PROPOSED	EXISTING	LEGEND - PROFILE	PROPOSED
150 mm W.M.	WATERMAIN	150 mm W.M.	HYDRO	HYDRO	HYDRO	⊙	PROFILE	PROFILE
300 mm L.D.S.	LAND DRAINAGE SEWER	300 mm L.D.S.	CONCRETE	CONCRETE	CONCRETE	□	NORTH GUTTER	NORTH GUTTER
250 mm W.W.S.	WASTEWATER SEWER	250 mm W.W.S.	ASPHALT	ASPHALT	ASPHALT	○	SOUTH GUTTER	SOUTH GUTTER
○	MANHOLE	○	PROPERTY LINE	PROPERTY LINE	PROPERTY LINE	◇	NORTH PROPERTY LINE	NORTH PROPERTY LINE
□	CATCH BASIN	□	SURVEY BAR	SURVEY BAR	SURVEY BAR	○	SOUTH PROPERTY LINE	SOUTH PROPERTY LINE
▽	CURB INLET	▽	ELEVATION	ELEVATION	ELEVATION			
+	JUNCTIONS	+	TREE	TREE	TREE			
—	CULVERT	—	SIDEWALK RAMP	SIDEWALK RAMP	SIDEWALK RAMP			
—	GAS	—	CONCRETE SIDEWALK	CONCRETE SIDEWALK	CONCRETE SIDEWALK			
			FENCE	FENCE	FENCE			

LOCATION APPROVED UNDERGROUND STRUCTURES
 ORIGINAL SIGNED AND DATED 04/29/04
 SUPV. U/G STRUCTURES COMMITTEE

NOTE:
 LOCATION OF UNDERGROUND STRUCTURES AS SHOWN ARE BASED ON THE BEST INFORMATION AVAILABLE, BUT NO GUARANTEE IS GIVEN THAT ALL EXISTING UTILITIES ARE EXACT. CONFIRMATION OF EXISTENCE AND EXACT LOCATION OF ALL SERVICES MUST BE OBTAINED FROM THE INDIVIDUAL UTILITIES BEFORE PROCEEDING WITH CONSTRUCTION.

EARTH TECH
 Earth Tech (Canada) Inc. Winnipeg, Manitoba 204.477.5381

DESIGNED BY BK,BC,KWR
 CHECKED BY KWR,BC
 DRAWN BY BC,BK
 APPROVED BY ORIGINAL SIGNED

HOR. SCALE: 1:250
 VERTICAL: 1:10

ISSUED FOR CONSTRUCTION 04/04 KWR
 ISSUED FOR REVIEW 03/04 KWR
 NO. REVISIONS DATE BY

RELEASED FOR CONSTRUCTION BY:
 ORIGINAL SIGNED AND DATED 04/29/04

ENGINEER'S SEAL
PROVINCE OF MANITOBA
 ORIGINAL SIGNED
K.W. RAE
 Apr. 29, 2004
 REGISTERED PROFESSIONAL ENGINEER

THE CITY OF WINNIPEG
 PUBLIC WORKS DEPARTMENT
 ENGINEERING DIVISION

LOGAN AVENUE
 TRINITY STREET(RAILWAY) TO REITTA STREET
 STREET RECONSTRUCTION

PLAN/PROFILE
 STATION 5+60 TO REITTA STREET

CITY DRAWING NUMBER P-3249-07
 SHEET 7 OF 7