

PAVEMENT RECONSTRUCTION SECTION

DESCRIPTION	RIM	INVERT		
		NORTH	SOUTH	WEST
CB 1	33.000			31.500
CB 2	33.000			31.500

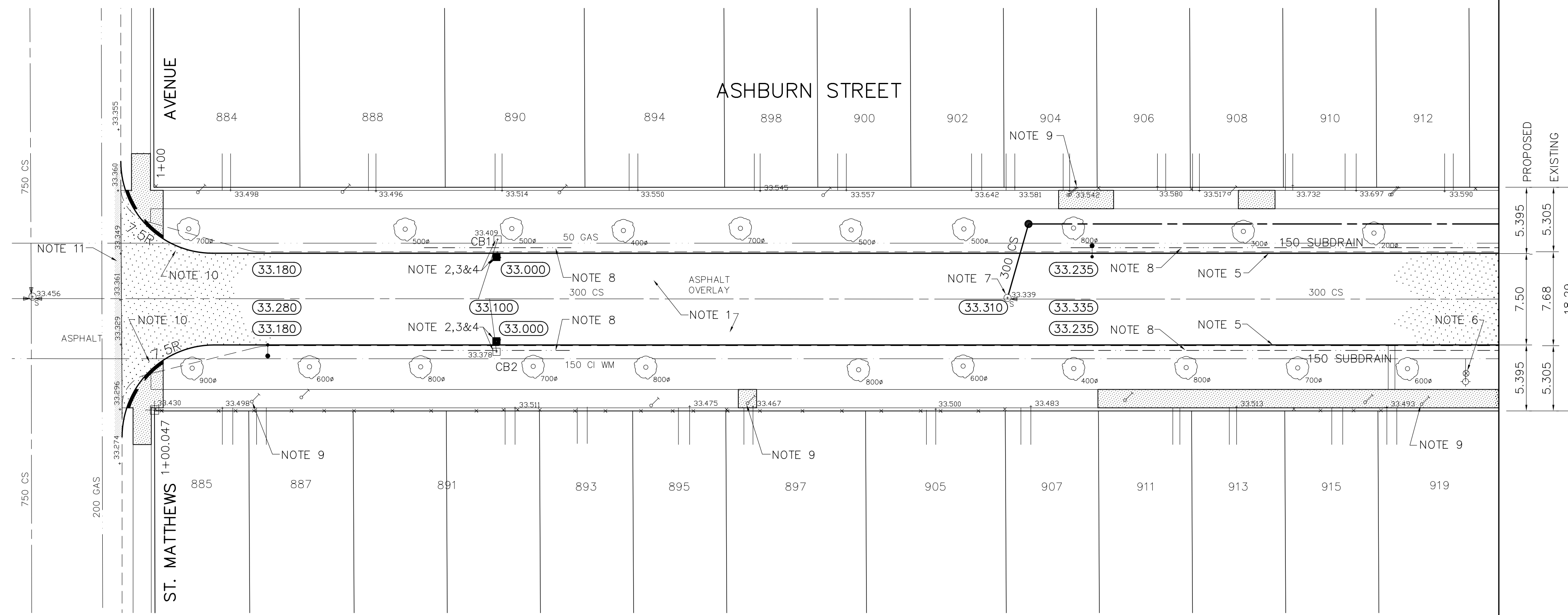

REFERENCE NOTES

- A. PAVEMENT DIMENSIONS ARE TO BACK OF CURB
- B. ADD 200.000 TO OBTAIN GEODETIC DATUM
- C. BASELINE IS CENTRE LINE RIGHT-OF-WAY
- D. PROPERTY LINES OBTAINED FROM CITY OF WINNIPEG L.B.I.S., AND NO SCALE FACTOR WAS APPLIED.
- E. REFER TO DWGS CT09 & CT10 FOR COMBINED SEWER RENEWAL WORKS

CONSTRUCTION NOTES

1. REMOVE EXISTING PAVEMENT AND CONSTRUCT NEW 150mm REINFORCED CONCRETE PAVEMENT.
2. ABANDON EXISTING INLET.
3. ABANDON EXISTING CATCHBASIN.
4. INSTALL NEW CURB AND GUTTER INLET w/ CATCHBASIN (SD224) c/w NEW 250 LEAD TO EXISTING LEAD.
5. CONSTRUCT NEW CONCRETE BARRIER CURB (SEPARATE).
6. ADJUST EXISTING WATERVALVE TO GRADE.
7. ADJUST EXISTING MANHOLE/CATCHBASIN TO GRADE.
8. INSTALL 150 SUBDRAIN.
9. ADJUST EXISTING CURBSTOPS TO GRADE AS REQUIRED.
10. CONSTRUCT 150mm HEIGHT MODIFIED BARRIER CURB (INTEGRAL).
11. REMOVE EXISTING ASPHALT AND PLACE NEW TYPE 1A ASPHALT PAVEMENT.



METRIC

WHOLE NUMBERS INDICATE MILLIMETRES
DECIMALIZED NUMBERS INDICATE METRES

150 mm W.M.	WATERMAIN	150 mm W.M.	HYDRO	150 mm W.M.	WATERMAIN	150 mm W.M.	WATERMAIN
+	HYDRANT	+	M.T.S.	+	HYDRANT	+	HYDRANT
+	VALVE	+	CONCRETE	+	VALVE	+	VALVE
---	LAND DRAINAGE SEWER	---	ASPHALT	---	LAND DRAINAGE SEWER	---	LAND DRAINAGE SEWER
---	WASTEWATER SEWER	---	PROPERTY LINE	---	WASTE WATER SEWER	---	WASTE WATER SEWER
○	MANHOLE	○	SURVEY BAR	○	PROFILE	○	PROFILE
□	CATCH BASIN	□	ELEVATION	□	N/W GUTTER	□	N/W GUTTER
▽	CURB INLET	▽	TREE	▽	S/E GUTTER	▽	S/E GUTTER
+	JUNCTIONS	+	SIDEWALK RAMP	+	N/W SIDEWALK	+	N/W SIDEWALK
---	CULVERT	---	CONCRETE SIDEWALK	---	S/E SIDEWALK	---	S/E SIDEWALK
---	GAS	---	FENCE	---		---	
---	EXISTING	---	EXISTING	---	EXISTING	---	EXISTING
---	LEGEND - PLAN	---	LEGEND - PLAN	---	LEGEND - PROFILE	---	LEGEND - PROFILE
---	PROPOSED	---	PROPOSED	---	PROPOSED	---	PROPOSED

LOCATION APPROVED UNDERGROUND STRUCTURES

SUPV. U/G STRUCTURES COMMITTEE DATE

NOTE:
LOCATION OF UNDERGROUND STRUCTURES AS SHOWN ARE BASED ON THE BEST INFORMATION AVAILABLE, BUT NO GUARANTEE IS GIVEN THAT ALL EXISTING UTILITIES ARE SHOWN OR THAT THE GIVEN LOCATIONS ARE EXACT. CONFIRMATION OF EXISTENCE AND EXACT LOCATION OF ALL SERVICES MUST BE OBTAINED FROM THE INDIVIDUAL UTILITIES BEFORE PROCEEDING WITH CONSTRUCTION.

B.M. 37-003
ELEV. 233.449
BOLT IN FILE N.E. ST. MATHEWS & STRATHCONA
0.3m N. OF N.L. ST. MATHEWS & 2.6m W. OF
E.L. STRATHCONA

NO.	REVISIONS	DATE	BY
1	ISSUED FOR CONSTRUCTION	APR 30/04	BC
A	ISSUED FOR REVIEW	MAR 30/04	BC

Earth Tech (Canada) Inc. Winnipeg, Manitoba 204.477.5381

DESIGNED BY BC CHECKED BY TGS
DRAWN BY BC APPROVED BY

HOR. SCALE: 1=250
VERTICAL: 1=10

RELEASED FOR CONSTRUCTION BY:

DATE 2003/11/20

ENGINEER'S SEAL
PROVINCE OF MANITOBA
T.G. SMITH
REGISTERED PROFESSIONAL ENGINEER
CONSULTANT DRAWING NO. CT01

THE CITY OF WINNIPEG
PUBLIC WORKS DEPARTMENT
ENGINEERING DIVISION
ASHBURN STREET
ELLICE AVENUE TO ST MATTHEWS AVENUE
PAVEMENT RECONSTRUCTION
PLAN/PROFILE
ST. MATTHEWS AVENUE TO STA. 2+10
CITY DRAWING NUMBER
SHEET 1 OF 3