

PAVEMENT RECONSTRUCTION SECTION

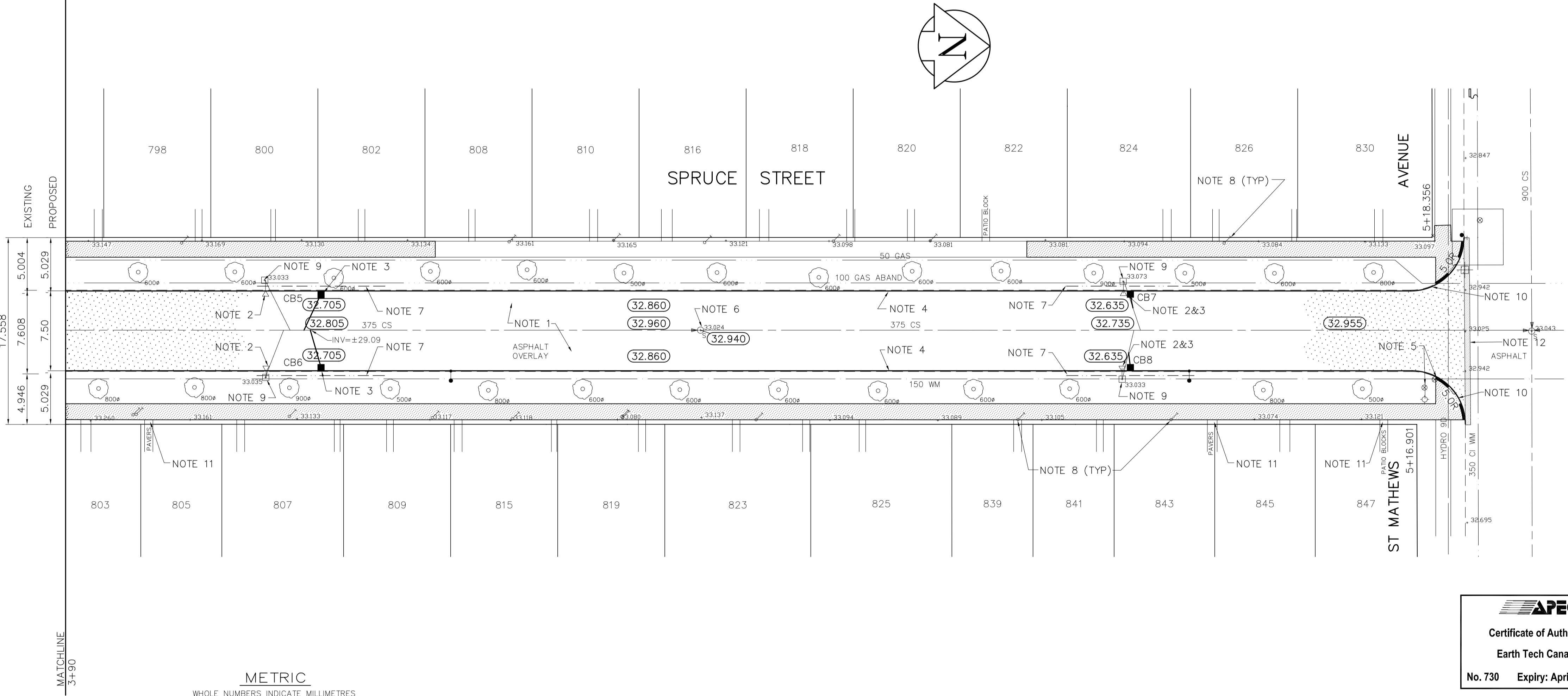

DESCRIPTION	RIM	INVERT			
		NORTH	SOUTH	EAST	WEST
CB 5	32.705			31.105	
CB 6	32.705				31.105
CB 7	32.635			31.050	
CB 8	32.635				31.050

REFERENCE NOTES

- PAVEMENT DIMENSIONS ARE TO BACK OF CURB
- ADD 200.000 TO OBTAIN GEODETIC DATUM
- BASELINE IS CENTRE LINE RIGHT-OF-WAY
- PROPERTY LINES OBTAINED FROM CITY OF WINNIPEG L.B.I.S., AND NO SCALE FACTOR WAS APPLIED.

CONSTRUCTION NOTES

- REMOVE EXISTING PAVEMENT AND CONSTRUCT NEW 150mm REINFORCED CONCRETE PAVEMENT.
- ABANDON EXISTING INLET.
- INSTALL NEW CURB AND GUTTER INLET w/ CATCHBASIN (SD224) c/w NEW 250 LEAD TO EXISTING LEAD
- CONSTRUCT NEW CONCRETE BARRIER CURB (SEPARATE).
- ADJUST EXISTING WATERVALVE TO GRADE.
- ADJUST EXISTING MANHOLE/CATCHBASIN TO GRADE.
- INSTALL 150 SUBDRAIN.
- ADJUST EXISTING CURBSTOPS TO GRADE AS REQUIRED.
- ABANDON EXISTING CATCHBASIN.
- CONSTRUCT 150mm HEIGHT MODIFIED BARRIER CURB (INTEGRAL).
- ADJUST EXISTING PATIO BLOCKS TO GRADE AS REQUIRED
- REMOVE EXISTING ASPHALT AND PLACE NEW TYPE 1A ASPHALT PAVEMENT.

APEGM
 Certificate of Authorization
 Earth Tech Canada Inc.
 No. 730 Expiry: April 30, 2004

METRIC
 WHOLE NUMBERS INDICATE MILLIMETRES
 DECIMALIZED NUMBERS INDICATE METRES

EXISTING	LEGEND - PLAN	PROPOSED	EXISTING	LEGEND - PLAN	PROPOSED	EXISTING	LEGEND - PROFILE	PROPOSED
150 mm W.W.	WATERMAIN	150 mm W.W.	HYDRO	CONCRETE	150 mm W.W.	WATERMAIN	WATERMAIN	150 mm W.W.
300mm L.D.S.	LAND DRAINAGE SEWER	300mm L.D.S.	M.T.S.	ASPHALT	300mm L.D.S.	HYDRANT	HYDRANT	300mm L.D.S.
250mm W.W.S.	WASTEWATER SEWER	250mm W.W.S.	PROPERTY LINE	PROPERTY LINE	250mm W.W.S.	VALVE	VALVE	250mm W.W.S.
MANHOLE	MANHOLE	MANHOLE	SURVEY BAR	SURVEY BAR	MANHOLE	LAND DRAINAGE SEWER	LAND DRAINAGE SEWER	MANHOLE
CATCH BASIN	CATCH BASIN	CATCH BASIN	ELEVATION	ELEVATION	CATCH BASIN	WASTE WATER SEWER	WASTE WATER SEWER	CATCH BASIN
CURB INLET	CURB INLET	CURB INLET	TREE	TREE	CURB INLET	PROFILE	PROFILE	CURB INLET
JUNCTIONS	JUNCTIONS	JUNCTIONS	SIDEWALK RAMP	SIDEWALK RAMP	JUNCTIONS	N/W GUTTER	N/W GUTTER	JUNCTIONS
CULVERT	CULVERT	CULVERT	CONCRETE SIDEWALK	CONCRETE SIDEWALK	CULVERT	S/E GUTTER	S/E GUTTER	CULVERT
GAS	GAS	GAS	FENCE	FENCE	GAS	N/W SIDEWALK	N/W SIDEWALK	GAS
						S/E SIDEWALK	S/E SIDEWALK	

LOCATION APPROVED UNDERGROUND STRUCTURES

SUPV. U/G STRUCTURES COMMITTEE DATE

NOTE:
 LOCATION OF UNDERGROUND STRUCTURES AS SHOWN ARE BASED ON THE BEST INFORMATION AVAILABLE, BUT NO GUARANTEE IS GIVEN THAT ALL EXISTING UTILITIES ARE SHOWN OR THAT THE GIVEN LOCATIONS ARE EXACT. CONFIRMATION OF EXISTENCE AND EXACT LOCATION OF ALL SERVICES MUST BE OBTAINED FROM THE INDIVIDUAL UTILITIES BEFORE PROCEEDING WITH CONSTRUCTION.

B.M. 27-034 N.E. CORNER HENDERSON HWY & POPLAR AVE
 ELEV. 230.622 3.0m S. OF N.L. OF POPLAR AVE & ON E. HENDERSON HWY

NO.	REVISIONS	DATE	BY
1	ISSUED FOR CONSTRUCTION	APR 30/04	BC
A	ISSUED FOR REVIEW	MAR 30/04	BC

EARTH TECH
 Earth Tech (Canada) Inc. Winnipeg, Manitoba 204.477.5381

DESIGNED BY: BC
 CHECKED BY: TGS
 DRAWN BY: BC
 APPROVED BY: [Signature]

HOR. SCALE: 1=250
 VERTICAL: 1=10

RELEASED FOR CONSTRUCTION BY: [Signature]

CONSULTANT DRAWING NO. CT06

THE CITY OF WINNIPEG
 PUBLIC WORKS DEPARTMENT
 ENGINEERING DIVISION

T.G. SMITH
 REGISTERED PROFESSIONAL ENGINEER

STATION: 3+90 TO ST. MATTHEWS AVENUE

PAVEMENT RECONSTRUCTION PLAN/PROFILE

CITY DRAWING NUMBER: SHEET 3 OF 3