

<b>CURVE DATA 1</b> Δ = 4'13'22" R = 140.000 T = 5.161 L = 10.318 C = 12.600 E = 0.095 BC STA = 2+82.976 EC STA = 2+93.294	<b>CURVE DATA 2</b> Δ = 4'13'22" R = 140.000 T = 5.161 L = 10.318 C = 12.600 E = 0.095 BC STA = 2+92.999 EC STA = 2+93.317	<b>CURVE DATA 3</b> Δ = 4'12'33" R = 140.000 T = 5.145 L = 10.285 C = 10.283 E = 0.095 BC STA = 3+14.571 EC STA = 3+24.856	<b>CURVE DATA 4</b> Δ = 4'12'33" R = 140.000 T = 5.145 L = 10.285 C = 10.283 E = 0.095 BC STA = 3+14.593 EC STA = 3+24.878	<b>CURVE DATA 5</b> Δ = 37'35'40" R = 60.000 T = 20.422 L = 39.369 C = 38.666 E = 3.3804 BC STA = 4+18.590 EC STA = 4+47.960	<b>CURVE DATA 6</b> Δ = 37d33'55" R = 80.000 T = 27.197 L = 52.434 C = 51.517 E = 4.497 BC STA = 4+07.280 EC STA = 4+59.714	<b>CURVE DATA 7</b> Δ = 25d45'25" R = 50.000 T = 11.432 L = 22.477 C = 22.288 E = 1.29 BC STA = 4+24.003 EC STA = 4+46.480	<b>CURVE DATA 7A</b> Δ = 8d44'21" R = 100.000 T = 7.641 L = 15.253 C = 15.238 E = 0.292 BC STA = 4+08.750 EC STA = 4+24.003	<b>CURVE DATA 7B</b> Δ = 4d43'12" R = 100.000 T = 4.121 L = 8.238 C = 8.236 E = 0.085 BC STA = 4+46.480 EC STA = 4+54.718
--	--	--	--	--	---	--	---	---

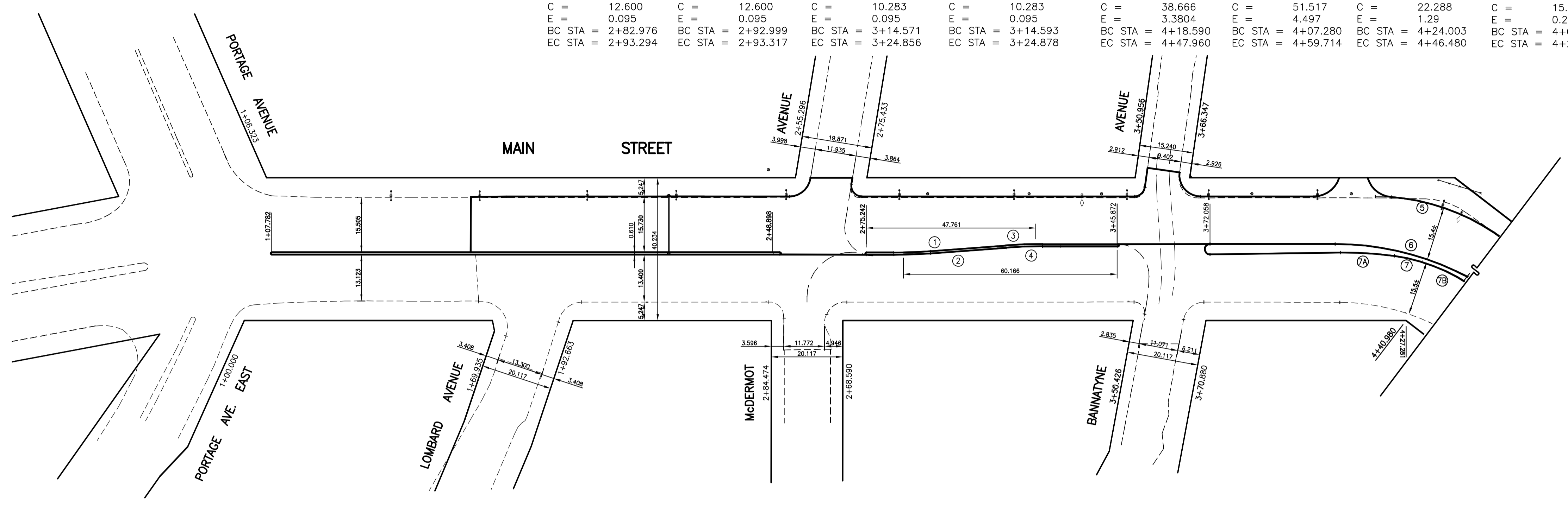

<b>CURVE DATA 8</b> Δ = 354'21'59" R = 140.000 T = 6.888 L = 13.765 C = 13.759 E = 0.169 BC STA = 5+63.278 EC STA = 5+77.021	<b>CURVE DATA 9</b> Δ = 354'21'55" R = 140.000 T = 6.889 L = 13.768 C = 13.762 E = 0.169 BC STA = 5+85.132 EC STA = 5+98.871	<b>CURVE DATA 10</b> Δ = 354'21'59" R = 140.000 T = 6.888 L = 13.765 C = 13.759 E = 0.169 BC STA = 6+53.551 EC STA = 6+67.294	<b>CURVE DATA 11</b> Δ = 354'21'55" R = 140.000 T = 6.889 L = 13.768 C = 13.762 E = 0.169 BC STA = 6+75.387 EC STA = 6+89.132	<b>CURVE DATA 12</b> Δ = 354'21'59" R = 140.000 T = 6.888 L = 13.765 C = 13.759 E = 0.169 BC STA = 7+49.914 EC STA = 7+63.660
--	--	---	---	---

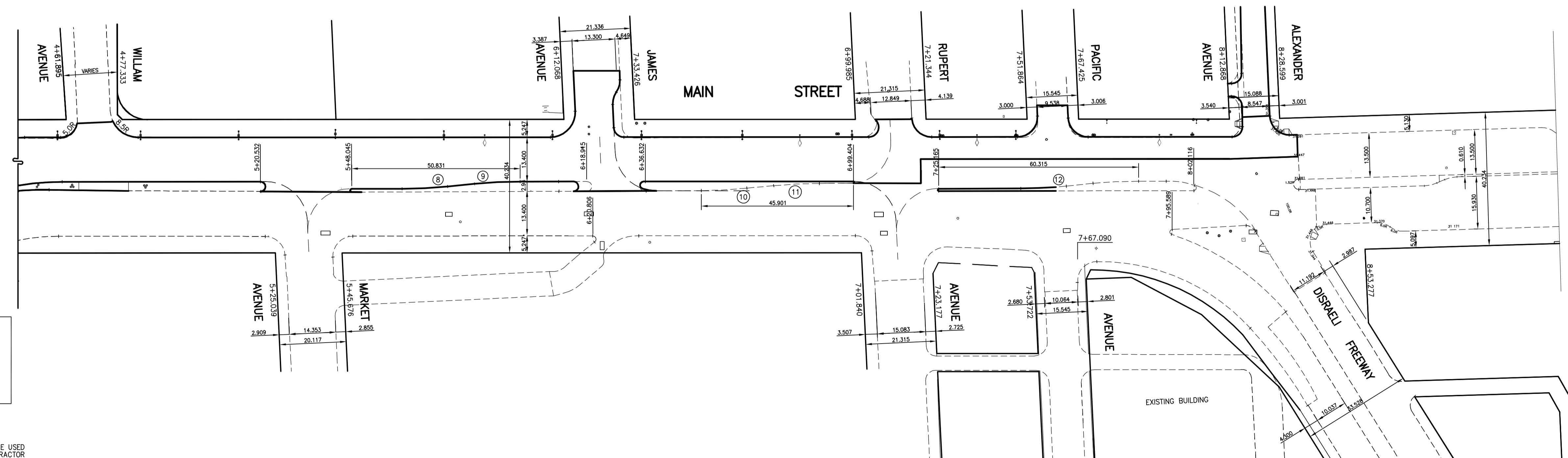

**APEGM**  
Certificate of Authorization  
Stantec Consulting Ltd.  
No. 1301 Expiry: April 30, 2004

**WARNING**  
IF POWER EQUIPMENT OR EXPLOSIVES ARE TO BE USED FOR EXCAVATION ON THIS PROJECT THE CONTRACTOR MUST:  
1) NOTIFY THE GAS COMPANY OF THE PROPOSED LOCATION OF EXCAVATION.  
2) TAKE PRECAUTION TO AVOID DAMAGE TO GAS COMPANY INSTALLATIONS.  
SEE PROVINCIAL REGULATION 140/92 FOR DETAILS.

**METRIC**  
WHOLE NUMBERS INDICATE MILLIMETRES  
DECIMALIZED NUMBERS INDICATE METRES  
NOTE: CHAINAGES SHOWN ARE ALONG C OF R.O.W.

**LOCATION APPROVED UNDERGROUND STRUCTURES**

SUPV. U/G STRUCTURES COMMITTEE	DATE
NOTE: LOCATION OF UNDERGROUND STRUCTURES AS SHOWN ARE BASED ON THE BEST INFORMATION AVAILABLE BUT NO GUARANTEE IS GIVEN THAT ALL EXISTING UTILITIES ARE SHOWN OR THAT THE GIVEN LOCATIONS ARE EXACT. CONFIRMATION OF EXISTENCE AND EXACT LOCATION OF ALL SERVICES MUST BE OBTAINED FROM THE INDIVIDUAL UTILITIES BEFORE PROCEEDING WITH CONSTRUCTION.	
NO. REVISIONS	DATE BY

B.M. ELEV.	

**Stantec Consulting Ltd.**  
905 Waverley Street, Winnipeg, Manitoba  
Tel 204-489-5900 Fax 204-453-9012

DESIGNED BY	V.M.	CHECKED BY	V.R.N.
DRAWN BY	V.M.	APPROVED BY	C.L.D.
HOR. SCALE:	1:750	RELEASED FOR ORIGINAL CONSTRUCTION:	SIGNED BY: F. COREY
VERTICAL:		DATE	FEBRUARY 09, 2004
		DATE	MARCH 25, 2004

ENGINEER'S SEAL  
ORIGINAL SEALED BY  
C.L.DYCK  
P. ENG.  
03/25/2004  
CONSULTANT DRAWING NO.  
**CW-58-599**

**THE CITY OF WINNIPEG**  
PUBLIC WORKS DEPARTMENT  
ENGINEERING DIVISION

**2004 PAVEMENT RECONSTRUCTION  
MAIN STREET (SOUTH BOUND)  
LOMBARD AVE. TO DISRAELI FREEWAY  
ROADWAY GEOMETRICS**

SHEET 2 OF 27  
CAD FILE DRAWING NUMBER  
CW-58-599  
CITY DRAWING NUMBER  
**P-3247-2**

V:\1137\winnipeg\113702090-2004 Main Street Reconstruction - Southbound\winnipeg\DW-58-599.dwg  
2004-03-26 09:24AM By: vman01