

D. SIZE 22" x 34" (558mm x 863mm)

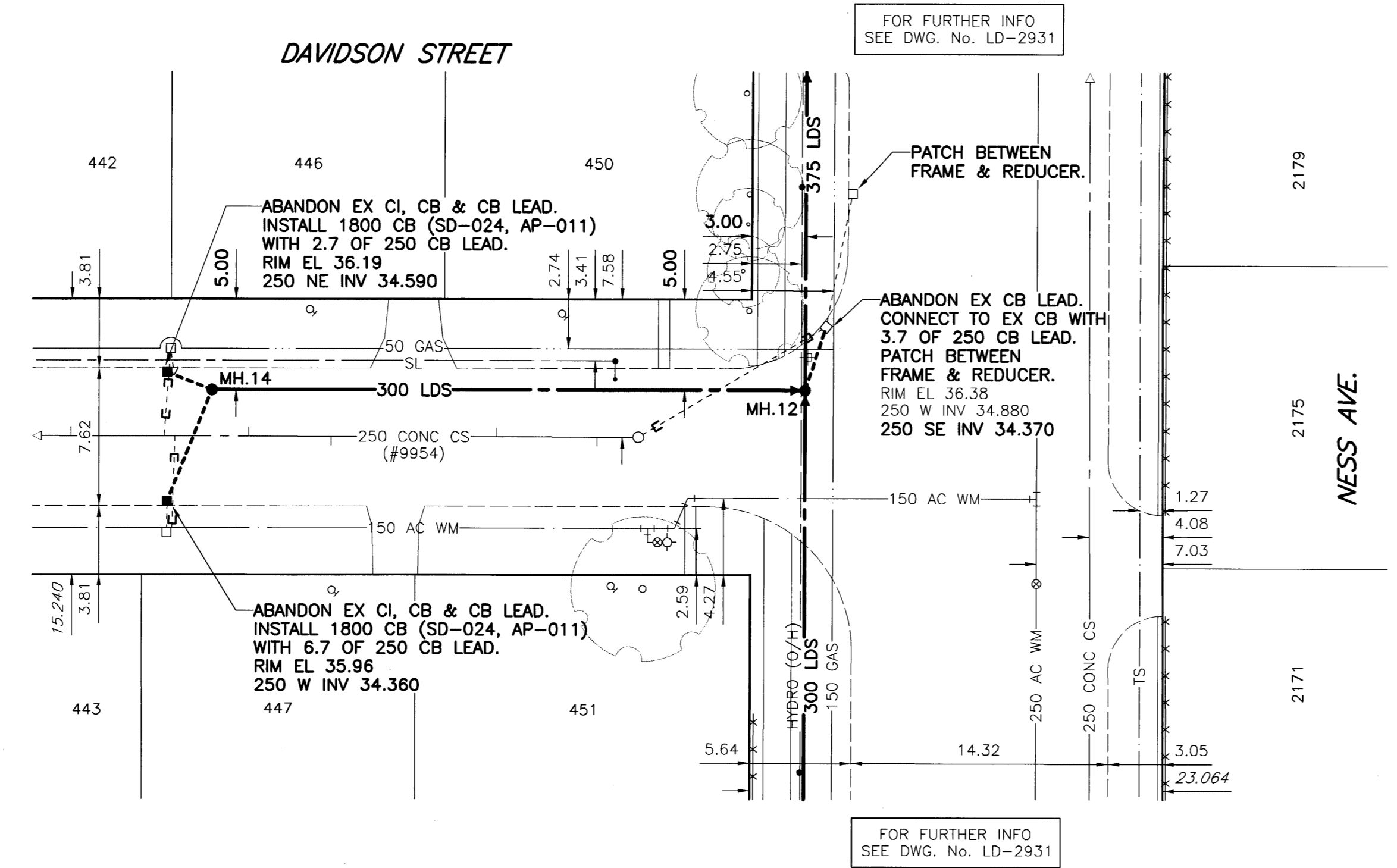
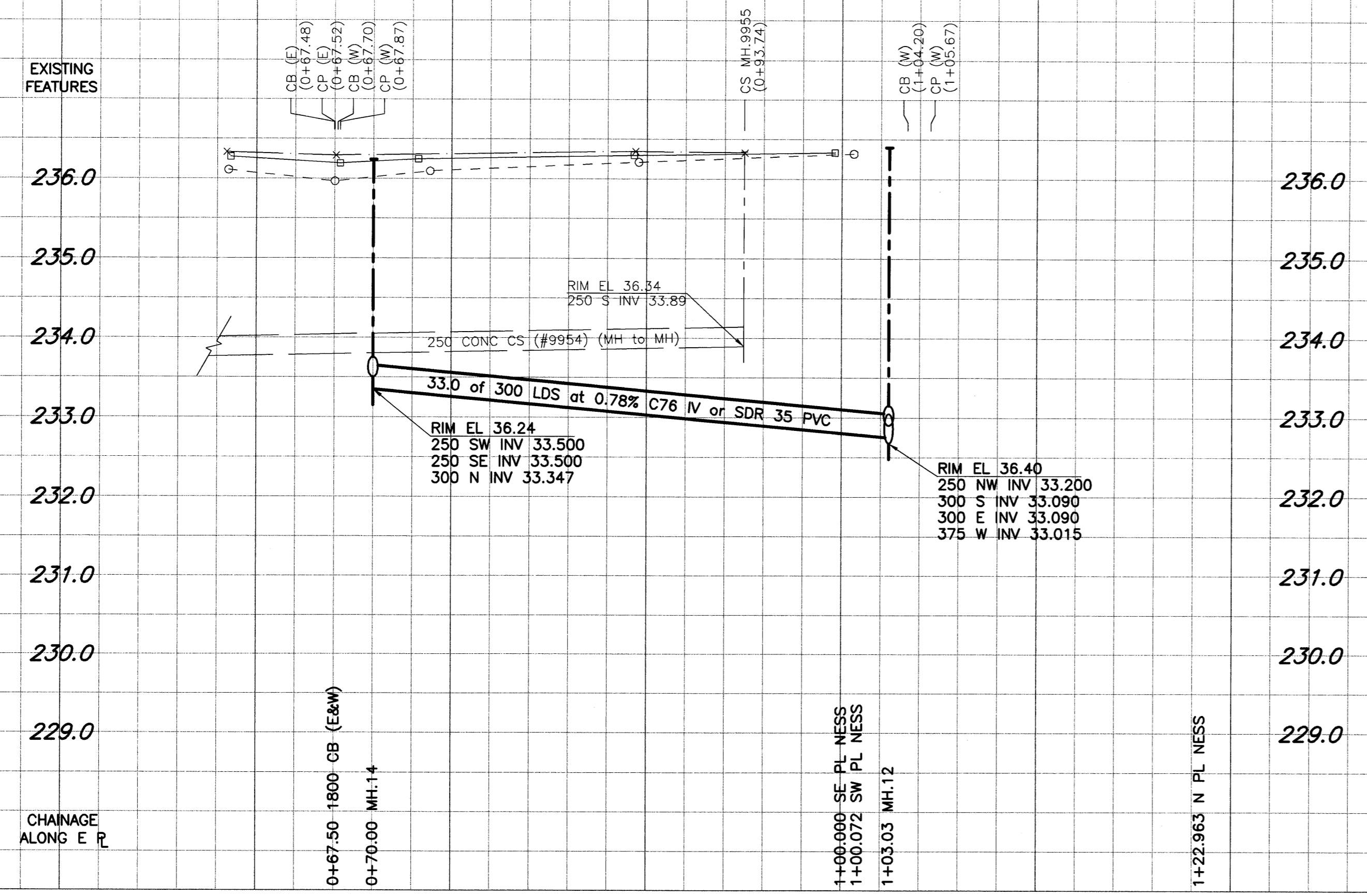

WARNING
IF POWER EQUIPMENT OR EXPLOSIVES ARE TO BE USED FOR EXCAVATION ON THIS PROJECT, THE CONTRACTOR MUST:
1) NOTIFY THE GAS COMPANY OF THE PROPOSED LOCATION OF EXCAVATION.
2) TAKE PRECAUTION TO AVOID DAMAGE TO GAS COMPANY INSTALLATIONS.
SEE PROVINCIAL REGULATION 140/92 FOR DETAILS

150 mm WM	WATERMAIN	150 mm WM	HYDRO	150 mm WM	WATERMAIN
Hydrant	HYDRANT	Valve	MTS	Hydrant	HYDRANT
300 mm LDS	LAND DRAINAGE SEWER	300 mm LDS	CONCRETE	300 mm LDS	LAND DRAINAGE SEWER
250 mm WWS	WASTE WATER SEWER	250 mm WWS	ASPHALT	250 mm WWS	WASTE WATER SEWER
Manhole	MANHOLE	Catch Basin	CURB STOP	Profile	PROFILE
Catch Basin	CATCH BASIN	Curb Inlet	Reducer	Non-vented Sooter	NON-VENTED SOOTER
Curb Inlet	CURB INLET	Culvert	Coupling	Sooter	SOOTER
Culvert	CULVERT	Survey Bar	Anode	Lamp Standard	LAMP STANDARD
Survey Bar	SURVEY BAR	Pipe Abandonments	WM Monitoring Station	Tree	TREE
Pipe Abandonments	PIPE ABANDONMENTS	Existing	Legend - Plan	Existing	LEGEND - PROFILE
Existing	LEGEND - PLAN	Proposed	Proposed	Existing	PROPOSED

LOCATION APPROVED UNDERGROUND STRUCTURES	DATE
SUPR. U/G STRUCTURES COMMITTEE	
NOTE: LOCATION OF UNDERGROUND STRUCTURES AS SHOWN ARE BASED ON THE BEST INFORMATION AVAILABLE, BUT NO GUARANTEE IS GIVEN THAT ALL EXISTING UTILITIES ARE SHOWN OR THAT THE GIVEN LOCATIONS ARE EXACT. CONFIRMATION OF EXISTENCE AND EXACT LOCATION OF ALL SERVICES MUST BE OBTAINED FROM THE INDIVIDUAL UTILITIES BEFORE PROCEEDING WITH CONSTRUCTION.	
NO. REVISIONS	DATE BY

METRIC
WHOLE NUMBERS INDICATE MILLIMETRES
DECIMALIZED NUMBERS INDICATE METRES

UMA Engineering Ltd.
• Consulting • Engineering • Construction • Management Services

DESIGNED BY: FMI
CHECKED BY: C.C.
DRAWN BY: ADL
APPROVED BY: *Benjamin*
HOR. SCALE: 1:250
VERTICAL: 1:50
DATE: 04/04/03
DATE: 04/04/03

APCM
Certificate of Authorization
UMA Engineering Ltd.
No. 256 Expiry: April 30, 2004

ENGINEER'S SEAL
PROVINCE OF MANITOBA
C.C. MACEY
REGISTERED ENGINEER
CONSULTANT DRAWING NO. 07
D265-096-03

- CONSTRUCTION NOTES:**
- For detailed test hole information, see specifications.
 - The location of all services is to be confirmed in the field.
 - Install new sewers and catchbasin leads by trenchless methods wherever possible.
 - Renew/Rehabilitate catchbasins & renew catchbasin leads where noted.
- Bid Opportunity No. 140-2004

THE CITY OF WINNIPEG
Winnipeg WATER AND WASTE DEPARTMENT

STRATHMILLAN/MOORGATE
COMBINED SEWER RELIEF
CONTRACT 5
DAVIDSON STREET
40m S of NESS AVE.
to NESS AVE.

SHEET 07 OF 20
CITY DRAWING NUMBER LD-2932
REV

PLOT SCALE: 1:0.25
UMA FILE NAME: DAVO1PR_R-DWG_2004-04-07 11:47am ADL