

D. SIZE 22" x 34" (558mm x 863mm)

EXISTING FEATURES

236.0  
235.0  
234.0  
233.0  
232.0  
231.0  
230.0  
229.0

236.0  
235.0  
234.0  
233.0  
232.0  
231.0  
230.0  
229.0

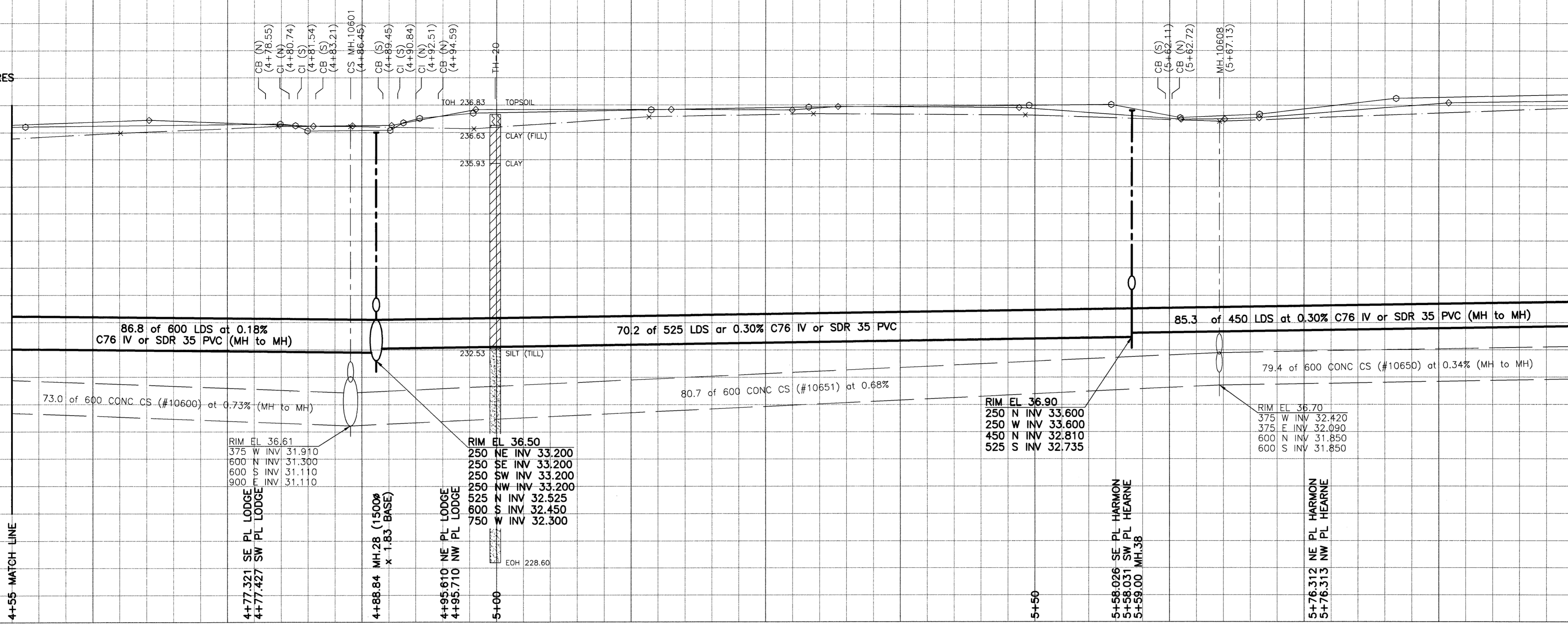

FOR FURTHER INFO  
SEE DWG. No. LD-2948

MOUNT ROYAL ROAD

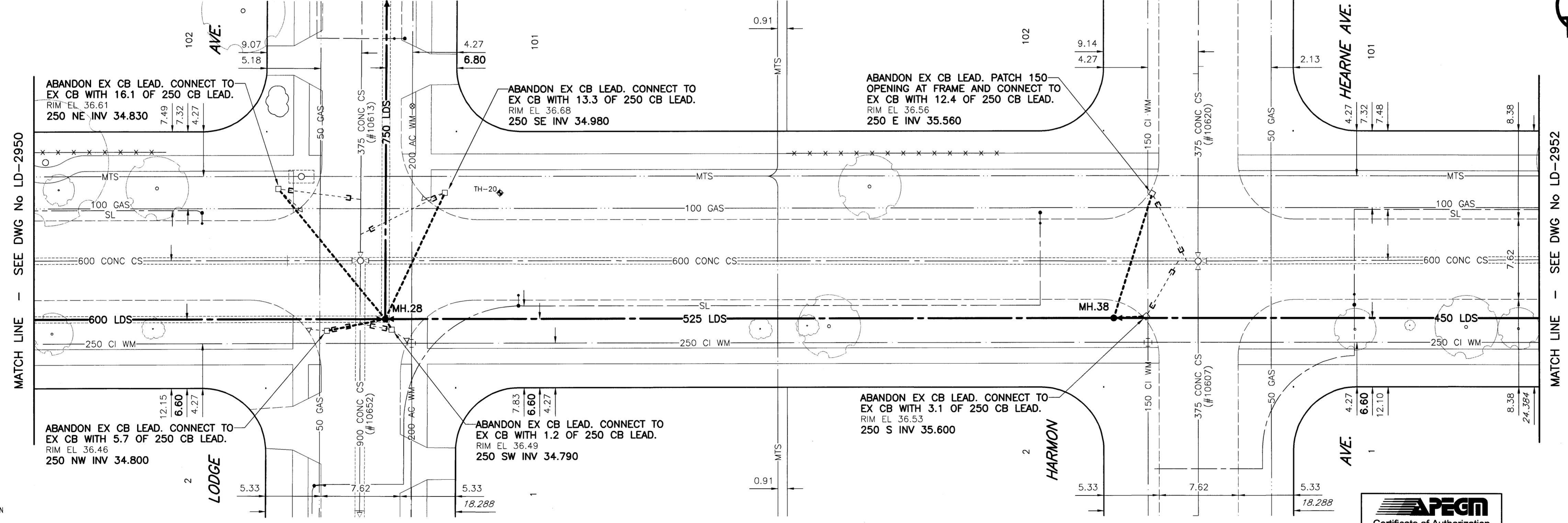

MATCH LINE - SEE DWG No LD-2950

MATCH LINE - SEE DWG No LD-2952

**WARNING**

IF POWER EQUIPMENT OR EXPLOSIVES ARE TO BE USED FOR EXCAVATION ON THIS PROJECT, THE CONTRACTOR MUST:  
1) NOTIFY THE GAS COMPANY OF THE PROPOSED LOCATION OF EXCAVATION.  
2) TAKE PRECAUTION TO AVOID DAMAGE TO GAS COMPANY INSTALLATIONS.  
SEE PROVINCIAL REGULATION 140/92 FOR DETAILS

**CONSTRUCTION NOTES:**

- For detailed test hole information, see specifications.
- The location of all services is to be confirmed in the field.
- Install new sewers and catchbasin leads by trenchless methods wherever possible.
- Renew/Rehabilitate catchbasins & renew catchbasin leads where noted.

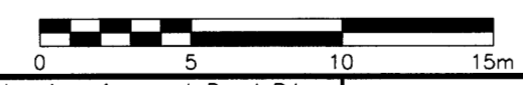

**METRIC**  
WHOLE NUMBERS INDICATE MILLIMETRES  
DECIMALIZED NUMBERS INDICATE METRES

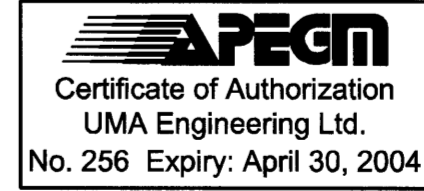

Bid Opportunity No. 141-2004

150 mm WM	WATERMAIN	150 mm WM	HYDRO	150 mm WM	WATERMAIN
Hydrant	Hydrant	Hydrant	MTS	Hydrant	Hydrant
Valve	Valve	Valve	Gas	Valve	Valve
300 mm LDS	LAND DRAINAGE SEWER	300 mm LDS	CONCRETE	300 mm LDS	LAND DRAINAGE SEWER
250 mm WWS	WASTE WATER SEWER	250 mm WWS	ASPHALT	250 mm WWS	WASTE WATER SEWER
Manhole	Manhole	Manhole	CURB STOP	Profile	Profile
Catch Basin	Catch Basin	Catch Basin	REDUCER	North/West	North/West
Curb Inlet	Curb Inlet	Curb Inlet	COUPLING	South/East	South/East
Culvert	Culvert	Culvert	ANODE	Lamp Standard	Lamp Standard
Survey Bar	Survey Bar	Survey Bar	WM MONITORING STATION	Tree	Tree
Pipe Abandonments	Pipe Abandonments	Pipe Abandonments	EXISTING	LEGEND - PLAN	PROPOSED
EXISTING	LEGEND - PLAN	PROPOSED	EXISTING	LEGEND - PROFILE	PROPOSED

LOCATION UNDERGROUND	APPROVED STRUCTURES
SUPR. U/G STRUCTURES COMMITTEE	DATE
NOTE: LOCATION OF UNDERGROUND STRUCTURES AS SHOWN ARE BASED ON THE BEST INFORMATION AVAILABLE, BUT NO GUARANTEE IS GIVEN THAT ALL EXISTING UTILITIES ARE SHOWN OR THAT THE GIVEN LOCATIONS ARE EXACT. CONFIRMATION OF EXISTENCE AND EXACT LOCATION OF ALL SERVICES MUST BE OBTAINED FROM THE INDIVIDUAL UTILITIES BEFORE PROCEEDING WITH CONSTRUCTION.	
NO.	REVISIONS
	DATE
	BY

B.M. 39-062	N.W. Cor. Lodge Ave. & Mount Royal Rd.
ELEV. 236.559m	Tbpt. on top of 0.05m dia. x 2.4m iron pipe, 1.2m S. of N.L. of Lodge Ave. & 7.7m E. of W.L. of Mount Royal Rd.
DESIGNED BY	FMI
CHECKED BY	ccc
DRAWN BY	ADL
APPROVED BY	<i>[Signature]</i>
HOR. SCALE:	1:250
VERTICAL:	1:50
DATE	04/04/20
DATE	04/04/20

**UMA Engineering Ltd.**  
Consulting • Engineering • Construction • Management Services

ENGINEER'S SEAL  
PROVINCE OF MANITOBA  
20 APR 04  
C.C. MACEY  
REGISTERED ENGINEER

CONSULTANT DRAWING NO. 06  
D265-096-03

**THE CITY OF WINNIPEG**  
Winnipeg WATER AND WASTE DEPARTMENT

STRATHMILLAN/MOORGATE  
COMBINED SEWER RELIEF  
CONTRACT 6

MOUNT ROYAL ROAD  
34m N of HIND AVE.  
to 37m S of FIDLER AVE. (S. LEG)

SHEET 06 OF 15  
CITY DRAWING NUMBER LD-2951  
REV

PLOT SCALE: 1:0.25  
UMA FILE NAME: M001PR\_R-DWG 2004-04-19 3:17pm ADL