

1 PARKING LOT PLAN
L1 SCALE 1:500

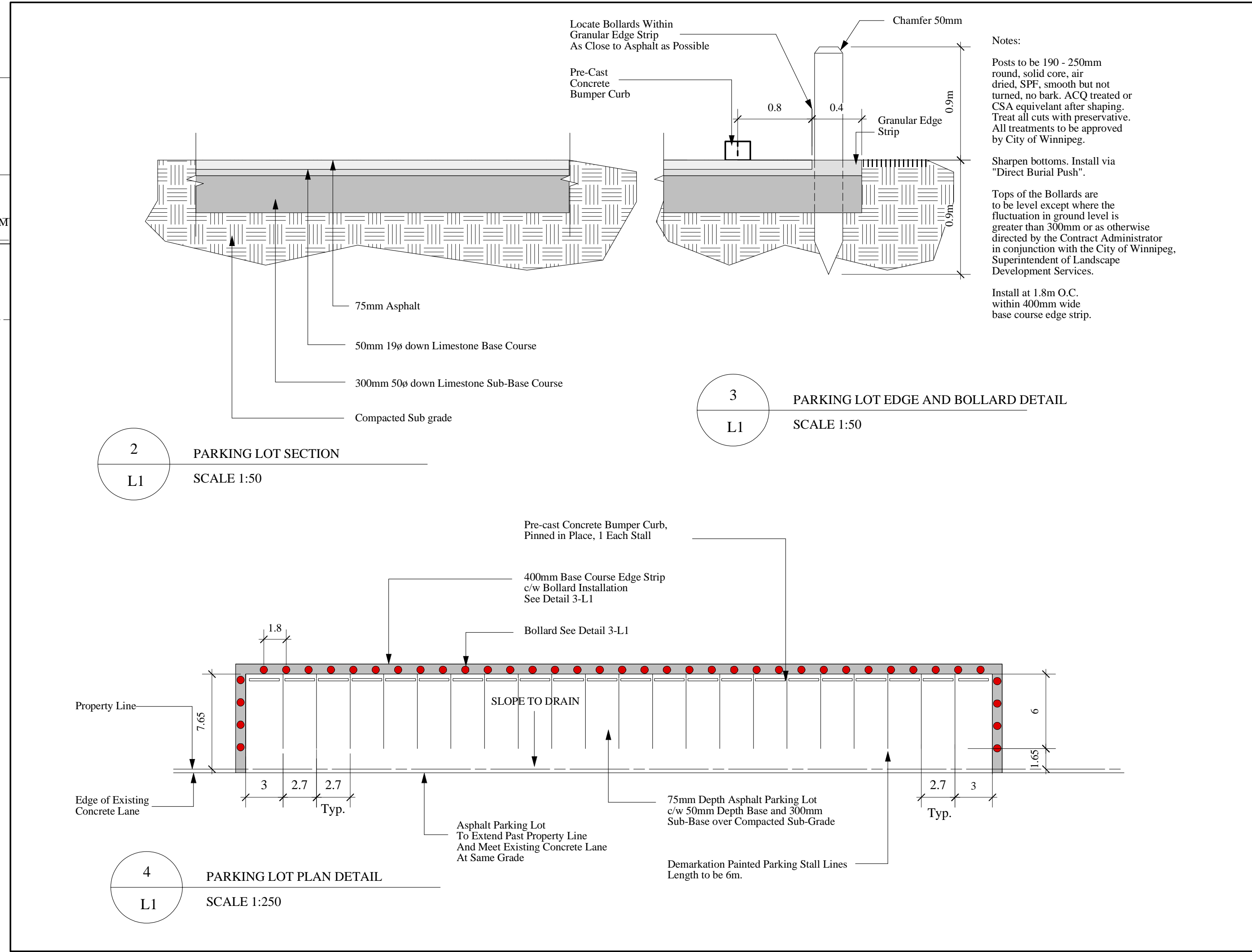

2 PARKING LOT SECTION
L1 SCALE 1:50

3 PARKING LOT EDGE AND BOLLARD DETAIL
L1 SCALE 1:50

4 PARKING LOT PLAN DETAIL
L1 SCALE 1:250

Notes:

Posts to be 190 - 250mm round, solid core, air dried, SPF, smooth but not turned, no bark, ACQ treated or CSA equivalent after shaping. Treat all cuts with preservative. All treatments to be approved by City of Winnipeg.

Sharpen bottoms. Install via "Direct Burial Push".

Tops of the Bollards are to be level except where the fluctuation in ground level is greater than 300mm or as otherwise directed by the Contract Administrator in conjunction with the City of Winnipeg, Superintendent of Landscape Development Services.

Install at 1.8m O.C. within 400mm wide base course edge strip.

© David Wagner Associates Inc. All rights reserved. All drawings are copyright to the author. It is to be clearly understood that the author, in producing and drawing, shall not be liable for any and all loss, damage or injury that may result from the drawings. The author is not responsible for any and all claims that may be made or from any claims that may result subsequent to the project being completed and the construction on the site, whether such claims are brought by persons using the site, or by the owners or others of neighboring properties.

Should any claim be made directly against the author as a result of the drawings, the author shall not be held liable for any and all loss, damage or injury that may result from the drawings, or on a claim or a claim that may result subsequent to the project being completed and the construction on the site, whether such claims are brought by persons using the site, or by the owners or others of neighboring properties.

No reproduction may be made without the permission of the author. Any and all design services are the property of the author. All rights reserved. If stamped and dated, the design herein is licensed for construction, one-time only. All prints to be returned to the author, or sent to the author as requested.

This drawing shall not be used for building purposes and is not to be used for any other purpose without the written consent of the author. The contractor shall check all dimensions and other data on site and report any discrepancies to the author. If in doubt please ask.

Notes

LOCATION OF UNDERGROUND STRUCTURES AS SHOWN ARE BASED ON THE BEST INFORMATION AVAILABLE BUT NO GUARANTEE IS GIVEN THAT ALL EXISTING UTILITIES ARE SHOWN OR THAT THE GIVEN LOCATIONS ARE EXACT. CONFIRMATION OF EXISTENCE AND EXACT LOCATION OF ALL SERVICES MUST BE OBTAINED FROM THE INDIVIDUAL UTILITIES BEFORE PROCEEDING WITH CONSTRUCTION.

Irrigation System

The irrigation system as shown on the drawing is schematic only. It is the Contractor's responsibility to contact the City of Winnipeg (see Specification) to locate the system. It is the Contractor's responsibility to protect the located irrigation system.

Winnipeg

Manager Parks and Open Space Division
Released For Construction Date

Project: Fairgrove Bay Park
Winnipeg, Manitoba

Sheet Title: Parking Lots

Drawn: DW	Checked:
Date: March 15, 2004	Scale: 1:500 metric
Job No: 0329	Sheet No: L1