

DEMOLITION - KEYNOTES

- 1 REFER TO WALKWORK SCHEDULE THIS PAGE.
- 2 REFER TO WALKWORK SCHEDULE THIS PAGE.
- 3 REFER TO WALKWORK SCHEDULE THIS PAGE.
- 4 REFER TO WALKWORK SCHEDULE THIS PAGE.
- 5 REMOVE EXISTING SIGNAGE PEDestal, TURN OVER TO OWNER.
- 6 REMOVE CEILING MOUNTED SIGN.
- 7 REMOVE EXISTING CEILING MOUNTED SECURITY GRILL TRACK AS REQUIRED AND WALL MOUNTED HARDWARE TO SUIT NEW REDEMOLITION.
- 8 REMOVE EXISTING GB CEILING AS REQUIRED TO INSTALL NEW TRACK FOR EXISTING SECURITY GRILL AS PER DETAIL 1/A3.3
- 9 REMOVE EXISTING COAT ROD AND SHELF, REFER TO WALKWORK SCHEDULE THIS PAGE.
- 10 REFER TO WALKWORK SCHEDULE THIS PAGE.
- 11 REMOVE EXISTING BLOCK WALL TO SUIT NEW OPENING, REFER TO STRUCTURAL FOR NEW Lintel.
- 12 REFER TO WALKWORK SCHEDULE THIS PAGE.
- 13 REFER TO WALKWORK SCHEDULE THIS PAGE.
- 14 REMOVE EXISTING COAT ROD AND SHELF.
- 15 REFER TO WALKWORK SCHEDULE THIS PAGE.
- 16 REMOVE EXISTING SHELVING, TURN OVER TO OWNER.
- 17 REMOVE EXISTING SHELVING, TURN OVER TO OWNER.
- 18 REFER TO WALKWORK SCHEDULE THIS PAGE.
- 19 REFER TO WALKWORK SCHEDULE THIS PAGE.
- 20 REFER TO WALKWORK SCHEDULE THIS PAGE.
- 21 REFER TO WALKWORK SCHEDULE THIS PAGE.
- 22 REFER TO WALKWORK SCHEDULE THIS PAGE.
- 23 REFER TO WALKWORK SCHEDULE THIS PAGE.
- 24 REMOVE EXISTING BLOCK WALL TO SUIT NEW OPENING, REFER TO STRUCTURAL FOR NEW Lintel.
- 25 REMOVE EXISTING BLOCK WALL ENCLOSURE.
- 26 REMOVE EXISTING CHAIN LINK ENCLOSURE, TURN OVER TO OWNER.
- 27 REMOVE EXISTING OVERHEAD DOOR, TRACK AND OPERATOR.
- 28 REFER TO WALKWORK SCHEDULE THIS PAGE.
- 29 REFER TO WALKWORK SCHEDULE THIS PAGE.
- 30 REFER TO WALKWORK SCHEDULE THIS PAGE.
- 31 REMOVE EXISTING DOOR, HARDWARE AND FRAME, REINSTATE AT TRFP-35.
- 32 REMOVE EXISTING DOOR, HARDWARE AND FRAME, REINSTATE AT TRFP-36.
- 33 REMOVE EXISTING DOOR, HARDWARE AND FRAME, REINSTATE AT TRFP-28.
- 34 REMOVE EXISTING DOOR, HARDWARE AND FRAME, REINSTATE AT TRFP-29.
- 35 REMOVE EXISTING DOOR, HARDWARE AND FRAME, REINSTATE AT TRFP-27.
- 36 REMOVE EXISTING STEEL MESH PARTITION AND DOOR, RECONSTRUCT AS REQUIRED FOR REINSTATEMENT IN BM-PW-03.
- 37 REMOVE EXISTING STEEL MESH PARTITION AND DOOR, RECONSTRUCT AS REQUIRED FOR REINSTATEMENT IN BM-PW-03.
- 38 CUT EXISTING PRECAST PANEL TO SUIT NEW WINDOW.
- 39 REMOVE EXISTING DOOR, HARDWARE AND FRAME, REINSTATE AT PRFP-39.
- 40 REMOVE EXISTING DOOR, HARDWARE AND FRAME, REINSTATE AT TRFP-25.
- 41 REMOVE EXISTING DOOR, HARDWARE AND FRAME, REINSTATE AT TRFP-26.
- 42 REMOVE EXISTING DOOR, HARDWARE AND FRAME, REINSTATE AT TRFP-26.
- 43 REMOVE EXISTING DOOR, HARDWARE AND FRAME, REINSTATE AT TRFP-15.
- 44 REMOVE APPROX. 150MM EXISTING MILLWORK TO SUIT RELOCATED DOOR AND EXISTING MILLWORK UNITS.
- 45 REMOVE EXISTING DOOR, HARDWARE AND FRAME, REINSTATE AT TRFP-38.
- 46 REMOVE EXISTING DOOR, HARDWARE AND FRAME, REINSTATE AT TRFP-19.
- 47 REMOVE EXISTING DOOR, HARDWARE AND FRAME, REINSTATE AT TRFP-03.
- 48 REMOVE EXISTING DOOR, HARDWARE AND FRAME, REINSTATE AT TRFP-16.
- 49 REMOVE EXISTING DOOR, HARDWARE AND FRAME, REINSTATE AT TRFP-15.
- 50 REMOVE EXISTING DOOR, HARDWARE AND FRAME, REINSTATE AT TRFP-33.
- 51 REMOVE EXISTING DOOR, HARDWARE AND FRAME, REINSTATE AT TRFP-01.
- 52 REMOVE EXISTING DOOR, HARDWARE AND FRAME, REINSTATE AT TRFP-02.
- 53 REMOVE EXISTING DOOR, HARDWARE AND FRAME, REINSTATE AT TRFP-23.
- 54 REMOVE EXISTING DOOR, HARDWARE AND FRAME, REINSTATE AT TRFP-07.
- 55 REMOVE EXISTING DOOR, HARDWARE AND FRAME, REMOVE GLASS AND REINSTATE, PATCH AND REPAIR TO MATCH EXISTING REINSTATE AT TRFP-32.
- 56 REMOVE EXISTING DOOR, HARDWARE AND FRAME, REINSTATE AND REPAIR TO MATCH EXISTING REINSTATE AT DRPA-06.
- 57 REMOVE EXISTING DOOR, HARDWARE AND FRAME, C/W SLOUGHT, REMOVE EXISTING GLASS AND REPAIR TO MATCH EXISTING REINSTATE AT DRPA-02.
- 58 REMOVE EXISTING DOOR, HARDWARE AND FRAME, REINSTATE AT SAFP-04.
- 59 REMOVE EXISTING DOOR, HARDWARE AND FRAME, REINSTATE AT SAFP-04.
- 60 REMOVE EXISTING DOOR, HARDWARE AND FRAME, REMOVE GLASS, PATCH AND REPAIR TO MATCH EXISTING REINSTATE AT SAFP-06.
- 61 REMOVE EXISTING DOOR, HARDWARE AND FRAME, REINSTATE AT SAFP-06.
- 62 REMOVE EXISTING DOOR, HARDWARE AND FRAME, REINSTATE AT SAFP-15.
- 63 REMOVE EXISTING DOOR, HARDWARE AND FRAME, REINSTATE AT PRFP-04.
- 64 REMOVE EXISTING DOOR, HARDWARE AND FRAME, REINSTATE AT PRFP-05.
- 65 REMOVE EXISTING DOOR, REINSTATE WITH NEW FRAME AND HARDWARE AT PRFP-01.
- 66 REMOVE EXISTING DOOR, REINSTATE WITH NEW FRAME AT PRFP-16.
- 67 REMOVE EXISTING DOOR AND HARDWARE, REINSTATE WITH NEW FRAME AT PRFP-13.
- 68 REMOVE EXISTING DOOR AND HARDWARE, REINSTATE WITH NEW FRAME AT PRFP-14.
- 69 REMOVE EXISTING DOOR, HARDWARE AND FRAME, C/W SLOUGHT, REINSTATE AT PRFP-06.
- 70 REMOVE EXISTING FRENCH CABINET, REINSTATE AT NEW LOCATION, REFER TO SPEC.
- 71 REMOVE EXISTING STEEL GRATE, TURN OVER TO OWNER.
- 72 REFER TO STRUCTURAL FOR CHIPPING THE EDGE AND FINISHING OF EXISTING CONCRETE SLAB FOR BONDED TOPPING AND FLOOR LEVELER APPLICATION.
- 73 NEW SKINITE - REFER TO RETIELED CEILING PLAN AND STRUCTURAL DRAWINGS FOR EXTENT OF CEILING DISMANTLE/REMOVAL.
- 74 REMOVE EXISTING GATE FRAME.
- 75 REMOVE EXISTING PRE-CAST CONC. PANELS, BASE ANGLE AND METAL PANELS OVER.
- 76 REMOVE EXISTING WINDOWS, PRE-CAST PANEL AND STLD WALL ASSEMBLY TO SUIT NEW ADDITION.

EXISTING LOCATION (LISTED BY DEMO NOTE)	NEW LOCATION (LISTED BY RM. NO.)	NOTES
1. Refer to Demo Note 1 (Front Reception)	Lobby TRFP-22	See plan 72/ASA, elevations 73 through 76/ASA and details 35 through 39/AS1.2 for modifications.
2. Refer to Demo Note 2 (Behind Reception)	None	Mark to be removed and turned over to owner.
3. Refer to Demo Note 3 (Counter)	None	Mark to be removed and turned over to owner.
4. Refer to Demo Note 4A	None	Mark to be removed and turned over to owner.
5. Refer to Demo Note 4B	TRFP-12	Mark to be removed and relocated. See elevation 86/ASA for exact location.
6. Refer to Demo Note 7B	Locker TRFP-30	Mark to be removed and relocated. See Elevation 86/ASA for modifications.
7. Refer to Demo Note 12	Walkroom TRFP-19	Mark to be removed and relocated. No Modifications required.
8. Refer to Demo Note 13	None	Mark to be removed and turned over to owner.
9. Refer to Demo Note 15	Meeting Room TRFP-09	Mark to be removed and relocated. See Elevation 86/ASA for modifications.
10. Refer to Demo Note 18	None	Mark to be removed and turned over to owner.
11. Refer to Demo Note 19	None	Mark to be removed and turned over to owner.
12. Refer to Demo Note 20	Meeting Room TRFP-12	Mark to be removed and relocated. See Elevation 72/ASA for modifications. (See spec)
13. Refer to Demo Note 21	Meeting Room TRFP-12	Mark to be removed and relocated. See Elevation 72/ASA for modifications. (See spec)
14. Refer to Demo Note 22	Walkroom TRFP-19	Mark to be removed and relocated. No Modifications required.
15. Refer to Demo Note 23	Coffee TRFP-12	Mark to be removed and relocated. See Elevation 72/ASA for modifications. (See spec)
16. Refer to Demo Note 24	First Aid Room TRFP-03	Mark to be removed and relocated. See Elevation 70/ASA for modifications. (See spec)
17. Refer to Demo Note 25	None	Mark to be removed and turned over to owner.

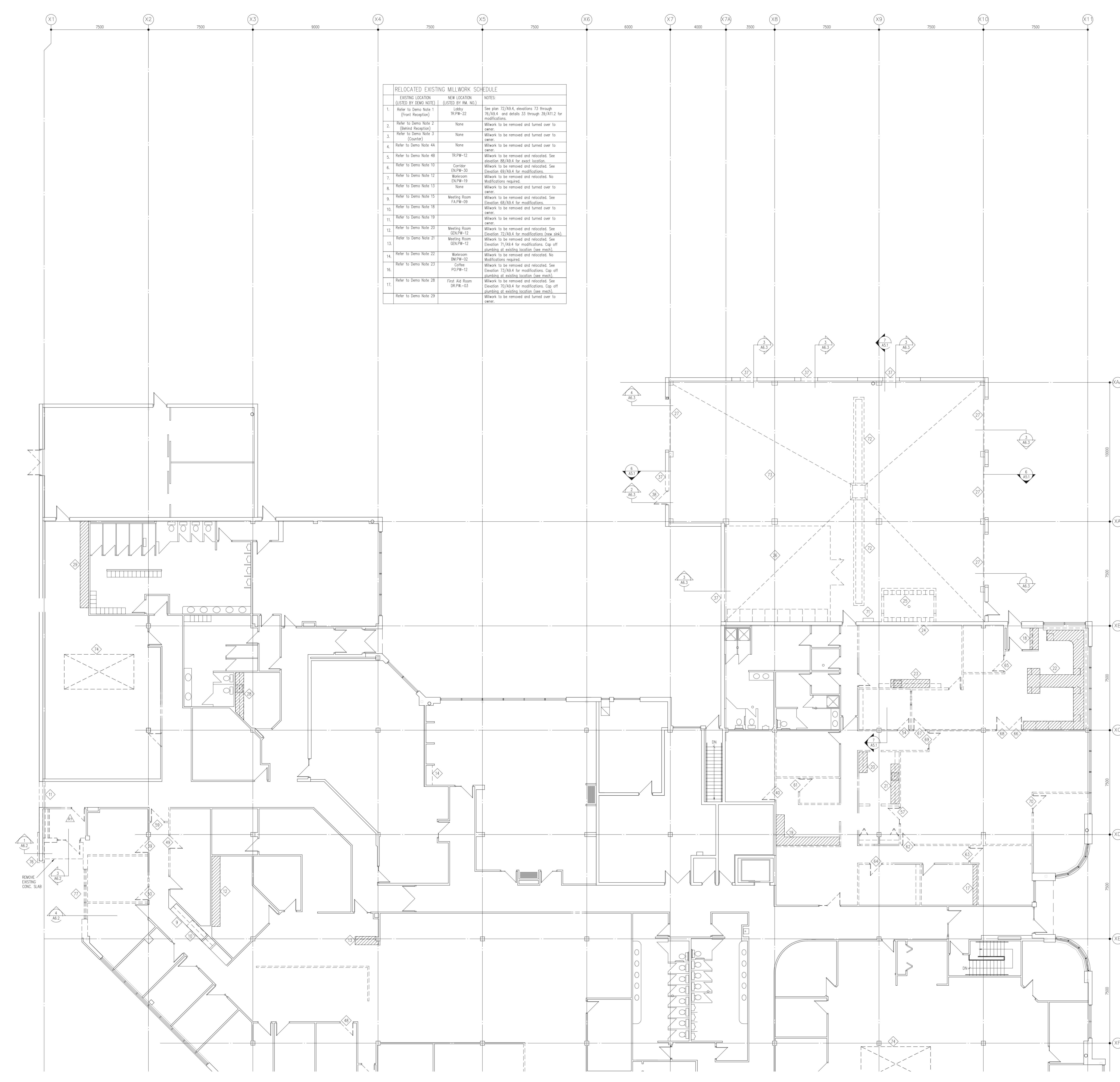

REMOVE EXISTING CONC. SLAB