

- NOTES
- REFER TO DETAIL SHEETS ED-2 AND ED-3.
 - FENCE MOUNTED PARKING OUTLETS. REFER TO ARCHITECTURAL DETAILS. REFER TO ELECTRICAL DETAIL.
 - PROVIDE ADDITIONAL BREAKERS TO MATCH EXISTING FOR NEW DEVICES/CIRCUITS.
 - U/G WIRING FOR ALL LIGHTING TO BE 2/C#10 CU TECK.

PROJECT NO.	AA / RC
DATE	CB
ISSUE	APRIL 2004
REVISIONS	
1. ISSUED FOR 50% REVIEW	FEBRUARY 6, 2004
2. ISSUED FOR 75% REVIEW	MARCH 5, 2004
3. ISSUED FOR PRETENDER REVIEW	APRIL 2004
4. ISSUED FOR TENDER	MAY 14, 2004

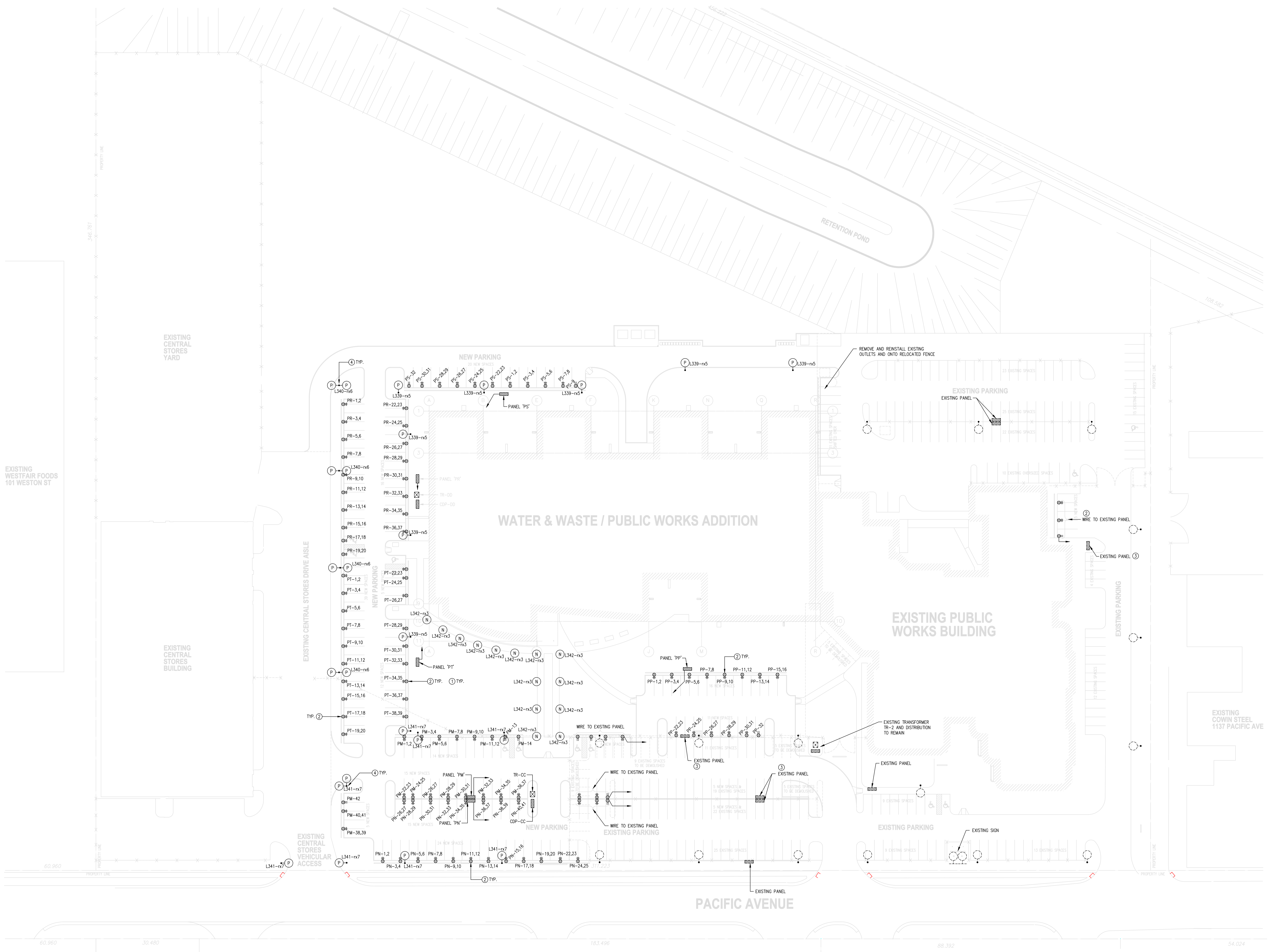

SITE PLAN
SCALE 1:400

SMS ENGINEERING
 SMS Engineering Ltd. Consulting Engineers
 775 Bannock Street Winnipeg, MB Canada R2S 0K3
 Telephone: 945.772.0101 Fax: 945.772.0100
 smseng.com

ORIGINAL CONTRACT DRAWING
 ISSUED AND RELEASED BY
 ANDY LOHRE, P.ENG.
 MAY 13, 2004

APCM
 Certificate of Authorization
 SMS Engineering Ltd.
 No. 166 Expiry April 30, 2005

Drawings and specifications, as prepared by or on behalf of the architect, are the property of the architect. The copyright in the same shall remain to him. No reproduction or other use without the permission of the architect and where made, must bear his name. All rights to be returned to the architect.
 The contractor shall verify dimensions and data noted herein with conditions on the site and is held responsible for reporting any discrepancy to the architect for adjustment.
 This drawing shall not be used for building purposes and counterchecked by:

THE CITY OF WINNIPEG

OFFICE ADDITION AND RENOVATION
 1155 PACIFIC AVENUE
 WINNIPEG, MANITOBA

FRIESEN TOKAR ARCHITECTS

SITE PLAN
E1.1