

FOR CONTINUATION, REFER TO DRAWING M1.5

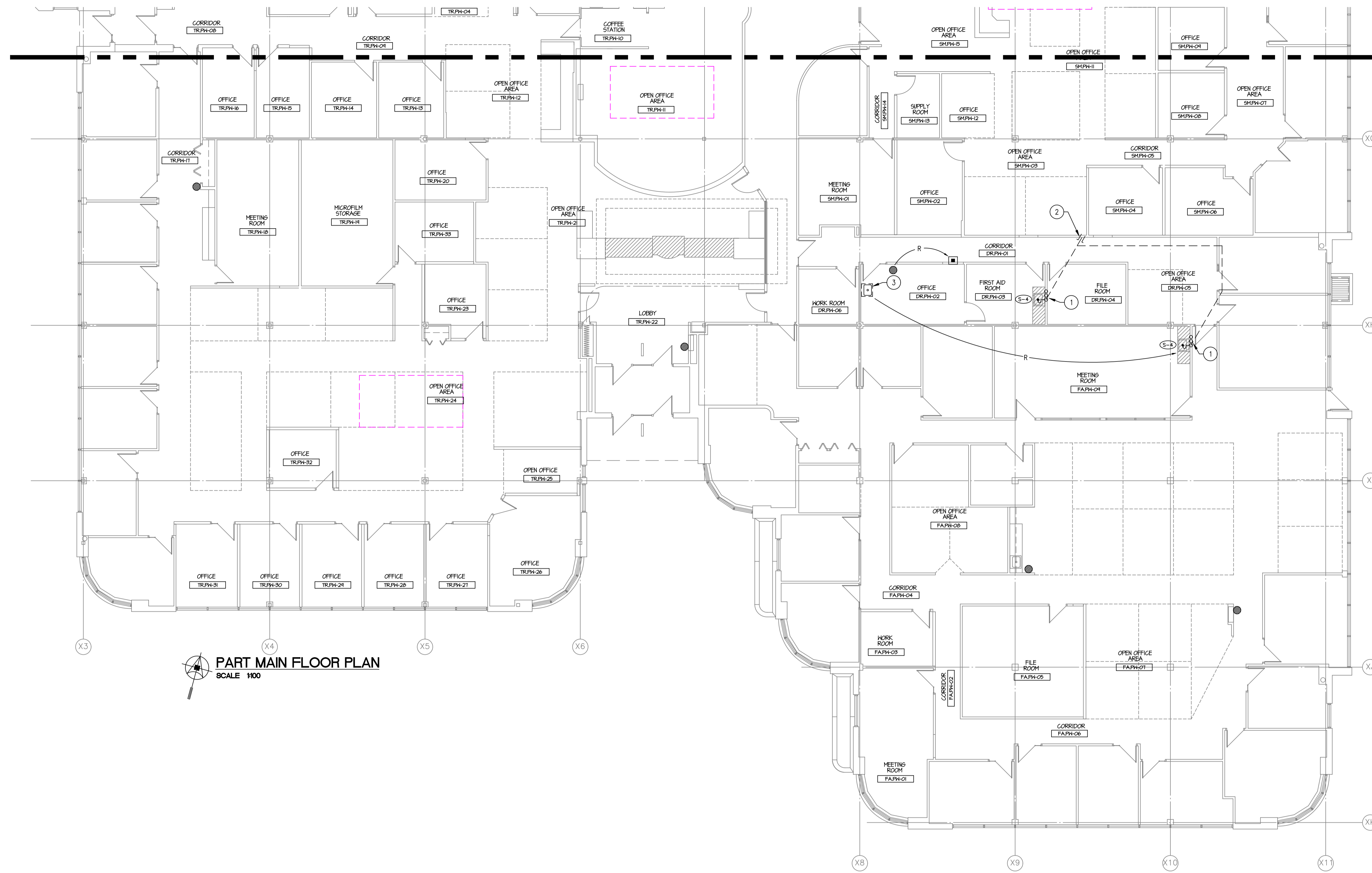

PART MAIN FLOOR PLAN
SCALE: 1/100

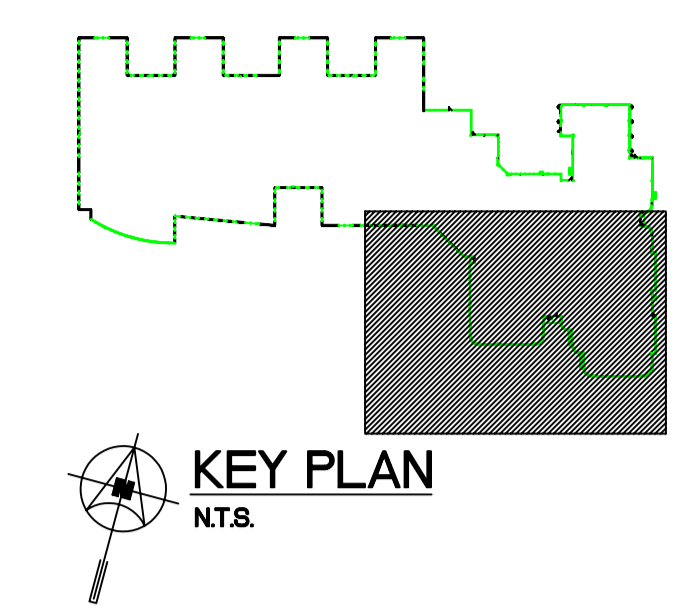

- DRAWING NOTES:**
1. "H" HOT AND COLD WATER UP TO FIXTURE FROM CRAWLSPACE.
 2. VENT UP THRU ROOF.
 3. EXISTING PLUMBING FIXTURE TO BE RELOCATED. CAP PIPING AT MAINS. REMOVE ALL REDUNDANT PIPING (I) IN ALL ASSOCIATED EQUIPMENT IE HANDSIES ETC. REFER TO ARCH FOR NEW LOCATION.

Friesen Tokar Architects
200 - 2033 Portage Avenue
Winnipeg, Canada R2J 0R6
Tel. 204.885.9123
Fax. 204.837.7235

DESIGNER:	KM
DESIGNED BY:	HJM
DATE:	MAY 2004
PROJECT NO.:	01716
FILE PATH:	
REVISIONS:	
1. ISSUED FOR 50% REVIEW	FEBRUARY 6, 2004
2. ISSUED FOR 75% REVIEW	MARCH 5, 2004
3. ISSUED FOR PRETENDER REVIEW	APRIL, 2004
4. ISSUED FOR TENDER	MAY 14, 2004

SMS ENGINEERING
SMS Engineering Ltd. Consulting Engineers
775 Sargent Street Winnipeg MB Canada R2H 0G3
Telephone: 204.775.0101 Fax: 204.775.0103
sms@smseng.com

ORIGINAL CONTRACT DRAWING
ISSUED AND RELEASD BY
V.B. WALKER, P. ENG
MAY 14, 2004

APCM
Certificate of Authorization
SMS Engineering Ltd.
No. 190 Expiry: April 30, 2005

Drawings and specifications, as
instruments of service are the
property of the architect, the
copyright in the same being
reserved to him. No reproduction
may be made without the
permission of the architect and
where made, must bear his name.
All prints to be returned to the
architect.
The contractor shall verify
dimensions and data noted herein
with conditions on the site and is
held responsible for reporting any
discrepancy to the architect for
adjustment.
This drawing shall not be used for
building purposes until
countersigned by:

THE
CITY OF
WINNIPEG

OFFICE ADDITION AND RENOVATION
1155 PACIFIC AVENUE
WINNIPEG, MANITOBA

FRIESEN TOKAR ARCHITECTS

MAIN FLOOR PLAN - PART C
PLUMBING AND FIRE
PROTECTION **M1.6**