

NOTE: CHAINAGES SHOWN ARE ALONG W. R. OF BANNING ST.

BANNING STREET

\* SERVICES TO BE RENEWED TO R. ALL OTHERS TO BE RECONNECTED

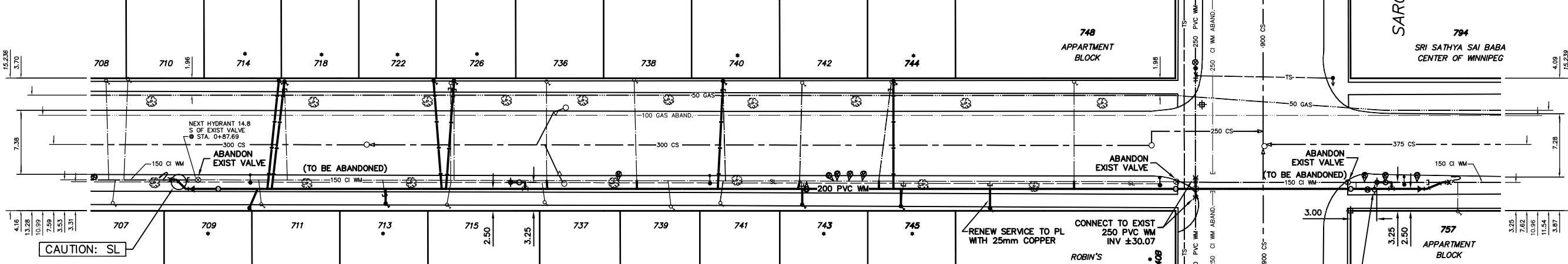

- CONSTRUCTION NOTES
- EXPOSE EXISTING WATERMAIN & CONFIRM INVERTS PRIOR TO CONSTRUCTION.
  - LOCATION OF ALL SERVICES TO BE CONFIRMED IN THE FIELD.
  - INSTALL WATERMAIN BY TRENCHLESS METHODS.
  - TRENCHES AND EXCAVATIONS WITHIN 1 METRE OF A PAVED AREA INCLUDING SIDEWALKS SHALL BE CLASS 3 BACKFILL.
  - ALL MATERIALS SHALL CONFORM TO THE CITY OF WINNIPEG STANDARD CONSTRUCTION SPECIFICATIONS.
  - MINIMUM COVER TO TOP OF WATERMAIN SHALL BE 2.4 m.
  - REPLACE ALL EXISTING LEAD SERVICES FROM PROPOSED WATERMAIN TO R.
  - NOTIFY ALL AFFECTED RESIDENTS AND BUSINESSES 24 HOURS IN ADVANCE OF ANY WATER SHUTDOWNS OR DISRUPTION OF SERVICE.

METRIC  
WHOLE NUMBERS INDICATE MILLIMETRES  
DECIMALIZED NUMBERS INDICATE METRES

WARNING  
IF POWER EQUIPMENT OR EXPLOSIVES ARE TO BE USED FOR EXCAVATION ON THIS PROJECT THE CONTRACTOR MUST:  
1) NOTIFY THE GAS COMPANY OF THE PROPOSED LOCATION OF EXCAVATION.  
2) TAKE PRECAUTION TO AVOID DAMAGE TO GAS COMPANY INSTALLATIONS.  
SEE PROVINCIAL REGULATION 210/72 FOR DETAILS

200 WM	WATERMAIN	200 WM	SL, HYDRO	150 WM	WATERMAIN	150 WM
○	HYDRANT	○	MTS	○	HYDRANT	○
○	VALVE	○	TRAFFIC SIGNALS	○	VALVE	○
525 LDS	LAND DRAINAGE SEWER	525 LDS	GAS	300 LDS	LAND DRAINAGE SEWER	300 LDS
375 WWS	WASTEWATER SEWER	375 WWS	SURVEY BAR	250 WWS	WASTEWATER SEWER	250 WWS
○	MANHOLE	○	FENCE	○	PROFILE	○
□	CATCH BASIN	□	POLE - HYDRO, MTS	○	GROUND ABOVE PIPE	○
▽	CURB INLET	▽	POLE - HYDRO, MTS	○	GROUND ABOVE PIPE	○
△	REDUCER	△	GUY ANCHOR	○	GROUND ABOVE PIPE	○
X	COUPLING	X	LIGHT STANDARD	○	GROUND ABOVE PIPE	○
U	ANODE	U	TREE	○	GROUND ABOVE PIPE	○
EXISTING	LEGEND-PLAN	PROPOSED	LEGEND-PLAN	PROPOSED	EXISTING	LEGEND-PROFILE

LOCATION APPROVED	UNDERGROUND STRUCTURES	DATE
SUPV. U/O STRUCTURES COMMITTEE		
NOTE:	LOCATION OF UNDERGROUND STRUCTURES AS SHOWN ARE BASED ON THE BEST INFORMATION AVAILABLE BUT NO GUARANTEE IS GIVEN THAT ALL EXISTING UTILITIES ARE SHOWN OR THAT THE GIVEN LOCATIONS ARE EXACT. CONFIRMATION OF EXISTENCE AND EXACT LOCATION OF ALL SERVICES MUST BE OBTAINED FROM THE INDIVIDUAL UTILITIES BEFORE PROCEEDING WITH CONSTRUCTION.	

CITY OF WINNIPEG  
WATER AND WASTE  
ENGINEERING DIVISION

DESIGNED BY DS/CJH  
CHECKED BY TW

DRAWN BY RWK/CJH  
APPROVED BY KZ

HOR. SCALE 1:250  
VERTICAL 1:50

DATE 2004 04 07

ENGINEER'S SEAL  
ORIGINAL SIGNED BY K.R. ZUREK  
04/04/19

THE CITY OF WINNIPEG  
WATER AND WASTE DEPARTMENT

2004 WATERMAIN RENEWALS

BANNING STREET  
FROM N R SARGENT AVENUE TO  
115 m S OF S R SARGENT AVENUE

SHEET 2 OF 10  
CITY DRAWING NUMBER D-8452