

NOTE: CHAINAGES SHOWN ARE ALONG E. R. OF ASHBURN ST.

FOR SERVICE INFORMATION  
SEE DRAWING D-8489

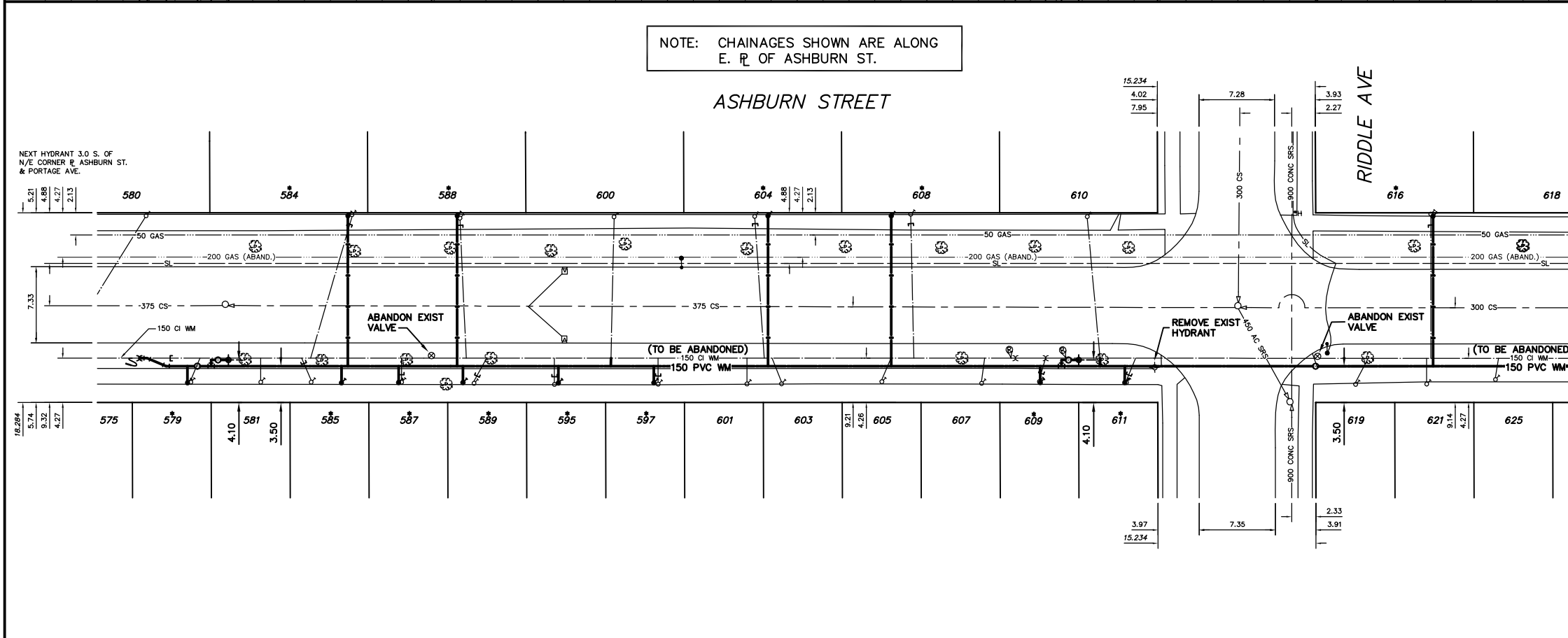

- CONSTRUCTION NOTES**
1. EXPOSE EXISTING WATERMAIN & CONFIRM INVERTS PRIOR TO CONSTRUCTION.
  2. LOCATION OF ALL SERVICES TO BE CONFIRMED IN THE FIELD.
  3. INSTALL WATERMAIN BY TRENCHLESS METHODS.
  4. TRENCHES AND EXCAVATIONS WITHIN 1 METRE OF A PAVED AREA INCLUDING SIDEWALKS SHALL BE CLASS 3 BACKFILL.
  5. ALL MATERIALS SHALL CONFORM TO THE CITY OF WINNIPEG STANDARD CONSTRUCTION SPECIFICATIONS.
  6. MINIMUM COVER TO TOP OF WATERMAIN SHALL BE 2.4 m.
  7. REPLACE ALL EXISTING LEAD SERVICES FROM PROPOSED WATERMAIN TO R.
  8. NOTIFY ALL AFFECTED RESIDENTS AND BUSINESSES 24 HOURS IN ADVANCE OF ANY WATER SHUTDOWNS OR DISRUPTION OF SERVICE.

**METRIC**  
WHOLE NUMBERS INDICATE MILLIMETRES  
DECIMALIZED NUMBERS INDICATE METRES

NOTE: ALL VALVES TO BE INSTALLED COUNTERCLOCKWISE TO CLOSE

**WARNING**  
IF POWER EQUIPMENT OR EXPLOSIVES ARE TO BE USED FOR EXCAVATION ON THIS PROJECT THE CONTRACTOR MUST:  
1) NOTIFY THE GAS COMPANY OF THE PROPOSED LOCATION OF EXCAVATION.  
2) TAKE PRECAUTION TO AVOID DAMAGE TO GAS COMPANY INSTALLATIONS.  
SEE PROVINCIAL REGULATION 210/72 FOR DETAILS

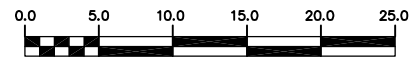

EXISTING	LEGEND-PLAN	PROPOSED	EXISTING	LEGEND-PLAN	PROPOSED	EXISTING	LEGEND-PROFILE	PROPOSED
200 WM	WATERMAIN	200 WM	SL, HYDRO	SL, HYDRO	150 WM	WATERMAIN	150 WM	
Hydrant symbol	HYDRANT	Hydrant symbol	MTS	MTS	Hydrant symbol	HYDRANT	Hydrant symbol	
Valve symbol	VALVE	Valve symbol	TRAFFIC SIGNALS	TRAFFIC SIGNALS	Valve symbol	VALVE	Valve symbol	
525 LDS	LAND DRAINAGE SEWER	525 LDS	50 GAS	GAS	50 GAS	LAND DRAINAGE SEWER	300 LDS	
375 WWS	WASTEWATER SEWER	375 WWS	250 WWS	WASTEWATER SEWER	250 WWS	WASTEWATER SEWER	250 WWS	
Manhole symbol	MANHOLE	Manhole symbol	FENCE	FENCE	Profile symbol	PROFILE	Profile symbol	
Catch basin symbol	CATCH BASIN	Catch basin symbol	POLE - HYDRO, MTS	POLE - HYDRO, MTS	Ground above pipe symbol	GROUND ABOVE PIPE	Ground above pipe symbol	
Curb inlet symbol	CURB INLET	Curb inlet symbol	CURB STOP	CURB STOP				
Reducer symbol	REDUCER	Reducer symbol	GUY ANCHOR	GUY ANCHOR				
Coupling symbol	COUPLING	Coupling symbol	LIGHT STANDARD	LIGHT STANDARD				
Anode symbol	ANODE	Anode symbol	TREE	TREE				

LOCATION APPROVED UNDERGROUND STRUCTURES	SUPV. U/G STRUCTURES COMMITTEE	DATE
NOTE: LOCATION OF UNDERGROUND STRUCTURES AS SHOWN ARE BASED ON THE BEST INFORMATION AVAILABLE BUT NO GUARANTEE IS GIVEN THAT ALL EXISTING UTILITIES ARE SHOWN OR THAT THE GIVEN LOCATIONS ARE EXACT. CONFIRMATION OF EXISTENCE AND EXACT LOCATION OF ALL SERVICES MUST BE OBTAINED FROM THE INDIVIDUAL UTILITIES BEFORE PROCEEDING WITH CONSTRUCTION.		
B.M. ELEV.	FIELD BOOK #	
POSTED TO LBS		
NO.	REVISIONS	DATE BY

<b>CITY OF WINNIPEG</b> WATER AND WASTE ENGINEERING DIVISION		ENGINEER'S SEAL
DESIGNED BY DS/CJH	CHECKED BY TW	ORIGINAL SIGNED BY K.R. ZUREK 04/05/19
DRAWN BY CJH	APPROVED BY KZ	
HOR. SCALE 1:250	RELEASED FOR CONSTRUCTION	BID OPPORTUNITY: 152-2004 FILENAME: D-8488_D-8489.rwg PLOT DATE: 2004 05 19
VERTICAL 1:50	DATE 2004 05 19	

**THE CITY OF WINNIPEG**  
WATER AND WASTE DEPARTMENT

2004 WATERMAIN RENEWALS

**ASHBURN STREET**  
100 m S OF RIDDLE AVENUE TO  
25 m N OF RIDDLE AVENUE

SHEET 1 OF 13  
CITY DRAWING NUMBER  
**D-8488**