

**WATER SERVICE INFORMATION**

ADDRESS	SIZE(mm) & TYPE (STREET)	SIZE(mm) & TYPE (PROP)	SHORT & LONG MEASUREMENT	CORP. LOCATION	REMARKS
6727 BETSWORTH AVE	19 COPPER	19 COPPER	3.96 E OF WHL	0.6 W OF S/C	-
6731 BETSWORTH AVE	19 COPPER	19 COPPER	93.27 EEL EVENWOOD	-	-
6733 BETSWORTH AVE	19 COPPER	19 COPPER	1.22 E OF EHL	-	-
6737 BETSWORTH AVE	19 COPPER	19 COPPER	84.12 EEL EVENWOOD	-	-
6739 BETSWORTH AVE	19 COPPER	19 COPPER	0.8 WML HSE	OPP S/C	CORP. REPAIR DEC/94
6742 BETSWORTH AVE	19 COPPER	19 COPPER	67.8 EEL EVENWOOD	-	-
6743 BETSWORTH AVE	19 COPPER	19 COPPER	57.0 EEL EVENWOOD	-	-
6744 BETSWORTH AVE	19 COPPER	19 COPPER	1.52 WML HSE	-	-
6745 BETSWORTH AVE	19 COPPER	19 COPPER	46.63 EEL EVENWOOD	-	S/C REPAIR DEC/98
6748 BETSWORTH AVE	19 COPPER	19 COPPER	0.3 WML HSE	-	-
6749 BETSWORTH AVE	19 COPPER	19 COPPER	41.9 EEL EVENWOOD	-	-
6750 BETSWORTH AVE	19 COPPER	19 COPPER	4.72 WEL HSE	-	-
6751 BETSWORTH AVE	19 COPPER	19 COPPER	35.7 EEL EVENWOOD	-	-
6755 BETSWORTH AVE	19 COPPER	19 COPPER	4.27 EWL HSE	0.3 E OF S/C	CORP. REPAIR AUG/98
6757 BETSWORTH AVE	19 COPPER	19 COPPER	35.8 EEL EVENWOOD	-	-
6763 BETSWORTH AVE	19 COPPER	19 COPPER	3.05 EWL HSE	-	-
6767 BETSWORTH AVE	19 COPPER	19 COPPER	28.65 EEL EVENWOOD	-	-
6769 BETSWORTH AVE	19 COPPER	19 COPPER	4.27 WEL HSE	-	-
6773 BETSWORTH AVE	19 COPPER	19 COPPER	19.66 EEL EVENWOOD	-	-
6775 BETSWORTH AVE	19 COPPER	19 COPPER	8.25 WEL HSE	-	-
6777 BETSWORTH AVE	19 COPPER	19 COPPER	11.8 EEL EVENWOOD	-	-
6779 BETSWORTH AVE	19 COPPER	19 COPPER	6.7 EWL HSE	0.3 W OF S/C	SERV. REPAIR JUL/88
6781 BETSWORTH AVE	19 COPPER	19 COPPER	18.78 EEL EVENWOOD	-	-
6783 BETSWORTH AVE	19 COPPER	19 COPPER	1.52 EWL HSE	1.2 W OF WHL	CORP. REPAIR APR/03
6785 BETSWORTH AVE	19 COPPER	19 COPPER	9.14 OFF BLDG	-	-
6787 BETSWORTH AVE	19 COPPER	19 COPPER	0.8 WEL HSE	-	-
6789 BETSWORTH AVE	19 COPPER	19 COPPER	12.0 EWL EVENWOOD	-	-
6791 BETSWORTH AVE	19 COPPER	19 COPPER	5.33 EWL HSE	-	-
6793 BETSWORTH AVE	19 COPPER	19 COPPER	3.35 EWL EVENWOOD	-	-
6795 BETSWORTH AVE	19 COPPER	19 COPPER	2.43 EEL HSE	-	-
6797 BETSWORTH AVE	19 COPPER	19 COPPER	8.84 WML EVENWOOD	-	-
6799 BETSWORTH AVE	19 COPPER	19 COPPER	8.23 W OF WHL	-	SEPT/02-VACTORED SERV. BOX
6801 BETSWORTH AVE	19 COPPER	19 COPPER	7.01 OFF HSE	-	-
6803 BETSWORTH AVE	19 COPPER	19 COPPER	5.18 W OF EHL	-	-
6805 BETSWORTH AVE	19 COPPER	19 COPPER	34.0 EEL DALE	-	-
6807 BETSWORTH AVE	19 COPPER	19 COPPER	0.46 E OF WHL	-	-
6809 BETSWORTH AVE	19 COPPER	19 COPPER	25.15 EEL DALE	-	-
6811 BETSWORTH AVE	19 COPPER	19 COPPER	1.98 W OF EHL	-	-
6813 BETSWORTH AVE	19 COPPER	19 COPPER	14.2 EEL DALE	-	-
6815 BETSWORTH AVE	19 COPPER	19 COPPER	5.2 E OF WHL	-	-
6817 BETSWORTH AVE	19 COPPER	19 COPPER	9.0 EEL DALE	-	-
6819 BETSWORTH AVE	19 COPPER	19 COPPER	2.0 S OF WHL	-	SERV. OFF EVENWOOD CR
6821 BETSWORTH AVE	19 COPPER	19 COPPER	8.78 OFF HSE	-	-
6823 BETSWORTH AVE	19 COPPER	19 COPPER	4.27 S OF NHL	-	SERV. OFF DALE BLVD
6825 BETSWORTH AVE	19 COPPER	19 COPPER	11.12 OFF HSE	-	-

\* SERVICES TO BE RENEWED TO R ALL OTHERS TO BE RECONNECTED

NOTE: CHAINAGES SHOWN ARE ALONG S. R. OF BETSWORTH AVE UP TO P.I. STA 1+56.145

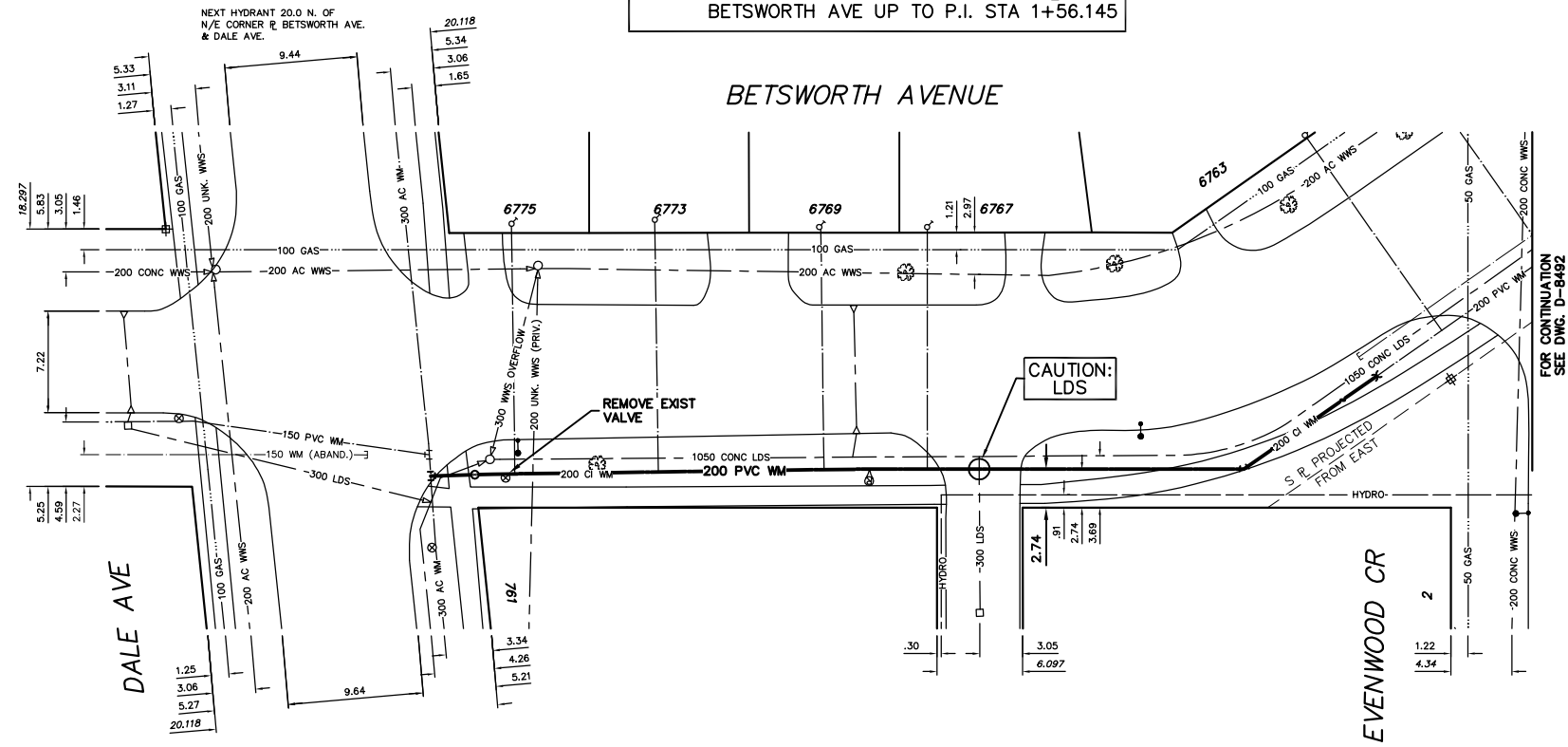

**CONSTRUCTION NOTES**

1. EXPOSE EXISTING WATERMAIN & CONFIRM INVERTS PRIOR TO CONSTRUCTION.
2. LOCATION OF ALL SERVICES TO BE CONFIRMED IN THE FIELD.
3. INSTALL WATERMAIN BY TRENCHLESS METHODS.
4. TRENCHES AND EXCAVATIONS WITHIN 1 METRE OF A PAVED AREA INCLUDING SIDEWALKS SHALL BE CLASS 3 BACKFILL.
5. ALL MATERIALS SHALL CONFORM TO THE CITY OF WINNIPEG STANDARD CONSTRUCTION SPECIFICATIONS.
6. MINIMUM COVER TO TOP OF WATERMAIN SHALL BE 2.4 m.
7. REPLACE ALL EXISTING LEAD SERVICES FROM PROPOSED WATERMAIN TO R.
8. NOTIFY ALL AFFECTED RESIDENTS AND BUSINESSES 24 HOURS IN ADVANCE OF ANY WATER SHUTDOWNS OR DISRUPTION OF SERVICE.

**METRIC**

WHOLE NUMBERS INDICATE MILLIMETRES  
DECIMALIZED NUMBERS INDICATE METRES

NOTE: ALL VALVES TO BE INSTALLED COUNTERCLOCKWISE TO CLOSE

**WARNING**

IF POWER EQUIPMENT OR EXPLOSIVES ARE TO BE USED FOR EXCAVATION ON THIS PROJECT THE CONTRACTOR MUST:  
1) NOTIFY THE GAS COMPANY OF THE PROPOSED LOCATION OF EXCAVATION.  
2) TAKE PRECAUTION TO AVOID DAMAGE TO GAS COMPANY INSTALLATIONS.  
SEE PROVINCIAL REGULATION 210/72 FOR DETAILS

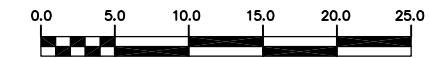

200 WM	WATERMAIN	200 WM	SL, HYDRO	150 WM	WATERMAIN	150 WM
+	HYDRANT	+	MTS	+	HYDRANT	+
o	VALVE	o	TRAFFIC SIGNALS	x	VALVE	x
525 LDS	LAND DRAINAGE SEWER	525 LDS	GAS	50 GAS	LAND DRAINAGE SEWER	300 LDS
375 WWS	WASTEWATER SEWER	375 WWS	SURVEY BAR	250 WWS	WASTEWATER SEWER	250 WWS
o	MANHOLE	o	FENCE	x	PROFILE	
□	CATCH BASIN	□	POLE - HYDRO, MTS	///	GROUND ABOVE PIPE	
▽	CURB INLET	▽	CURB STOP	o		
△	REDUCER	△	GUY ANCHOR	o		
X	COUPLING	X	LIGHT STANDARD			
o	ANODE	o	TREE			
EXISTING	LEGEND-PLAN	PROPOSED	EXISTING	LEGEND-PLAN	PROPOSED	EXISTING

LOCATION APPROVED UNDERGROUND STRUCTURES		B.M. ELEV.	FIELD BOOK #
SUPV. U/G STRUCTURES COMMITTEE	DATE		
NOTE: LOCATION OF UNDERGROUND STRUCTURES AS SHOWN ARE BASED ON THE BEST INFORMATION AVAILABLE BUT NO GUARANTEE IS GIVEN THAT ALL EXISTING UTILITIES ARE SHOWN OR THAT THE GIVEN LOCATIONS ARE EXACT. CONFIRMATION OF EXISTENCE AND EXACT LOCATION OF ALL SERVICES MUST BE OBTAINED FROM THE INDIVIDUAL UTILITIES BEFORE PROCEEDING WITH CONSTRUCTION.			
NO.	REVISIONS	DATE	BY

**CITY OF WINNIPEG**  
WATER AND WASTE  
ENGINEERING DIVISION

DESIGNED BY: DS/CJH  
CHECKED BY: TW

DRAWN BY: CJH  
APPROVED BY: KZ

HOR. SCALE: 1:250  
VERTICAL: 1:50

DATE: 2004 05 19

ENGINEER'S SEAL  
ORIGINAL SIGNED BY K.R. ZUREK  
04/05/19

**THE CITY OF WINNIPEG**  
WATER AND WASTE DEPARTMENT

2004 WATERMAIN RENEWALS

**BETSWORTH AVENUE**  
DALE BOULEVARD TO  
TO EVENWOOD CRESCENT

SHEET 4 OF 13  
CITY DRAWING NUMBER  
D-8491

BID OPPORTUNITY: 152-2004  
FILENAME: D-8491\_L0-8492.dwg  
PLOT DATE: 2004 05 19