

NOTE: CHAINAGES SHOWN ARE ALONG ϕ OF EXISTING 2-600 STEEL PIPES

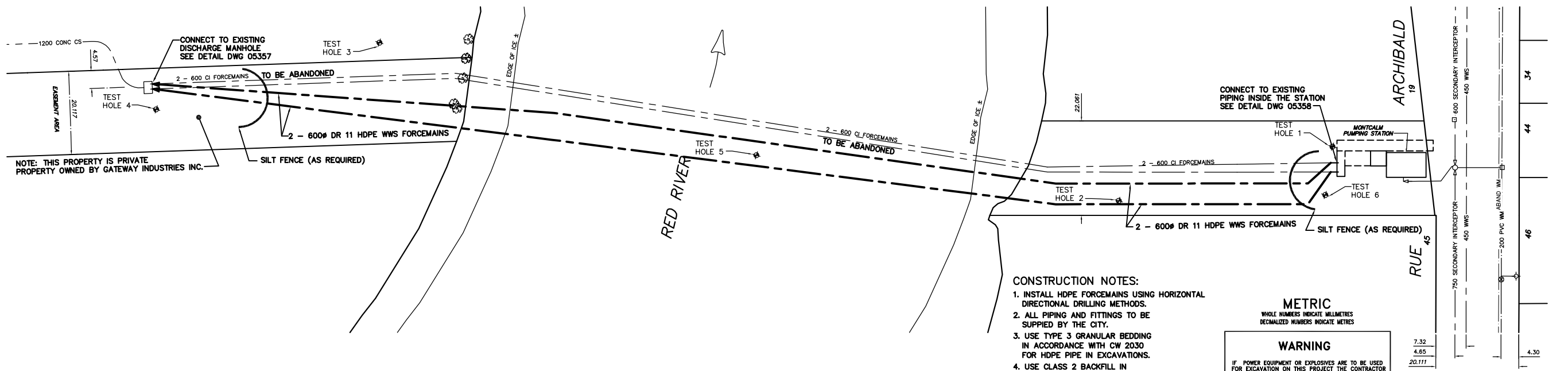

- CONSTRUCTION NOTES:**
1. INSTALL HDPE FORCEMAINS USING HORIZONTAL DIRECTIONAL DRILLING METHODS.
 2. ALL PIPING AND FITTINGS TO BE SUPPLIED BY THE CITY.
 3. USE TYPE 3 GRANULAR BEDDING IN ACCORDANCE WITH CW 2030 FOR HDPE PIPE IN EXCAVATIONS.
 4. USE CLASS 2 BACKFILL IN ACCORDANCE WITH CW 2030 IN EXCAVATIONS.

METRIC
WHOLE NUMBERS INDICATE MILLIMETRES
DECIMALIZED NUMBERS INDICATE METRES

WARNING
IF POWER EQUIPMENT OR EMPLOYEES ARE TO BE USED FOR EXCAVATION ON THIS PROJECT THE CONTRACTOR

- 1) NOTIFY THE GAS COMPANY OF THE PROPOSED LOCATION OF EXCAVATION.
- 2) TAKE PRECAUTION TO AVOID DAMAGE TO GAS COMPANY INSTALLATIONS.

SEE PROVINCIAL REGULATION 210/72 FOR DETAILS

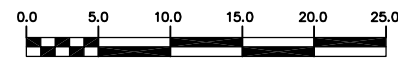

200 WM	WATERMAIN	200 WM	SL, HYDRO	150 WM	WATERMAIN	150 WM
HYDRANT	HYDRANT	MTS	TRAFFIC SIGNALS	50 GAS	LAND DRAINAGE SEWER	300 LDS
VALVE	525 LDS	50 GAS	GAS	300 LDS	WASTEWATER SEWER	300 LDS
LAND DRAINAGE SEWER	375 WWS	WASTEWATER SEWER	SURVEY BAR	250 WWS	WASTEWATER SEWER	250 WWS
MANHOLE	CATCH BASIN	CURB INLET	JUNCTIONS	CULVERT	ANODE	LEGEND-PLAN
PROPOSED	EXISTING	LEGEND-PLAN	PROPOSED	EXISTING	LEGEND-PROFILE	PROPOSED

LOCATION APPROVED UNDERGROUND STRUCTURES

SUPV. U/G STRUCTURES COMMITTEE DATE

NOTE:
LOCATION OF UNDERGROUND STRUCTURES AS SHOWN ARE BASED ON THE BEST INFORMATION AVAILABLE BUT NO GUARANTEE IS GIVEN THAT ALL EXISTING UTILITIES ARE SHOWN OR THAT THE GIVEN LOCATIONS ARE EXACT. CONFIRMATION OF EXISTENCE AND EXACT LOCATION OF ALL SERVICES MUST BE OBTAINED FROM THE INDIVIDUAL UTILITIES BEFORE PROCEEDING WITH CONSTRUCTION.

B.M. ELEV.	FIELD BOOK #
POSTED TO LBIS	
DESIGNED BY	CHECKED BY
JE	JE
DRAWN BY	APPROVED BY
WKT	KZ
HOR. SCALE	1:500
VERTICAL	1:500
DATE	2004 01 15

CITY OF WINNIPEG WATER AND WASTE ENGINEERING DIVISION

DESIGNED BY: JE
CHECKED BY: JE
DRAWN BY: WKT
APPROVED BY: KZ
HOR. SCALE: 1:500
VERTICAL: 1:500
DATE: 2004 01 15

ENGINEER'S SEAL

ORIGINAL SIGNED BY K.R. ZUREK
04/01/23

TENDER No. 16-2004
FILENAME: 05356.DWG
PLOT DATE: 2004 01 23

THE CITY OF WINNIPEG WATER AND WASTE DEPARTMENT

Winnipeg

MONTCALM SEWAGE PUMPING STATION

FORCEMAIN REPLACEMENT

SHEET 1 OF 4
CITY DRAWING NUMBER 05356