

NOTE: CHAINAGES SHOWN ARE ALONG  $\phi$  OF EXISTING 2-600 STEEL PIPES

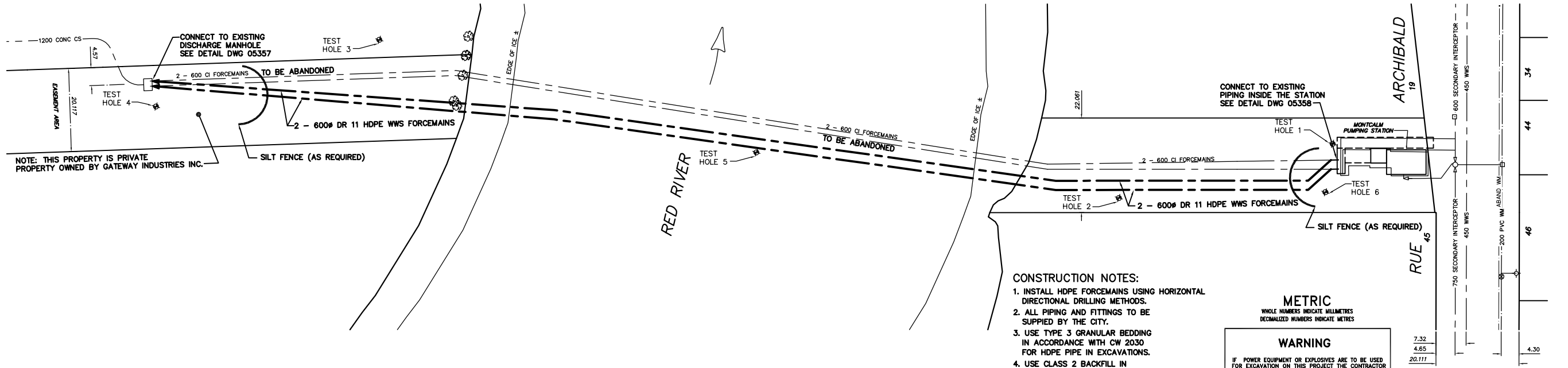

- CONSTRUCTION NOTES:**
1. INSTALL HDPE FORCEMAINS USING HORIZONTAL DIRECTIONAL DRILLING METHODS.
  2. ALL PIPING AND FITTINGS TO BE SUPPLIED BY THE CITY.
  3. USE TYPE 3 GRANULAR BEDDING IN ACCORDANCE WITH CW 2030 FOR HDPE PIPE IN EXCAVATIONS.
  4. USE CLASS 2 BACKFILL IN ACCORDANCE WITH CW 2030 IN EXCAVATIONS.

**METRIC**  
WHOLE NUMBERS INDICATE MILLIMETRES  
DECIMALIZED NUMBERS INDICATE METRES

**WARNING**  
IF POWER EQUIPMENT OR EMPLOYEES ARE TO BE USED FOR EXCAVATION ON THIS PROJECT THE CONTRACTOR  
1) NOTIFY THE GAS COMPANY OF THE PROPOSED LOCATION OF EXCAVATION.  
2) TAKE PRECAUTION TO AVOID DAMAGE TO GAS COMPANY INSTALLATIONS.  
SEE PROVINCIAL REGULATION 210/72 FOR DETAILS

200 WM	WATERMAIN	200 WM	SL, HYDRO	150 WM	WATERMAIN	150 WM
HYDRANT	HYDRANT	MTS	TRAFFIC SIGNALS	50 GAS	LAND DRAINAGE SEWER	300 LDS
VALVE	VALVE	GAS	SURVEY BAR	250 WWS	WASTEWATER SEWER	250 WWS
525 LDS	LAND DRAINAGE SEWER	525 LDS	50 GAS	300 LDS	LAND DRAINAGE SEWER	300 LDS
375 WWS	WASTEWATER SEWER	375 WWS	FENCE	POLE - HYDRO, MTS	CURB STOP	GUY ANCHOR
MANHOLE	MANHOLE	POLE - HYDRO, MTS	CURB STOP	GUY ANCHOR	LIGHT STANDARD	TREE
CATCH BASIN	CATCH BASIN	LEGEND-PLAN	PROPOSED	EXISTING	LEGEND-PROFILE	PROPOSED
CURB INLET	CURB INLET	LEGEND-PLAN	PROPOSED	EXISTING	LEGEND-PROFILE	PROPOSED
JUNCTIONS	JUNCTIONS	LEGEND-PLAN	PROPOSED	EXISTING	LEGEND-PROFILE	PROPOSED
CULVERT	CULVERT	LEGEND-PLAN	PROPOSED	EXISTING	LEGEND-PROFILE	PROPOSED
ANODE	ANODE	LEGEND-PLAN	PROPOSED	EXISTING	LEGEND-PROFILE	PROPOSED
EXISTING	LEGEND-PLAN	PROPOSED	EXISTING	LEGEND-PROFILE	PROPOSED	EXISTING

**LOCATION APPROVED UNDERGROUND STRUCTURES**

SUPV. U/G STRUCTURES COMMITTEE DATE

NOTE:  
LOCATION OF UNDERGROUND STRUCTURES AS SHOWN ARE BASED ON THE BEST INFORMATION AVAILABLE BUT NO GUARANTEE IS GIVEN THAT ALL EXISTING UTILITIES ARE SHOWN OR THAT THE GIVEN LOCATIONS ARE EXACT. CONFIRMATION OF EXISTENCE AND EXACT LOCATION OF ALL SERVICES MUST BE OBTAINED FROM THE INDIVIDUAL UTILITIES BEFORE PROCEEDING WITH CONSTRUCTION.

B.M. ELEV.	FIELD BOOK #
POSTED TO LBIS	
NO.	REVISIONS
DATE	BY

**CITY OF WINNIPEG WATER AND WASTE ENGINEERING DIVISION**

DESIGNED BY: JE  
CHECKED BY: JE

DRAWN BY: WKT  
APPROVED BY: KZ

HOR. SCALE: 1:500  
VERTICAL: 1:500

DATE: 2004 01 15

ENGINEER'S SEAL

ORIGINAL SIGNED BY K.R. ZUREK 04/01/15

TENDER No. 16-2004  
FILENAME: 05356.DWG  
PLOT DATE: 2004 01 15

**THE CITY OF WINNIPEG WATER AND WASTE DEPARTMENT**

Montcalm Sewage Pumping Station

**FORCEMAIN REPLACEMENT**

SHEET 1 OF 4  
CITY DRAWING NUMBER 05356