

SEWER SERVICE INFORMATION (ID #18843) \*

DISTANCE FROM 1ST MH W. OF NASSAU ST. S. (MH ID #18842)	DESCRIPTION
13.6 W	SERVICE CONNECTION N
15.7 W	SERVICE CONNECTION N
16.5 W	SERVICE CONNECTION N
23.5 W	SERVICE CONNECTION N
24.5 W	SERVICE CONNECTION N
28.7 W	SERVICE CONNECTION S
30.5 S	SERVICE CONNECTION S
31.2 W	SERVICE CONNECTION N
41.6 W	SERVICE CONNECTION S (12 O'CLOCK)
43.0 W	SERVICE CONNECTION N
46.1 W	SERVICE CONNECTION N
46.9 W	SERVICE CONNECTION N
61.7 W	SERVICE CONNECTION N
74.6 W	SERVICE CONNECTION N
79.3 W	SERVICE CONNECTION N

\* INFORMATION FROM SEWER VIDEO INSPECTION

NOTE: CHANGE ALONG SOUTH PROPERTY LINE MONTAGUE AVENUE. STATION 10+00.00 IS W. PL. NASSAU STREET S.

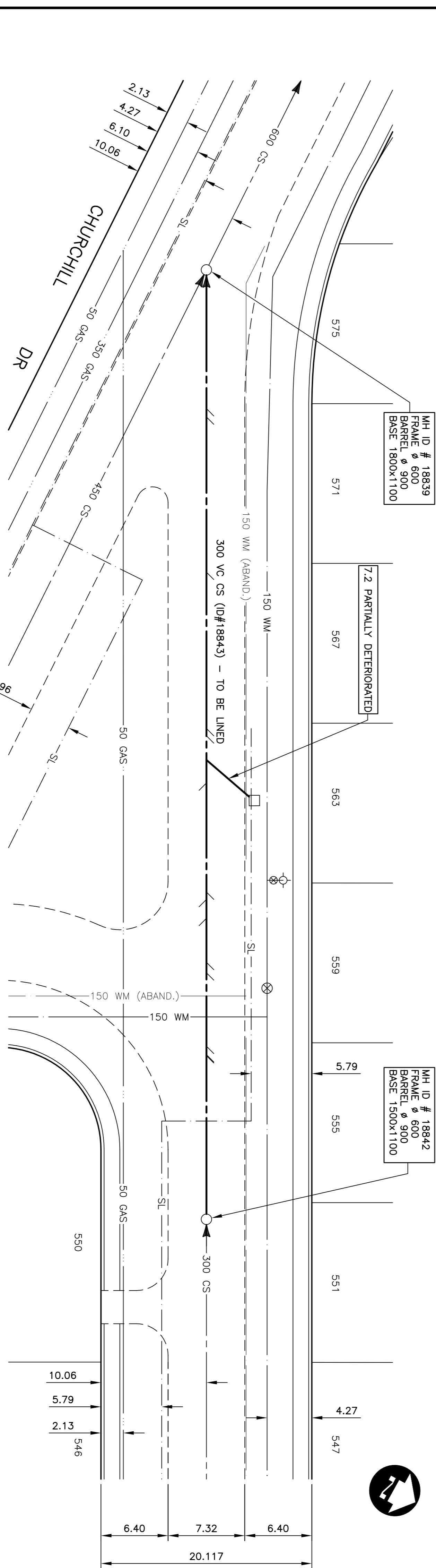

**WARNING**

- IF POWER EQUIPMENT OR EXPLOSIVES ARE TO BE USED FOR EXCAVATION ON THIS PROJECT THE CONTRACTOR MUST:
1. NOTIFY THE GAS COMPANY OF THE PROPOSED LOCATION OF EXCAVATION.
2. TAKE PRECAUTION TO AVOID DAMAGE TO GAS COMPANY INSTALLATIONS SEE PROVINCIAL REGULATION 210/72 FOR DETAILS

**METRIC**  
WHOLE NUMBERS INDICATE MILLIMETRES  
DECIMALIZED NUMBERS INDICATE METRES

EXISTING	LEGEND-PLAN	PROPOSED	EXISTING	LEGEND-PLAN	PROPOSED	EXISTING	LEGEND-PROFILE	PROPOSED
150 mm W.M.	WATERMAIN	150 mm W.M.	150 mm W.M.	WATERMAIN	150 mm W.M.			
300 mm L.O.S.	HYDRANT VALVE	300 mm L.O.S.	300 mm L.O.S.	HYDRANT VALVE	300 mm L.O.S.			
250 mm W.M.S.	LAND DRAINAGE SEWER	250 mm W.M.S.	250 mm W.M.S.	LAND DRAINAGE SEWER	250 mm W.M.S.			
	WASTE WATER SEWER			WASTE WATER SEWER				
	MANHOLE			PROPERTY LINE				
	CATCH BASIN			SURVEY BAR				
	CURB INLET			SERVICE VALVE				
	JUNCTIONS			I.P.S.				
	CULVERT			BUILDING				
	GAS							

**UNDERGROUND STRUCTURES**

NO.	REVISIONS	DATE	BY
1	SUBMITTED TO WAW FOR REVIEW	06/10/04	P.M.K.
2	ISSUED FOR TENDER	06/28/04	P.M.K.

**DESIGNED** J.K.M.  
**DRAWN** S.C.C.  
**CHECKED** P.M.K.  
**APPROVED**

**DATE** APRIL 2004

**DILLON CONSULTING**

RELEASED FOR ORIGINAL SIGNATURE BY GAS ZUREK DATE MAY 28, 2004

ENGINEER'S SEAL  
PROVINCE OF MANITOBA  
REGISTERED PROFESSIONAL ENGINEER  
KREITZ  
05/28/04

**THE CITY OF WINNIPEG WATER AND WASTE DEPARTMENT**

2004 COMBINED SEWER RENEWALS BY CIPP LINING, CONTRACT 9  
**MONTAGUE AVENUE**  
1ST MH WEST OF NASSAU ST. S. TO MH AT CHURCHILL DR

CITY DRAWING NUMBER 05404  
SHEET 6 OF 15  
BID OPPORTUNITY NO. 238-2004